

NAVARRO COUNTY COMMISSIONER'S COURT

A Special meeting of the Navarro County Commissioner's Court was held on Monday, the 8th day of August, 2016 at 10:00 a.m., in the Courtroom of the Navarro County Annex, 601 North 13th Street, in Corsicana, Texas. Presiding Judge HM Davenport, Jr. Commissioners present Jason Grant, Dick Martin, and David Warren.

1. 10:04 A.M. Motion to convene by Comm. Grant sec by Comm. Warren
Carried unanimously
2. Opening prayer by Commissioner Martin
3. Pledge of Allegiance
4. Public Comments-Liz Smith-TJJD Property **PG 3608**

Consent Items

Motion to approve consent item 5-6 by Comm. Martin sec by Comm. Grant
Carried unanimously

5. Motion to approve and pay bills as submitted by the County Auditor, including payroll (paid 07/29/16) **TO WIT PG 3609-3626**
6. Motion to approve budget transfers due to the creation of new line items, creation of new funds, FEMA expenditures and other expenditures **TO WIT PG 3627-3633**

Action Items

7. Motion to re-enact Burn Ban (burn ban on) by Comm. Grant sec by Comm. Martin
Carried unanimously
8. Motion to approve ordering the November 8, 2016 General Election by Comm. Martin sec by Comm. Warren **TO WIT PG 3634**
Carried unanimously
9. Motion to approve 2016 Certified Appraisal Roll and the Anticipated Collection rate, as required by Section 26.04 of the Texas Property Tax Code Gail Smith by Comm. Warren sec by Comm. Grant **TO WIT PG 3635-3637**
Carried unanimously

10. Motion to approve County Auditor's April 2016 monthly financial report pursuant to LGC Sec 114.024 by Comm. Martin sec by Grant
Carried unanimously **TO WIT PG 3638-3641**
11. Motion to approve purchase of road material and hauling for Pct. 3 pursuant to LGC Sec 130.908 (expenditure exceeds 1/12 of line item budget) by Comm. Warren sec by Comm. Martin
Carried unanimously
12. Motion to approve and declare as salvage unused and damaged furniture at Ideal Storage by Comm. Grant sec by Comm. Martin
Carried unanimously **TO WIT PG 3642**
13. Motion to approve Change Order Proposal #072 from Phoenix 1 Restoration By Comm. Martin sec by Comm. Grant
Carried unanimously **TO WIT PG 3643**
14. Motion to approve Change Order Proposal #073 from Phoenix 1 Restoration by Comm. Grant sec by Comm. Warren
Carried unanimously **TO WIT PG 3644-3646**
15. Motion to approve Change Order Proposal # 074 from Phoenix 1 by Comm. Grant sec by Comm. Martin
Carried unanimously **TO WIT PG 3647-3648**
16. Motion to approve Change Order Proposal # 075 from Phoenix 1 by Comm. Martin sec by Comm. Warren
Carried unanimously **TO WIT PG 3649**
17. Motion to approve Change Order Proposal #076 from Phoenix 1 Restoration by Comm. Warren sec by Comm. Martin
Carried unanimously **TO WIT PG 3650-3652**
18. No action taken to approve Change Order Proposal # 077 from Phoenix 1 Restoration
19. Motion to approve Change Order Proposal # 078 from Phoenix 1 Restoration by Comm. Martin sec by Comm. Grant
Carried unanimously **TO WIT PG 3653-3654**
20. Motion to approve Change Order Proposal #079 from Phoenix 1 Restoration by Comm. Grant sec by Comm. Martin
Carried unanimously **TO WIT PG 3655**

21. No action taken to approve Change Order Proposal # 080 from Phoenix 1
22. Motion to go into Executive Session Pursuant to the Texas Government Code Section 551.074 to discuss Personnel by Comm. Grant sec by Martin
Carried unanimously

Motion to come out of Executive Sessions by Comm. Warren sec by Comm. Martin
Carried unanimously
23. No action taken on Executive Session Pursuant to the Texas Government Code Section 551.074 to discuss Personnel
24. Motion to go into Executive Session Pursuant to the Texas Government Code Section 551.076 to discuss Security Devices or Security Audit by Comm. Grant sec by Comm. Martin
Carried unanimously
25. No action taken on Executive Session Pursuant to the Texas Government Code 551.076 to discuss Security Devices or Security Audit
26. Budget Workshop-Motion to break until 1:30 today by Comm. Martin sec by Comm. Grant
Carried unanimously
1:31 P.M. Motion to come out of break by Comm. Warren sec by Comm. Martin
Carried unanimously
Presenting budgets: Lowell Thompson-District Attorney
James Lagomarsino-District Judge
Danda Parker-Election Administrator
27. Motion to recess until Tuesday 9:00 A.M. August 9, 2016 to continue Budget Workshop by Comm. Martin sec by Comm. Grant
Carried unanimously

9:05 Motion to come out of recess by Comm. Warren sec by Comm. Martin
Carried unanimously

Presenting budget: Tommy Pryor-IT
Ryan Douglas-Treasurer
Eric Myers-Emergency Management
Connie Hickman-JP 4
Vicky Gray-JP 1
Jackie Freeland-JP 3
Darrell Waller-JP 2

Motion to break till 1:30 p.m. by Comm. Martin sec by Comm. Grant
Carried unanimously

1:30 p.m. Motion to come out of break by Comm. Martin sec by Comm. Warren
Carried unanimously

Cont. Presenting budget: Page Bishop-Extension
Melanie Hyder-Juvenile Probation
Chris Aldama-Adult Probation
Frank Howell-Crime Stoppers

28. Motion to adjourn by Comm. Martin sec by Comm. Warren
Carried unanimously

I, Sherry Dowd, Navarro County Clerk, Attest that the Foregoing is a True and accurate accounting of the commissioners Court's authorized proceeding for August 8th, 2016.

Signed 8th day of August, 2016

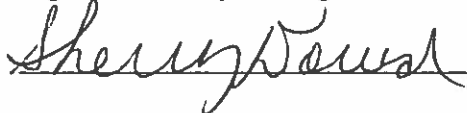

Sherry Dowd, County Clerk



#4

3608

NAVARRO COUNTY COMMISSIONERS COURT

PUBLIC COMMENTS PARTICIPATION FORM

PRINT NAME AND SUBJECT

Date 8-8-16

NAME	SUBJECT
1. <u>Ag Smith</u>	<u>TJTD Property</u>
2. _____	_____
3. _____	_____
4. _____	_____
5. _____	_____
6. _____	_____
7. _____	_____
8. _____	_____
9. _____	_____
10. _____	_____
11. _____	_____
12. _____	_____

ALL RECORDS FROM 08/08/2016 TO 08/08/2016 DATE-TO-BE-PAID

VENDOR NAME	ACCOUNT #	ACCOUNT NAME	ITEM/REASON	INVOICE #	VP DATE	DATE TBP	PO NO	AMOUNT
ABC FERTILIZER & SUPPLY	2016 101-512-385	COUNTY FARM	10 GAL GLYPHOSPHATE	25111	08/01/2016	08/08/2016	301962	180.00
ABC FERTILIZER & SUPPLY	2016 101-566-424	WEIGHTS	WEIGHING	25071	08/05/2016	08/08/2016		84.00
ABC FERTILIZER & SUPPLY	2016 101-566-424	WEIGHTS	WEIGHING	25145	08/05/2016	08/08/2016		84.00
ALTMAN PSYCHOLOGICAL SE	2016 101-435-470	MEDICAL EXAMINAT	JENNINGS, BENNIE RA	CD-128-16	07/29/2016	08/08/2016		2,572.50
AMERICAN FORENSICS LLC	2016 101-406-487	AUTOPSY	JACKSON, RONNIE	2067	07/29/2016	08/08/2016		1,700.00
AMERICAN TIRE DISTRIBUT	2016 101-560-325	TIRES	UNIT 2585 - P255/70	5077928525	08/01/2016	08/08/2016	301993	455.84
AT&T SERVICES INC.	2016 101-410-435	TELEPHONE	9038751617 07/21/16	1617 - JUL 2	08/03/2016	08/08/2016		3,489.36
AT&T SERVICES INC.	2016 101-410-436	INTERNET	125499768 07/23/16	9768 - JUL 2	08/03/2016	08/08/2016		65.21
AT&T SERVICES INC.	2016 101-560-436	INTERNET	125499763 07/23/16	9763 - JUL 2	08/03/2016	08/08/2016		50.13
AT&T SERVICES INC.	2016 101-131-232	DUE FROM JUSTICE	287236363034 06/20/	3034 - JUL 2	08/03/2016	08/08/2016		281.19
AT&T SERVICES INC.	2016 101-410-435	TELEPHONE	287236363034 06/20/	3034 - JUL 2	08/03/2016	08/08/2016		659.17
AT&T SERVICES INC.	2016 101-410-435	TELEPHONE	9038753391 07/21/16	3391 - JUL 2	08/03/2016	08/08/2016		630.65
AT&T SERVICES INC.	2016 101-410-435	TELEPHONE	1717995787 05/18/16	5787 - MAY 2	08/06/2016	08/08/2016		2,134.94
AT&T SERVICES INC.	2016 101-410-435	TELEPHONE	1717995787 06/18/16	5787 - JUN 2	08/06/2016	08/08/2016		2,034.61
AT&T SERVICES INC.	2016 101-410-435	TELEPHONE	1717995787 07/18/16	5787 - JUL 2	08/06/2016	08/08/2016		2,034.15
AT&T SERVICES INC.	2016 101-410-435	TELEPHONE	9036543088 07/15/16	3088 - JUL 2	08/03/2016	08/08/2016		809.69
BANKNOTE CORPORATION OF	2016 101-131-238	DUE FROM VITAL S	BANKNOTE PAPER - 9.	IN1606038	08/01/2016	08/08/2016	301266	327.00
BIG H TIRE SERVICE	2016 101-560-445	REPAIRS & MAINT	UNIT 2585 - MOUNTED	161816	07/29/2016	08/08/2016		40.00
BLACKFORD PRINTING CO.	2016 101-131-242	DUE FROM COURTHO	500 REDEDICATION PR	34002	08/06/2016	08/08/2016		290.00
CHATFIELD WATER SUPPLY	2016 101-402-430	UTILITIES - PARK	EUESTER B WILLIAMS	1267 - JUL 2	08/03/2016	08/08/2016		27.00
CHATFIELD WATER SUPPLY	2016 101-512-385	COUNTY FARM	2810 NECR 0080	7 - JUL 2016	08/03/2016	08/08/2016		34.00
CHRIS GARRETT	2016 101-572-428	TRAVEL/CONFERENC	91 MILES @ .54	JUL 2016	08/03/2016	08/08/2016		49.14
CHRYSAL JANSSSEN	2016 101-572-428	TRAVEL/CONFERENC	372 MILES @ .54	JUL 2016	08/07/2016	08/08/2016		200.88
CITY ELECTRIC	2016 101-561-446	REPAIRS & MAINT	KERENS TOWER - ADDE	25972	07/29/2016	08/08/2016		346.91
CITY ELECTRIC	2016 101-512-445	REPAIRS & MAINT	SALLYPORT - REPLACE	25981	07/29/2016	08/08/2016		306.25
CODY MULDER	2016 101-131-242	DUE FROM COURTHO	07/09/16 - 07/15/16	3	07/29/2016	08/08/2016		700.00
COKER, JACKY	2016 101-402-423	SANITARY SERVICE	MOWING PARKS & CLEA	07/18/16	07/29/2016	08/08/2016		2,122.00
CONSTELLATION NEWENERGY	2016 101-410-430	UTILITIES	10443720008425191	0033996092-0	08/03/2016	08/08/2016		9.50
COOPER & FRENCH INSURAN	2016 101-512-417	BONDS	PHILLIPS, MATT 07/1	3935	08/01/2016	08/08/2016	301754	71.00
COOPER & FRENCH INSURAN	2016 101-560-417	BONDS	TANNER, ELMER 08/08	3934	08/01/2016	08/08/2016	301864	71.00
CORRECTIONS PRODUCTS CO	2016 101-512-445	REPAIRS & MAINT	24V DC DOOR LOCK	47462	08/01/2016	08/08/2016	301850	650.00
CORRECTIONS PRODUCTS CO	2016 101-512-445	REPAIRS & MAINT	SHIPPING	47462	08/01/2016	08/08/2016	301850	11.90
CORSICANA AIR CONDITION	2016 101-561-446	REPAIRS & MAINT	KERENS TOWER - REPL	56691	08/01/2016	08/08/2016	301829	2,747.00
CORSICANA DAILY SUN INC	2016 101-402-419	DUES & SUBSCRIPT	08/17/16 - 08/16/17	165 - 2016	07/29/2016	08/08/2016		119.88
CORSICANA GERANIUM GARD	2016 101-410-454	MAINT CONTRACT -	CH YARD MAINTENANCE	4955	08/06/2016	08/08/2016		550.00
CORSICANA GLASS & MIRRO	2016 101-512-445	REPAIRS & MAINT	JUSTICE CENTER - RE	0155481	08/01/2016	08/08/2016	301952	300.00
CORSICANA WATER DEPT	2016 101-410-430	UTILITIES	014-0000020-008 06/	221 W 1ST -	07/29/2016	08/08/2016		46.50
CORSICANA WATER DEPT	2016 101-410-430	UTILITIES	014-0000010-005 06/	223 W 1ST -	07/29/2016	08/08/2016		46.50
CORSICANA WATER DEPT	2016 101-410-430	UTILITIES	006-0001690-001 06/	300 W 3RD -	07/29/2016	08/08/2016		137.82
CORSICANA WATER DEPT	2016 101-410-430	UTILITIES	014-0000190-002 06/	312 W 1ST -	07/29/2016	08/08/2016		79.99
CORSICANA WATER DEPT	2016 101-410-430	UTILITIES	006-0001691-001 06/	CH SPKLR - J	07/29/2016	08/08/2016		489.42
CORSICANA WATER DEPT	2016 101-411-430	UTILITIES	014-0000120-003 06/	601 N 13TH -	07/29/2016	08/08/2016		184.32
CORSICANA WATER DEPT	2016 101-411-430	UTILITIES	014-0000122-002 06/	ANX SPKLR -	07/29/2016	08/08/2016		36.49
CORSICANA WATER DEPT	2016 101-512-435	UTILITIES	014-0000071-001 06/	312 W 2ND -	07/29/2016	08/08/2016		5,312.10
DAMARA WATKINS	2016 101-435-411	COURT APPOINTED	HARDAWAY, DOMINIQUE	36739	07/29/2016	08/08/2016		587.50
DAMARA WATKINS	2016 101-435-411	COURT APPOINTED	HARDAWAY, DOMINIQUE	34767 (2)	07/29/2016	08/08/2016		387.50
DANDA PARKER	2016 101-409-490	CHAPTER 19 EXPEN	2016 CERA CLASSES -	REIMB - 07/2	08/05/2016	08/08/2016		168.82
DANIEL ROBERT BILTZ	2016 101-435-411	COURT APPOINTED	MARA, KARENKA	36001	07/29/2016	08/08/2016		671.67
DANIEL ROBERT BILTZ	2016 101-435-411	COURT APPOINTED	MARA, KARENKA	36003	07/29/2016	08/08/2016		571.67
DANIEL ROBERT BILTZ	2016 101-435-411	COURT APPOINTED	MARA, KARENKA	36031	07/29/2016	08/08/2016		471.66
DANIEL ROBERT BILTZ	2016 101-435-490	MENTAL / AD LITE	ITIO	23142	08/06/2016	08/08/2016		1,420.50
DAVIE NEWLAND PAINTING	2016 101-512-445	REPAIRS & MAINT	JAIL - CAULKED ALL	1872B	08/01/2016	08/08/2016	300402	1,500.00
DEALERS ELECTRICAL SUPP	2016 101-512-445	REPAIRS & MAINT	BULBS	3305740-00	07/29/2016	08/08/2016		72.86
DEALERS ELECTRICAL SUPP	2016 101-512-445	REPAIRS & MAINT	DISCOUNT	3305740-00	07/29/2016	08/08/2016		.73-
DEALERS ELECTRICAL SUPP	2016 101-512-445	REPAIRS & MAINT	SWITCH, COVER, CONW	3305554-00	07/29/2016	08/08/2016		22.67

ALL RECORDS FROM 08/08/2016 TO 08/08/2016 DATE-TO-BE-PAID

VENDOR NAME	ACCOUNT #	ACCOUNT NAME	ITEM/REASON	INVOICE #	VP DATE	DATE TBP	PO NO	AMOUNT
DEALERS ELECTRICAL SUPP	2016 101-512-445	REPAIRS & MAINTENANCE	DISCOUNT	3305554-00	07/29/2016	08/08/2016		.28-
DEALERS ELECTRICAL SUPP	2016 101-410-321	MAINTENANCE SUPP	BULBS	3306168-00	08/03/2016	08/08/2016		87.90
DEALERS ELECTRICAL SUPP	2016 101-410-321	MAINTENANCE SUPP	DISCOUNT	3306168-00	08/03/2016	08/08/2016		.88-
DIGI-KEY ELECTRONICS 13	2016 101-512-445	REPAIRS & MAINTENANCE	STORM DIGITAL KEYPAD	54260872	08/01/2016	08/08/2016	301775	1,032.50
DIGI-KEY ELECTRONICS 13	2016 101-512-445	REPAIRS & MAINTENANCE	SHIPPING	54260872	08/01/2016	08/08/2016	301775	18.74
ELMER TANNER	2016 101-560-428	TRAVEL/CONFERENCE	138TH ANNUAL SHERIFF REIMB - 08/0		08/07/2016	08/08/2016		43.32
FEDEX - TXMAS	2016 101-406-311	POSTAGE	2934-0047-4	5-487-48141	07/29/2016	08/08/2016		30.32
FEDEX - TXMAS	2016 101-406-311	POSTAGE	2934-0047-4	5-494-89997	08/03/2016	08/08/2016		16.10
FIVE STAR SERVICES INC	2016 101-512-380	GROCERIES	06/30/16 - 07/06/16	25347	07/29/2016	08/08/2016		4,322.00
FIVE STAR SERVICES INC	2016 101-512-380	GROCERIES	07/07/16 - 07/13/16	25402	07/29/2016	08/08/2016		4,263.04
GALLS LLC	2016 101-560-426	UNIFORMS	CLASS B PANTS - GAS	005663565	08/01/2016	08/08/2016	301800	33.00
GALLS LLC	2016 101-560-426	UNIFORMS	WINDBREAKER - STRAU	005661222	08/01/2016	08/08/2016	301875	19.75
GALLS LLC	2016 101-560-426	UNIFORMS	CLASS B PANTS - STR	005661222	08/01/2016	08/08/2016	301875	66.00
GALLS LLC	2016 101-560-426	UNIFORMS	POLO SHIRTS - STRAU	005661222	08/01/2016	08/08/2016	301875	105.75
GALLS LLC	2016 101-560-426	UNIFORMS	CLASS B PANTS - HAN	005740383	08/06/2016	08/08/2016	301937	33.00
GALLS LLC	2016 101-560-426	UNIFORMS	SHIPPING	005740383	08/06/2016	08/08/2016	301937	3.26
GALLS LLC	2016 101-560-426	UNIFORMS	SS SHIRTS - NANNY,	005685572	08/06/2016	08/08/2016	301937	104.25
GALLS LLC	2016 101-560-426	UNIFORMS	SHIPPING	005685572	08/06/2016	08/08/2016	301937	16.74
GALLS LLC	2016 101-560-426	UNIFORMS	CLASS B PANTS - HAN	005685572	08/06/2016	08/08/2016	301937	66.00
GEXA ENERGY - HOUSTON	2016 101-560-429	TRAINING - FIRING	2810 NECR 0080 06/1	21545990-4	07/29/2016	08/08/2016		9.62
GEXA ENERGY - HOUSTON	2016 101-512-435	UTILITIES	312 W 2ND AVE 06/15	21545990-4	07/29/2016	08/08/2016		35.39
GEXA ENERGY - HOUSTON	2016 101-410-430	UTILITIES	221 W 1ST AVE 06/17	21565516-4	07/29/2016	08/08/2016		229.06
GEXA ENERGY - HOUSTON	2016 101-411-430	UTILITIES	601 N 13TH ST 06/17	21565516-4	07/29/2016	08/08/2016		1,202.80
GEXA ENERGY - HOUSTON	2016 101-410-430	UTILITIES	209 W 1ST AVE 06/17	21565516-4	07/29/2016	08/08/2016		64.42
GEXA ENERGY - HOUSTON	2016 101-410-430	UTILITIES	312 W 1ST AVE 06/17	21565516-4	07/29/2016	08/08/2016		9.50
GEXA ENERGY - HOUSTON	2016 101-410-430	UTILITIES	800 N MAIN ST 06/17	21565516-4	07/29/2016	08/08/2016		2,968.07
GEXA ENERGY - HOUSTON	2016 101-410-430	UTILITIES	800 N MAIN ST STE R	21565516-4	07/29/2016	08/08/2016		852.03
GEXA ENERGY - HOUSTON	2016 101-410-430	UTILITIES	400 W 2ND AVE 06/17	21565516-4	07/29/2016	08/08/2016		13.41
GEXA ENERGY - HOUSTON	2016 101-410-430	UTILITIES	312 W 1ST AVE BLDG	21565516-4	07/29/2016	08/08/2016		96.75
GEXA ENERGY - HOUSTON	2016 101-410-430	UTILITIES	800 N MAIN ST HSE 0	21565516-4	07/29/2016	08/08/2016		434.21
GEXA ENERGY - HOUSTON	2016 101-410-430	UTILITIES	448 TOWER ST OFC 06	21538207-4	08/03/2016	08/08/2016		25.06
GEXA ENERGY - HOUSTON	2016 101-410-430	UTILITIES	907 NW 2ND ST BLDG	21532203-4	08/03/2016	08/08/2016		94.68
GEXA ENERGY - HOUSTON	2016 101-410-430	UTILITIES	205 SE 3RD ST 06/14	21532203-4	08/03/2016	08/08/2016		44.07
GILFILLAN HARDWARE	2016 101-512-445	REPAIRS & MAINTENANCE	9000LB WIDE SQ JACK	59797/1	07/29/2016	08/08/2016		95.00
GILFILLAN HARDWARE	2016 101-512-445	REPAIRS & MAINTENANCE	SCREWS, BOLTS, PRIM	58830/1	07/29/2016	08/08/2016		9.94
GREENWORX PRINTING	2016 101-560-310	OFFICE SUPPLIES	BUSINESS CARDS - WI	49591	08/01/2016	08/08/2016	301873	33.06
GREENWORX PRINTING	2016 101-560-310	OFFICE SUPPLIES	BUSINESS CARDS - EL	49591	08/01/2016	08/08/2016	301873	33.06
GREENWORX PRINTING	2016 101-560-310	OFFICE SUPPLIES	BUSINESS CARDS - NA	49591	08/01/2016	08/08/2016	301873	33.06
GREENWORX PRINTING	2016 101-560-310	OFFICE SUPPLIES	BUSINESS CARDS - CA	49591	08/01/2016	08/08/2016	301873	33.06
GREENWORX PRINTING	2016 101-560-310	OFFICE SUPPLIES	BUSINESS CARDS - ST	49591	08/01/2016	08/08/2016	301873	33.06
HILLIARD MEMORIALS	2016 101-406-491	HEALTH & SERVICE	MONTGOMERY, JAMES M	07/06/16	08/05/2016	08/08/2016		200.00
ICS	2016 101-512-350	INMATE SUPPLIES	GEL TOOTHPASTE	138720	08/01/2016	08/08/2016	301984	182.50
ICS	2016 101-512-350	INMATE SUPPLIES	CLEAR SECURITY RAZO	138720	08/01/2016	08/08/2016	301984	204.00
ICS	2016 101-512-350	INMATE SUPPLIES	UNWRAPPED SOAP	138720	08/01/2016	08/08/2016	301984	279.20
ICS	2016 101-512-350	INMATE SUPPLIES	3 1/2" GOLF PENCILS	138720	08/01/2016	08/08/2016	301984	49.00
ICS	2016 101-512-351	INMATE LINEN & B	THERMAL BLANKETS	138509	08/01/2016	08/08/2016	301950	1,725.00
IJS COMPANY	2016 101-512-330	JANITORIAL SUPPL	TOWEL-M/F NATURAL-4	136343	08/01/2016	08/08/2016	301985	311.25
IJS COMPANY	2016 101-512-330	JANITORIAL SUPPL	LINER-40X48 16 MIC-	136343	08/01/2016	08/08/2016	301985	198.40
IJS COMPANY	2016 101-512-330	JANITORIAL SUPPL	TISSUE-BATH NOVA 2P	136343	08/01/2016	08/08/2016	301985	1,036.50
IJS COMPANY	2016 101-512-330	JANITORIAL SUPPL	BLEACH-LIQUID 5.25%	136343	08/01/2016	08/08/2016	301985	211.50
IJS COMPANY	2016 101-512-330	JANITORIAL SUPPL	SOAP-LAUNDRY SUPER	136343	08/01/2016	08/08/2016	301985	262.50
IJS COMPANY	2016 101-512-330	JANITORIAL SUPPL	GLASS CLEANER-MAXIM	136343	08/01/2016	08/08/2016	301985	23.80
IJS COMPANY	2016 101-512-350	INMATE SUPPLIES	SANITARY-NATURELLE	136343	08/01/2016	08/08/2016	301985	205.00
IJS COMPANY	2016 101-512-325	KITCHEN SUPPLIES	FOIL-18" X 500' HVY	136210	08/01/2016	08/08/2016	301967	30.03
IJS COMPANY	2016 101-512-325	KITCHEN SUPPLIES	CUP-STYRO 14 OZ - 4	136210	08/01/2016	08/08/2016	301967	119.88

ALL RECORDS FROM 08/08/2016 TO 08/08/2016 DATE-TO-BE-PAID

VENDOR NAME	ACCOUNT #	ACCOUNT NAME	ITEM/REASON	INVOICE #	VP DATE	DATE TBP	PO NO	AMOUNT
IJS COMPANY	2016 101-512-325	KITCHEN SUPPLIES	TRAY-STYRO H/L 3-CO	136210	08/01/2016	08/08/2016	301967	129.54
IJS COMPANY	2016 101-512-325	KITCHEN SUPPLIES	LINER-38X58 2 MIL-1	136210	08/01/2016	08/08/2016	301967	100.98
IJS COMPANY	2016 101-512-325	KITCHEN SUPPLIES	PAD-HAND 6X9 GREEN	136210	08/01/2016	08/08/2016	301967	15.00
INTERSTATE PLASTICS	2016 101-512-445	REPAIRS & MAINT	.5 X 38 X 38 ABRASI	947462	08/01/2016	08/08/2016	301796	1,412.84
INTERSTATE PLASTICS	2016 101-512-445	REPAIRS & MAINT	SHIPPING	947462	08/01/2016	08/08/2016	301796	129.15
JACOBSON LAW FIRM PC	2016 101-406-410	PROFESSIONAL SER	798-70000 - JUN 20	47867	08/03/2016	08/08/2016		5,978.20
JACOBSON LAW FIRM PC	2016 101-406-410	PROFESSIONAL SER	800-10000 - JUN 20	47868	08/05/2016	08/08/2016		15,669.67
JOHNSON OIL COMPANY	2016 101-560-370	GAS & OIL	2400 GAL GAS	18131	08/01/2016	08/08/2016	301949	4,184.40
JOHNSON OIL COMPANY	2016 101-560-370	GAS & OIL	2400 GAL GAS	18395	08/01/2016	08/08/2016	302021	3,884.40
JOSH TACKETT	2016 101-440-428	TRAVEL/CONFERENC	2016 LEGISLATIVE CO	AUG 2016	08/05/2016	08/08/2016		127.50
JOSH TACKETT	2016 101-440-428	TRAVEL/CONFERENC	2016 LEGISLATIVE CO	AUG 2016	08/05/2016	08/08/2016		169.56
K & S TIRE TOWING & REC	2016 101-560-445	REPAIRS & MAINT	UNIT 2945 - OIL CHA	62929	07/29/2016	08/08/2016		42.95
K & S TIRE TOWING & REC	2016 101-560-445	REPAIRS & MAINT	UNIT 2160 - OIL CHA	62884	07/29/2016	08/08/2016		61.69
K & S TIRE TOWING & REC	2016 101-560-445	REPAIRS & MAINT	UNIT 2262 - OIL CHA	62934	07/29/2016	08/08/2016		60.44
K & S TIRE TOWING & REC	2016 101-560-445	REPAIRS & MAINT	UNIT 2264 - RECHARG	62822	08/01/2016	08/08/2016	301925	244.53
K & S TIRE TOWING & REC	2016 101-560-445	REPAIRS & MAINT	UNIT 2583 - ALIGNME	62897	08/01/2016	08/08/2016	301970	291.84
K & S TIRE TOWING & REC	2016 101-553-312	OPERATING SUPPLI	UNIT 2618 - TOWED	62827	08/06/2016	08/08/2016	301831	138.00
K & S TIRE TOWING & REC	2016 101-402-444	REPAIRS & MAINT	UNIT 2838 - REPLACE	62950	08/08/2016	08/08/2016	301989	259.36
KEATHLEY & KEATHLEY	2016 101-430-411	COURT APPOINTED	JONES, STACEY	36590	07/29/2016	08/08/2016		400.00
KEATHLEY & KEATHLEY	2016 101-435-411	COURT APPOINTED	SHANNON, RONNIE	36773	07/29/2016	08/08/2016		400.00
KEATHLEY & KEATHLEY	2016 101-425-411	COURT APPOINTED	PENNINGTON, LB	71364	07/29/2016	08/08/2016		75.00
KEATHLEY & KEATHLEY	2016 101-425-411	COURT APPOINTED	PENNINGTON, LB	72286	07/29/2016	08/08/2016		75.00
KEATHLEY & KEATHLEY	2016 101-425-411	COURT APPOINTED	PENNINGTON, LB	72978	07/29/2016	08/08/2016		225.00
KEATHLEY & KEATHLEY	2016 101-425-411	COURT APPOINTED	PENNINGTON, LB	71582	07/29/2016	08/08/2016		125.00
KEATHLEY & KEATHLEY	2016 101-425-411	COURT APPOINTED	PENNINGTON, LB	73072	07/29/2016	08/08/2016		75.00
KEATHLEY & KEATHLEY	2016 101-425-411	COURT APPOINTED	PENNINGTON, LB	71816	07/29/2016	08/08/2016		75.00
KEATHLEY & KEATHLEY	2016 101-430-411	COURT APPOINTED	ALEXANDER, ZALYNVIA	36386	08/05/2016	08/08/2016		400.00
KEATHLEY & KEATHLEY	2016 101-430-411	COURT APPOINTED	ALEXANDER, ZALYNVIA	36388	08/05/2016	08/08/2016		600.00
KEATHLEY & KEATHLEY	2016 101-430-411	COURT APPOINTED	ALEXANDER, ZALYNVIA	36390	08/05/2016	08/08/2016		100.00
KELLY R MYERS, ATTORNEY	2016 101-425-411	COURT APPOINTED	NOWAKOWSKI, KRISTOP	72663	07/29/2016	08/08/2016		200.00
KELLY R MYERS, ATTORNEY	2016 101-425-411	COURT APPOINTED	NOWAKOWSKI, KRISTOP	72664	07/29/2016	08/08/2016		100.00
KELLY R MYERS, ATTORNEY	2016 101-435-490	MENTAL / AD LITE	ITIO	23610 (2)	08/05/2016	08/08/2016		600.00
KELLY R MYERS, ATTORNEY	2016 101-435-490	MENTAL / AD LITE	ITIO	14468	08/05/2016	08/08/2016		750.00
L-3 COM MOBILE-VISION I	2016 101-560-340	INVESTIGATIVE /	BODYVISION CAMERA K	0242879-IN	08/01/2016	08/08/2016	301871	4,990.00
L-3 COM MOBILE-VISION I	2016 101-560-340	INVESTIGATIVE /	BODYVISION SINGLE D	0242879-IN	08/01/2016	08/08/2016	301871	255.00
L-3 COM MOBILE-VISION I	2016 101-560-340	INVESTIGATIVE /	SHIPPING	0242879-IN	08/01/2016	08/08/2016	301871	25.00
LAW OFFICE OF BRIDGETTE	2016 101-435-411	COURT APPOINTED	FAULK, NATHANIEL	36577	07/29/2016	08/08/2016		400.00
LAW OFFICE OF KERRI AND	2016 101-425-411	COURT APPOINTED	GOODNOE, PAULA	70238	07/29/2016	08/08/2016		150.00
LAW OFFICE OF MICAH C H	2016 101-425-411	COURT APPOINTED	WARE, ASHLEY	72238	08/06/2016	08/08/2016		962.50
LAW OFFICE OF MICAH C H	2016 101-425-485	OTHER LITIGATION	WARE, ASHLEY	72238	08/06/2016	08/08/2016		4.00
LENOVO FINANCIAL SERVIC	2016 101-440-320	OPERATING EQUIPM	908-0008685-000 - J	28917478	07/29/2016	08/08/2016		652.10
LENOVO FINANCIAL SERVIC	2016 101-495-320	OPERATING EQUIPM	908-0009025-000 - J	28939896	08/05/2016	08/08/2016		466.53
LEXIS NEXIS - DALLAS	2016 101-475-419	DUES & SUBSCRIPT	1000RVZSP 07/01/16	3090609047	08/05/2016	08/08/2016		238.14
LEXIS NEXIS - DALLAS	2016 101-440-419	DUES & SUBSCRIPT	163NBF 07/01/16 - 0	1607425811	08/07/2016	08/08/2016		150.00
LOCHRIDGE PRIEST INC ~	2016 101-411-450	MAINT CONTRACT -	MAINTENANCE 07/01/1	CS246C	07/29/2016	08/08/2016		620.58
MEDICAL SURGICAL & COMP	2016 101-572-411	NON-RESIDENTIAL	3717, 3713, 3607	3233	07/29/2016	08/08/2016		96.00
MEDICAL SURGICAL & COMP	2016 101-572-411	NON-RESIDENTIAL	3730, 3732	3195	07/29/2016	08/08/2016		102.50
MEDICAL SURGICAL & COMP	2016 101-572-411	NON-RESIDENTIAL	3727	3144	08/03/2016	08/08/2016		32.00
MELANIE HYDER	2016 101-572-428	TRAVEL/CONFERENC	272 MILES @ .54	JUL 2016	08/03/2016	08/08/2016		146.88
MEN WATER SUPPLY CORP	2016 101-402-430	UTILITIES - PARK	CASTON PARK	775 - JUL 20	08/05/2016	08/08/2016		27.64
MICHAEL J CRAWFORD	2016 101-435-411	COURT APPOINTED	INFANTE, MARGARITA	NOT INDICTED	07/29/2016	08/08/2016		400.00
MICHAEL J CRAWFORD	2016 101-435-411	COURT APPOINTED	JUVENILE	2203	07/29/2016	08/08/2016		450.00
NATIONAL LASER CARTRIDG	2016 101-512-310	OFFICE SUPPLIES	BROTHER TONERS	00056611	08/05/2016	08/08/2016	254554	211.50
NATIONAL LASER CARTRIDG	2016 101-512-310	OFFICE SUPPLIES	BROTHER TONERS	00056610	08/05/2016	08/08/2016	254554	638.49
NAVARRO COUNTY ELECTRIC	2016 101-402-430	UTILITIES - PARK	13767900 - SECR 310	7900 - JUL 2	08/03/2016	08/08/2016		18.36

ALL RECORDS FROM 08/08/2016 TO 08/08/2016 DATE-TO-BE-PAID

VENDOR NAME	ACCOUNT #	ACCOUNT NAME	ITEM/REASON	INVOICE #	VP DATE	DATE TBP	PO NO	AMOUNT
NAVARRO COUNTY ELECTRIC	2016 101-402-430	UTILITIES - PARK	13258900 - SECR 109 8900 - JUL 2	08/03/2016	08/08/2016			9.78
NAVARRO COUNTY ELECTRIC	2016 101-402-430	UTILITIES - PARK	13259700 - SECR 216 9700 - JUL 2	08/03/2016	08/08/2016			8.58
NAVARRO COUNTY ELECTRIC	2016 101-512-435	UTILITIES	11255700 - HWY 0022 5700 - JUL 2	08/03/2016	08/08/2016			140.00
NAVARRO COUNTY ELECTRIC	2016 101-512-435	UTILITIES	14707000 - FM 0667 7000 - JUL 2	08/07/2016	08/08/2016			47.00
NAVARRO COUNTY ELECTRIC	2016 101-512-435	UTILITIES	15514400 - MCKINNEY 4400 - JUL 2	08/07/2016	08/08/2016			48.00
NAVARRO COUNTY ELECTRIC	2016 101-402-430	UTILITIES - PARK	13260500 - HWY 0309 0500 - JUL 2	08/03/2016	08/08/2016			9.78
NAVARRO COUNTY HEALTH U	2016 101-512-385	COUNTY FARM	RABIES END TITER TE	07/14/16	08/01/2016	08/08/2016	301690	201.00
NAVARRO COUNTY HEALTH U	2016 101-512-385	COUNTY FARM	SHIPPING	07/14/16	08/01/2016	08/08/2016	301690	76.00
NAVARRO COUNTY HEALTH U	2016 101-512-385	COUNTY FARM	DRAW FEE	07/14/16	08/01/2016	08/08/2016	301690	60.00
NAVCO LOCKSMITHS	2016 101-560-445	REPAIRS & MAINT	KEYS	R071105	07/29/2016	08/08/2016		5.08
NEXUS RECOVERY CENTER I	2016 101-572-631	DETENTION/PRE AD	3709	JUN 2016	07/29/2016	08/08/2016		2,000.00
NORTHLAND COMMUNICATION	2016 101-561-436	INTERNET	312 W 2ND AVE 08/01	001-466387 -	07/29/2016	08/08/2016		75.99
NORTHLAND COMMUNICATION	2016 101-568-436	INTERNET	223 W 1ST AVE 08/01	001-990490 -	07/29/2016	08/08/2016		143.99
NORTHLAND COMMUNICATION	2016 101-475-436	INTERNET	SUITE 203 08/01/16	001-992860 -	08/03/2016	08/08/2016		151.99
OFFICE DEPOT INC-TXMAS	2016 101-561-310	OFFICE SUPPLIES	RUBBERBANDS, CORREC	850151259001	07/29/2016	08/08/2016	301964	189.20
OFFICE DEPOT INC-TXMAS	2016 101-403-310	OFFICE SUPPLIES	CD-R	849274476001	08/01/2016	08/08/2016	301924	12.32
OFFICE DEPOT INC-TXMAS	2016 101-403-310	OFFICE SUPPLIES	TAPE, FOLDERS, MAIL	849274315001	08/01/2016	08/08/2016	301924	85.82
OFFICE DEPOT INC-TXMAS	2016 101-406-312	COPY & POSTAGE S	COPY PAPER	849348876001	08/01/2016	08/08/2016	301923	374.40
OFFICE DEPOT INC-TXMAS	2016 101-560-310	OFFICE SUPPLIES	PENS, CORRECTION TA	849221755001	08/01/2016	08/08/2016	301912	212.12
OFFICE DEPOT INC-TXMAS	2016 101-406-312	COPY & POSTAGE S	COPY PAPER	848908021001	08/01/2016	08/08/2016	301911	171.20
OFFICE DEPOT INC-TXMAS	2016 101-497-310	OFFICE SUPPLIES	BINDER	848271705001	08/01/2016	08/08/2016	301882	15.49
OFFICE DEPOT INC-TXMAS	2016 101-497-310	OFFICE SUPPLIES	RUBBERBANDS, PAPER	848271647001	08/01/2016	08/08/2016	301882	18.51
OFFICE DEPOT INC-TXMAS	2016 101-475-310	OFFICE SUPPLIES	HEAVY DUTY FILE FOL	846866674001	08/01/2016	08/08/2016	301772	774.20
OFFICE DEPOT INC-TXMAS	2016 101-499-310	OFFICE SUPPLIES	HP 45 INK, PENS, TA	847761925001	08/01/2016	08/08/2016	301868	177.00
OFFICE DEPOT INC-TXMAS	2016 101-406-312	COPY & POSTAGE S	COPY PAPER	847758344001	08/01/2016	08/08/2016	301869	67.98
OFFICE DEPOT INC-TXMAS	2016 101-402-310	OFFICE SUPPLIES	METAL SIGN HOLDERS	847267262001	08/01/2016	08/08/2016	301848	59.94
OFFICE DEPOT INC-TXMAS	2016 101-458-310	OFFICE SUPPLIES	HP 950XL/951 INK	848632981001	08/01/2016	08/08/2016	301883	185.74
OFFICE DEPOT INC-TXMAS	2016 101-560-310	OFFICE SUPPLIES	FILE FOLDERS, END-T	849687841001	08/07/2016	08/08/2016	301936	198.60
OFFICE DEPOT INC-TXMAS	2016 101-560-310	OFFICE SUPPLIES	MAILERS	849688038001	08/07/2016	08/08/2016	301936	15.99
OLSEN FEED & SUPPLY	2016 101-512-385	COUNTY FARM	2.5 GAL ERASER H/D	373148	07/29/2016	08/08/2016		89.95
OTIS ELEVATOR COMPANY	2016 101-512-452	MAINT CONTRACT -	08/01/16 - 08/31/16	TW07725816	07/29/2016	08/08/2016		592.82
OWEN HARDWARE INC	2016 101-512-385	COUNTY FARM	WASP/HORNET SPRAY	AA52210	08/05/2016	08/08/2016		6.58
PCMG INC	2016 101-512-457	MAINT CONTRACT -	13" ALIENWARE LAPTO	S97203500101	08/01/2016	08/08/2016	301899	2,898.00
REPUBLIC SERVICES #069	2016 101-410-430	UTILITIES	3-0069-0052337 - JU	0069-0008254	08/03/2016	08/08/2016		478.17
RESIDENCE INN AUSTIN DO	2016 101-440-428	TRAVEL/CONFERENC	2016 LEGISLATIVE CO	TACKETT, JOS	08/05/2016	08/08/2016		388.70
ROBLES LAW FIRM	2016 101-430-411	COURT APPOINTED	HERNANDEZ JR, ARTEM	34428	07/29/2016	08/08/2016		400.00
ROBLES LAW FIRM	2016 101-430-411	COURT APPOINTED	MATHIS, GARY WAYNE	36440	07/29/2016	08/08/2016		1,540.00
SANTA FE DISTRIBUTING I	2016 101-512-445	REPAIRS & MAINT	RG-8X COAX	00261769B	08/01/2016	08/08/2016	301802	69.00
SANTA FE DISTRIBUTING I	2016 101-512-445	REPAIRS & MAINT	TOOL POUCH	00261769B	08/01/2016	08/08/2016	301802	11.87
SANTA FE DISTRIBUTING I	2016 101-512-445	REPAIRS & MAINT	MINI UHF CONNECTOR	00261769B	08/01/2016	08/08/2016	301802	4.52
SANTA FE DISTRIBUTING I	2016 101-512-445	REPAIRS & MAINT	SHIPPING	00261769B	08/01/2016	08/08/2016	301802	16.15
SANTA FE DISTRIBUTING I	2016 101-560-446	REPAIRS & MAINT	SAW BLADES	00261769B	08/01/2016	08/08/2016	301802	44.92
SANTA FE DISTRIBUTING I	2016 101-560-446	REPAIRS & MAINT	SAW DRILL BIT	00261769B	08/01/2016	08/08/2016	301802	9.59
SHERIFF, PETTY CASH	2016 101-406-311	POSTAGE		08/03/16	08/05/2016	08/08/2016		10.05
SHERIFF, PETTY CASH	2016 101-560-370	GAS & OIL	TRANSPORT - WICKLIF	07/26/16	08/05/2016	08/08/2016		10.00
SHERIFF, PETTY CASH	2016 101-560-370	GAS & OIL	TRANSPORT - VANLOOC	07/25/16	08/05/2016	08/08/2016		35.00
SHERIFF, PETTY CASH	2016 101-560-370	GAS & OIL	TRANSPORT - VANLOOC	07/25/16	08/07/2016	08/08/2016		31.55
SMALL ENGINE SALES & SE	2016 101-512-385	COUNTY FARM	KEVLAR BELT	173661	07/29/2016	08/08/2016		23.16
SMITH GENERAL STORE	2016 101-512-385	COUNTY FARM	CATTLE FLAPPER	95012	07/29/2016	08/08/2016		19.95
SOUTHERN HEALTH PARTNER	2016 101-512-460	INMATE MEDICAL -	AUG 2016	BASE27192	07/29/2016	08/08/2016		24,864.84
SOUTHERN SOFTWARE INC	2016 101-512-457	MAINT CONTRACT -	BIOMETRIC SCANNER M	236480	08/01/2016	08/08/2016	301986	395.00
SOUTHERN SOFTWARE INC	2016 101-512-457	MAINT CONTRACT -	TOPAZ SIGNATURE PAD	236480	08/01/2016	08/08/2016	301986	530.00
SOUTHERN SOFTWARE INC	2016 101-512-457	MAINT CONTRACT -	SHIPPING	236480	08/01/2016	08/08/2016	301986	25.00
SOUTHERN SOFTWARE INC	2016 101-512-457	MAINT CONTRACT -	NETMOTION	234022B	08/07/2016	08/08/2016	254409	4,703.12
SOUTHERN SOFTWARE INC	2016 101-512-457	MAINT CONTRACT -	MAINTENANCE	234022B	08/07/2016	08/08/2016	254409	1,968.75

ALL RECORDS FROM 08/08/2016 TO 08/08/2016 DATE-TO-BE-PAID

VENDOR NAME	ACCOUNT #	ACCOUNT NAME	ITEM/REASON	INVOICE #	VP DATE	DATE TBP	PO NO	AMOUNT
SPIT SHINE FLOORS	2016 101-411-459	MAINT CONTRACT -	07/01/16 - 07/31/16	4069	07/29/2016	08/08/2016		540.00
SUSAN A WALDRIP COURT R	2016 101-435-412	TRANSCRIPTS	36269	10489	08/05/2016	08/08/2016		295.00
T & G IDENTIFICATION SY	2016 101-560-310	OFFICE SUPPLIES	YMCKK COLOR RIBBON	155689-A	08/01/2016	08/08/2016	301901	460.00
T & G IDENTIFICATION SY	2016 101-560-310	OFFICE SUPPLIES	HOLOGRAPHIC 1 MIL L	155689-A	08/01/2016	08/08/2016	301901	130.00
T & G IDENTIFICATION SY	2016 101-560-310	OFFICE SUPPLIES	TRANSFER FILM	155689-A	08/01/2016	08/08/2016	301901	125.00
T & G IDENTIFICATION SY	2016 101-560-310	OFFICE SUPPLIES	SHIPPING	155689-A	08/01/2016	08/08/2016	301901	20.00
TEXAS ASSN OF COUNTIES	2016 101-440-428	TRAVEL/CONFERENC	2016 LEGISLATIVE CO	TACKETT, JOS	08/05/2016	08/08/2016		250.00
TEXAS DISTRICT & COUNTY	2016 101-475-428	TRAVEL/CONFERENC	TDCAA CRIMINAL & CI	DIXON, WILLI	08/05/2016	08/08/2016		350.00
THEDFORD OFFICE SUPPLY	2016 101-512-310	OFFICE SUPPLIES	BROTHER 210 DRUM UN	27960	08/01/2016	08/08/2016	301942	145.00
THEDFORD OFFICE SUPPLY	2016 101-560-310	OFFICE SUPPLIES	BROTHER 115 TONER -	27959	08/01/2016	08/08/2016	301892	139.98
THEDFORD OFFICE SUPPLY	2016 101-560-310	OFFICE SUPPLIES	BROTHER 115 TONER -	27959	08/01/2016	08/08/2016	301892	69.99
THEDFORD OFFICE SUPPLY	2016 101-560-310	OFFICE SUPPLIES	BROTHER 221 TONER -	27959	08/01/2016	08/08/2016	301892	99.98
THEDFORD OFFICE SUPPLY	2016 101-560-310	OFFICE SUPPLIES	BROTHER 225 TONER -	27959	08/01/2016	08/08/2016	301892	49.99
THEDFORD OFFICE SUPPLY	2016 101-560-310	OFFICE SUPPLIES	BROTHER 225 TONER -	27959	08/01/2016	08/08/2016	301892	49.99
THEDFORD OFFICE SUPPLY	2016 101-560-310	OFFICE SUPPLIES	BROTHER 210 TONER -	27959	08/01/2016	08/08/2016	301892	99.98
TIM'S TIRES & WHEELS	2016 101-560-445	REPAIRS & MAINT	UNIT 2728 - INSPECT	060779	07/29/2016	08/08/2016		7.00
TIM'S TIRES & WHEELS	2016 101-560-445	REPAIRS & MAINT	UNIT 2586 - INSPECT	060775	07/29/2016	08/08/2016		7.00
TIM'S TIRES & WHEELS	2016 101-560-445	REPAIRS & MAINT	UNIT 2945 - FLAT	060686	07/29/2016	08/08/2016		8.00
TIM'S TIRES & WHEELS	2016 101-560-445	REPAIRS & MAINT	UNIT 2262 - INSPECT	060602	07/29/2016	08/08/2016		7.00
TIM'S TIRES & WHEELS	2016 101-560-445	REPAIRS & MAINT	UNIT 2582 - FLAT	060642	07/29/2016	08/08/2016		8.00
TRIAD MARINE & IDUSTRIA	2016 101-568-575	MACHINERY & EQUI	SHIPPING	201607060	08/07/2016	08/08/2016	301459	625.00
TRIAD MARINE & IDUSTRIA	2016 101-568-575	MACHINERY & EQUI	ZODIAC FC420 LSRF R	201607060	08/07/2016	08/08/2016	301459	15,550.00
TRIAD MARINE & IDUSTRIA	2016 101-568-575	MACHINERY & EQUI	EVINRUDE E-TEC 40 H	201607060	08/07/2016	08/08/2016	301459	4,905.00
TRIAD MARINE & IDUSTRIA	2016 101-568-575	MACHINERY & EQUI	GALVANIZED TRAILER	201607060	08/07/2016	08/08/2016	301459	2,550.00
TRIAD MARINE & IDUSTRIA	2016 101-568-575	MACHINERY & EQUI	6 GAL FUEL TANK, TO	201607060	08/07/2016	08/08/2016	301459	1,351.00
TROPHIES UNLIMITED	2016 101-560-426	UNIFORMS	NAME TAG - NANNY, R	I3802	07/29/2016	08/08/2016		7.00
TROPHIES UNLIMITED	2016 101-560-426	UNIFORMS	NAME TAGS	I3940	07/29/2016	08/08/2016		42.00
TX DEPT OF STATE HEALTH	2016 101-403-410	PROFESSIONAL SER	REMOTE BIRTH ACCESS	2001128	07/29/2016	08/08/2016		124.44
VIRTUAL GRAFFITI INC	2016 101-512-457	MAINT CONTRACT -	WATCHGUARD FIREBOX	679703	08/06/2016	08/08/2016	301988	4,480.00
VIRTUAL GRAFFITI INC	2016 101-407-312	COMPUTER SUPPLIE	RJ45 TRANSCEIVER FI	677943	08/07/2016	08/08/2016		20.00
WATERWORKS	2016 101-410-445	REPAIRS & MAINT	REPAIRED IRRIGATION	13120	08/05/2016	08/08/2016		185.15
WEST PUBLISHING CORP	2016 101-435-419	DUES & PUBLICATI	1000234522 06/01/16	834256934	07/29/2016	08/08/2016		541.42
WEST 31 CONTRACTORS	2016 101-411-445	REPAIRS & MAINT	REVERSED DOOR IN CO	1118	08/01/2016	08/08/2016	301888	100.00
WEST 31 CONTRACTORS	2016 101-411-445	REPAIRS & MAINT	CORED HOLES, POSTED	1118	08/01/2016	08/08/2016	301888	400.00
WEST 31 CONTRACTORS	2016 101-411-445	REPAIRS & MAINT	MODIFIED TOILET PAR	1118	08/01/2016	08/08/2016	301888	500.00
WEST 31 CONTRACTORS	2016 101-411-445	REPAIRS & MAINT	REMOVED TOILETS, IN	1118	08/01/2016	08/08/2016	301888	2,700.00
WEST 31 CONTRACTORS	2016 101-411-445	REPAIRS & MAINT	MATERIALS	1118	08/01/2016	08/08/2016	301888	300.00
WEST 31 CONTRACTORS	2016 101-410-445	REPAIRS & MAINT	CAULKED & REPAIRED	1120	08/05/2016	08/08/2016		3,508.00
WEST 31 CONTRACTORS	2016 101-410-445	REPAIRS & MAINT	HANDICAP RAMP DENSI	1119	08/05/2016	08/08/2016		305.00
WEX BANK	2016 101-560-370	GAS & OIL	369-801-668-4 - 07/	07688	08/05/2016	08/08/2016		43.80
WEX BANK	2016 101-560-370	GAS & OIL	369-801-668-4 - 07/	11153	08/05/2016	08/08/2016		34.43
WEX BANK	2016 101-560-370	GAS & OIL	369-801-668-4 - 08/	55765	08/05/2016	08/08/2016		42.40
WEX BANK	2016 101-560-370	GAS & OIL	369-801-668-4 - 07/	31797	08/06/2016	08/08/2016		41.78
WEX BANK	2016 101-560-370	GAS & OIL	369-801-668-4 - ACC	46207949	08/06/2016	08/08/2016		5.00
WEX BANK	2016 101-560-370	GAS & OIL	369-801-668-4 - REB	46207949	08/06/2016	08/08/2016		1.60-
WILLIAM DIXON	2016 101-475-428	TRAVEL/CONFERENC	TDCAA CRIMINAL & CI	SEP 2016	08/05/2016	08/08/2016		240.98
WILLIAM EARL PRICE	2016 101-430-411	COURT APPOINTED	CARRILLO, NICHOLAS	36474	07/29/2016	08/08/2016		650.00
WILLIAM EARL PRICE	2016 101-430-411	COURT APPOINTED	HINOJOSA, RYAN	34234 (2)	07/29/2016	08/08/2016		275.00
WILLIAM EARL PRICE	2016 101-430-411	COURT APPOINTED	HINOJOSA, RYAN	34235 (2)	07/29/2016	08/08/2016		175.00
WILLIAM EARL PRICE	2016 101-430-411	COURT APPOINTED	RICHARDS, EMILY	36008 (2)	07/29/2016	08/08/2016		275.00
WILLIAM EARL PRICE	2016 101-430-411	COURT APPOINTED	RICHARDS, EMILY	36010 (2)	07/29/2016	08/08/2016		175.00
XEROX BUSINESS SERVICES	2016 101-403-410	PROFESSIONAL SER	289570 - JUL 2016	1287283	07/29/2016	08/08/2016		3,173.50
XEROX BUSINESS SERVICES	2016 101-131-235	DUE FROM CC ARCH	289570 - JUL 2016	1287283	07/29/2016	08/08/2016		4,325.00
XEROX CORP - TXMAS	2016 101-403-440	COPIER RENTAL	721494623 - JUL	085385019	07/29/2016	08/08/2016		232.61
XEROX CORP - TXMAS	2016 101-512-440	COPIER RENTAL	712036656 - JUL	085369412	07/29/2016	08/08/2016		251.35

ALL RECORDS FROM 08/08/2016 TO 08/08/2016 DATE-TO-BE-PAID

VENDOR NAME	ACCOUNT #	ACCOUNT NAME	ITEM/REASON	INVOICE #	VP DATE	DATE TBP PO NO	AMOUNT
							----- 203,929.37

ALL RECORDS FROM 08/08/2016 TO 08/08/2016 DATE-TO-BE-PAID

VENDOR NAME	ACCOUNT #	ACCOUNT NAME	ITEM/REASON	INVOICE #	VP DATE	DATE TBP PO NO	AMOUNT
CORRECTIONS SOFTWARE SO	2016 151-571-315	COMPUTER SERVICE	AUG 2016	31003	08/03/2016	08/08/2016	1,990.00
K & S TIRE TOWING & REC	2016 151-571-445	REPAIRS & MAINT	2010 CHEVY TAHOE -	62967	08/05/2016	08/08/2016 301876	173.73
REDWOOD BIOTECH	2016 151-571-411	DRUG TESTING SER	109188 - JUN 2016	10918820166	07/29/2016	08/08/2016	225.00
REDWOOD BIOTECH	2016 151-571-355	DRUG TESTING SUP	DRUG TESTING KITS	563497	08/01/2016	08/08/2016 301893	576.00
REDWOOD BIOTECH	2016 151-571-355	DRUG TESTING SUP	SHIPPING	563497	08/01/2016	08/08/2016 301893	51.21
WEX BANK	2016 151-571-370	GAS, OIL & REPAI	369-801-668-4 - ACC	46207949	08/06/2016	08/08/2016	5.00
WEX BANK	2016 151-571-370	GAS, OIL & REPAI	369-801-668-4 - REB	46207949	08/06/2016	08/08/2016	.62-

							3,020.32

ALL RECORDS FROM 08/08/2016 TO 08/08/2016 DATE-TO-BE-PAID

VENDOR NAME	ACCOUNT #	ACCOUNT NAME	ITEM/REASON	INVOICE #	VP DATE	DATE TBP	PO NO	AMOUNT
GULF COAST TRADES CENTE	2016 161-577-683	RESIDENTIAL PLAC	3624	201315130	07/29/2016	08/08/2016		2,670.00
LIMESTONE COUNTY JUVENI	2016 161-575-631	DETENTION/PRE AD	3621	175-28	07/29/2016	08/08/2016		595.00
RECOVERY HEALTHCARE COR	2016 161-576-603	COMM BASED-GENER	3733	8801531	07/29/2016	08/08/2016		93.50
RECOVERY HEALTHCARE COR	2016 161-576-603	COMM BASED-GENER	3733	64805	07/29/2016	08/08/2016		22.00-

								3,336.50

ALL RECORDS FROM 08/08/2016 TO 08/08/2016 DATE-TO-BE-PAID

VENDOR NAME	ACCOUNT #	ACCOUNT NAME	ITEM/REASON	INVOICE #	VP DATE	DATE TBP	PO NO	AMOUNT
APAC TEXAS INC	2016 211-611-376	ROAD MATERIAL	NE1040, NE0250	200497415	08/03/2016	08/08/2016		162.06
APAC TEXAS INC	2016 211-611-376	ROAD MATERIAL	NE0220	200498231	08/03/2016	08/08/2016		210.90
ARNOLD CRUSHED STONE	2016 211-611-376	ROAD MATERIAL	NW0150, NW1350, YAR	232292	08/03/2016	08/08/2016		513.31
ARNOLD CRUSHED STONE	2016 211-611-376	ROAD MATERIAL	NE0180	232272	08/03/2016	08/08/2016		503.12
AT&T SERVICES INC.	2016 211-611-435	TELEPHONE	287236363034 06/20/	3034 - JUL 2	08/03/2016	08/08/2016		51.79
ATWOODS DISTRIBUTING LP	2016 211-611-495	MISCELLANEOUS	GATORADE	2591/37	08/04/2016	08/08/2016		9.98
ATWOODS DISTRIBUTING LP	2016 211-611-495	MISCELLANEOUS	GATORADE	2598/37	08/06/2016	08/08/2016		19.16
ATWOODS DISTRIBUTING LP	2016 211-611-330	JANITORIAL SUPPL	ARMORALL, SOLVENT,	2598/37	08/06/2016	08/08/2016		18.76
ATWOODS DISTRIBUTING LP	2016 211-611-321	MAINTENANCE SUPP	JD MOWER - HITCH PI	2590/37	08/04/2016	08/08/2016		7.95
ATWOODS DISTRIBUTING LP	2016 211-611-321	MAINTENANCE SUPP	CABLE TIES, MOTOR O	2593/37	08/04/2016	08/08/2016		81.93
B & B WATER SUPPLY	2016 211-611-430	UTILITIES	4201 HWY 22 06/27/1	262 - JUL 20	08/03/2016	08/08/2016		99.40
BIG H TIRE SERVICE	2016 211-611-445	REPAIRS & MAINTEN	UNIT 007 - FLAT	161714	08/01/2016	08/08/2016		25.00
BIG H TIRE SERVICE	2016 211-611-445	REPAIRS & MAINTEN	UNIT 12 - FLAT, O'R	161597	08/05/2016	08/08/2016		60.00
CORSICANA NAPA AUTO PAR	2016 211-611-321	MAINTENANCE SUPP	WRENCH	059599	08/05/2016	08/08/2016		17.99
CORSICANA NAPA AUTO PAR	2016 211-611-321	MAINTENANCE SUPP	UNIT 10 - FUEL FILT	059547	08/05/2016	08/08/2016		24.71
GILFILLAN HARDWARE	2016 211-611-321	MAINTENANCE SUPP	JD MOWER - TAPE, SC	58726/1	08/05/2016	08/08/2016		56.47
HUFFMAN COMMUNICATIONS	2016 211-611-321	MAINTENANCE SUPP	UNIT 10 - MAGNET MO	46436	08/05/2016	08/08/2016		38.99
MARTIN MARIETTA MATERIA	2016 211-611-376	ROAD MATERIAL	NW0080	18077456	07/29/2016	08/08/2016		483.40
MARTIN MARIETTA MATERIA	2016 211-611-376	ROAD MATERIAL	NE1070, NE1030, NE1	18025671	08/01/2016	08/08/2016		1,803.32
MARTIN MARIETTA MATERIA	2016 211-611-376	ROAD MATERIAL	NW1360	18133359	08/03/2016	08/08/2016		1,577.70
MCCOY'S BUILDING SUPPLY	2016 211-611-375	CULVERTS	NW1360 - 24" X 24'	5906588	08/01/2016	08/08/2016	301931	375.99
MCCOY'S BUILDING SUPPLY	2016 211-611-375	CULVERTS	36" X 30' CULVERT	5906600	08/01/2016	08/08/2016	301931	715.00
MCCOY'S BUILDING SUPPLY	2016 211-611-321	MAINTENANCE SUPP	RATCHET STRAPS	5906600	08/01/2016	08/08/2016	301931	30.54
NAVARRO COUNTY ELECTRIC	2016 211-611-430	UTILITIES	13138301 - 4201 HWY	8301 - JUL 2	08/03/2016	08/08/2016		108.49
NAVARRO PIPE AND STEEL	2016 211-611-375	CULVERTS	NW1360 - 36" X 24'	449000	08/01/2016	08/08/2016	301921	705.60
O'REILLY AUTOMOTIVE STO	2016 211-611-321	MAINTENANCE SUPP	UNIT 15 - BATTERY	0763-412257	08/01/2016	08/08/2016	301909	125.79
PATHMARK TRAFFIC PRODUC	2016 211-611-322	SIGN SUPPLIES	18" X 6" GREEN 2-SI	018622	08/07/2016	08/08/2016	301808	178.00
PATHMARK TRAFFIC PRODUC	2016 211-611-322	SIGN SUPPLIES	YELLOW REFLECTORS	018622	08/07/2016	08/08/2016	301808	97.50
PATHMARK TRAFFIC PRODUC	2016 211-611-322	SIGN SUPPLIES	SIGN CLAMPS 2-SIDED	018622	08/07/2016	08/08/2016	301808	44.50
PATHMARK TRAFFIC PRODUC	2016 211-611-322	SIGN SUPPLIES	SIGN CLAMPS 1-SIDED	018622	08/07/2016	08/08/2016	301808	39.75
PATHMARK TRAFFIC PRODUC	2016 211-611-322	SIGN SUPPLIES	18" X 24" NO THRU T	018622	08/07/2016	08/08/2016	301808	54.60
REPUBLIC SERVICES #069	2016 211-611-430	UTILITIES	3-0069-0052829 - JU	0069-0008255	08/03/2016	08/08/2016		162.23
SMALL ENGINE SALES & SE	2016 211-611-321	MAINTENANCE SUPP	RECEPTACLE	173630	08/05/2016	08/08/2016		74.06
SMALL ENGINE SALES & SE	2016 211-611-321	MAINTENANCE SUPP	SHIPPING	173630	08/05/2016	08/08/2016		11.95
TOMMY MONTGOMERY SAND &	2016 211-611-376	ROAD MATERIAL	NE1040, NW1360, NW2	001811	08/01/2016	08/08/2016		9,372.88
TOMMY MONTGOMERY SAND &	2016 211-611-376	ROAD MATERIAL	NE1100, NE1040, NW1	001815	08/03/2016	08/08/2016		7,682.45
TRUCK PARTS & SERVICE I	2016 211-611-445	REPAIRS & MAINTEN	UNIT 309 - REPLACED	23650	08/01/2016	08/08/2016	301960	899.20
TRUCK PARTS & SERVICE I	2016 211-611-445	REPAIRS & MAINTEN	UNIT 35 - REPLACED	23506	08/01/2016	08/08/2016	301884	1,334.39
TRUCK PARTS & SERVICE I	2016 211-611-445	REPAIRS & MAINTEN	UNIT 35 - REPAIRED	23505	08/01/2016	08/08/2016	301884	403.53
WINTERS OIL COMPANY	2016 211-611-370	GAS & OIL	300 GAL GAS	543111	08/01/2016	08/08/2016	301976	548.34
WINTERS OIL COMPANY	2016 211-611-370	GAS & OIL	2000 GAL DIESEL	543111	08/01/2016	08/08/2016	301976	3,572.40

32,303.13

ALL RECORDS FROM 08/08/2016 TO 08/08/2016 DATE-TO-BE-PAID

VENDOR NAME	ACCOUNT #	ACCOUNT NAME	ITEM/REASON	INVOICE #	VP DATE	DATE TBP	PO NO	AMOUNT
AG POWER INC	2016 212-612-321	MAINTENANCE SUPP	UNIT 21T - FUEL FIL	2755322	08/01/2016	08/08/2016	301994	133.30
APAC TEXAS INC	2016 212-612-376	ROAD MATERIAL	SE3250, NE2120, SE3	200486068	08/03/2016	08/08/2016		11,865.16
APAC TEXAS INC	2016 212-612-376	ROAD MATERIAL	SE3150, SE3110	200499612	08/03/2016	08/08/2016		1,419.32
APAC TEXAS INC	2016 212-612-376	ROAD MATERIAL	NE3140	200496644	08/03/2016	08/08/2016		837.68
B & G AUTO PARTS	2016 212-612-321	MAINTENANCE SUPP	UNIT 202 - LOCK TIT	610515	08/01/2016	08/08/2016		9.00
B & G AUTO PARTS	2016 212-612-321	MAINTENANCE SUPP	UNIT 27 - FUEL FILT	610576	08/01/2016	08/08/2016		37.85
B & G AUTO PARTS	2016 212-612-321	MAINTENANCE SUPP	UNIT 29B - FUEL FIL	610611	08/01/2016	08/08/2016		23.25
BRUCKNER'S TRUCK SALES	2016 212-612-445	REPAIRS & MAINTEN	UNIT 216 - REPLACED	705089DS	08/01/2016	08/08/2016	301917	3,080.75
CITY OF KERENS	2016 212-612-430	UTILITIES	907 NW SECOND	1205 - JUL 2	08/03/2016	08/08/2016		59.20
CONSTRUCTION EDGE	2016 212-612-324	BLADES	JD MOWER - BLADES	3320	08/05/2016	08/08/2016	301981	790.00
CONSTRUCTION EDGE	2016 212-612-324	BLADES	MOTOR GRADER - BLAD	3320	08/05/2016	08/08/2016	301981	2,400.00
HOME DEPOT CREDIT SERVI	2016 212-612-376	ROAD MATERIAL	FEMA OCT - CONCRETE	5115969	08/01/2016	08/08/2016	301963	166.74
HOME DEPOT CREDIT SERVI	2016 212-612-376	ROAD MATERIAL	FEMA OCT - PALLET F	5115969	08/01/2016	08/08/2016	301963	15.00
I 45 TIRE & WRECKER SER	2016 212-612-445	REPAIRS & MAINTEN	UNIT 216 - TOWED	0032767	08/05/2016	08/08/2016		500.00
IJS COMPANY	2016 212-612-426	UNIFORMS	GLOVE-SPLIT COWHIDE	136245	08/05/2016	08/08/2016		15.00
IJS COMPANY	2016 212-612-330	JANITORIAL SUPPL	DISPENSER-SOAP 3.55	136217	08/05/2016	08/08/2016		8.00
IJS COMPANY	2016 212-612-330	JANITORIAL SUPPL	DISCOUNT	136217	08/05/2016	08/08/2016		8.00-
IJS COMPANY	2016 212-612-330	JANITORIAL SUPPL	SOAP-MAGIC 3.55L	136217	08/05/2016	08/08/2016		19.00
K & E HOSE & FITTINGS	2016 212-612-321	MAINTENANCE SUPP	UNIT 202 - HYDRAULI	9102	08/04/2016	08/08/2016	301972	39.29
KNIFE RIVER CORPORTATIO	2016 212-612-376	ROAD MATERIAL	SE4150, SE4100	534974	07/29/2016	08/08/2016		722.11
KNIFE RIVER CORPORTATIO	2016 212-612-376	ROAD MATERIAL	NE3090	534911	07/29/2016	08/08/2016		548.25
KNIFE RIVER CORPORTATIO	2016 212-612-376	ROAD MATERIAL	SE4040	535988	08/01/2016	08/08/2016		533.33
KNIFE RIVER CORPORTATIO	2016 212-612-376	ROAD MATERIAL	SE4040	535687	08/01/2016	08/08/2016		724.36
KNIFE RIVER CORPORTATIO	2016 212-612-376	ROAD MATERIAL	SE4100	535388	08/01/2016	08/08/2016		544.95
KNIFE RIVER CORPORTATIO	2016 212-612-376	ROAD MATERIAL	SE4040	536163	08/01/2016	08/08/2016		360.01
KNIFE RIVER CORPORTATIO	2016 212-612-376	ROAD MATERIAL	SE4100	535197	08/03/2016	08/08/2016		726.76
MARTIN MARIETTA MATERIA	2016 212-612-376	ROAD MATERIAL	NE2160, NE2120	18077459	08/01/2016	08/08/2016		1,227.95
MARTIN MARIETTA MATERIA	2016 212-612-376	ROAD MATERIAL	SE0210, NE2120, SE4	18025676	08/01/2016	08/08/2016		9,602.96
MARTIN MARIETTA MATERIA	2016 212-612-376	ROAD MATERIAL	SE4090, NE2120, SE4	18105660	08/01/2016	08/08/2016		2,663.10
MARTIN MARIETTA MATERIA	2016 212-612-376	ROAD MATERIAL	SE0210	18025731	08/05/2016	08/08/2016		1,958.34
MCCOY'S BUILDING SUPPLY	2016 212-612-376	ROAD MATERIAL	FEMA OCT - SE3060 C	5906936	08/01/2016	08/08/2016	302013	163.42
MCCOY'S BUILDING SUPPLY	2016 212-612-376	ROAD MATERIAL	FEMA OCT - SE3060 R	5906936	08/01/2016	08/08/2016	302013	7.27
MCCOY'S BUILDING SUPPLY	2016 212-612-376	ROAD MATERIAL	FEMA OCT - CONCRETE	5906691	08/04/2016	08/08/2016	301954	155.99
MCCOY'S BUILDING SUPPLY	2016 212-612-376	ROAD MATERIAL	FEMA OCT - PALLET F	5906691	08/04/2016	08/08/2016	301954	20.00
MCCOY'S BUILDING SUPPLY	2016 212-612-376	ROAD MATERIAL	FEMA OCT - 6' T-POS	5906691	08/04/2016	08/08/2016	301954	17.83
MCCOY'S BUILDING SUPPLY	2016 212-612-376	ROAD MATERIAL	FEMA OCT - CONCRETE	5906713	08/04/2016	08/08/2016	301959	311.98
MCCOY'S BUILDING SUPPLY	2016 212-612-376	ROAD MATERIAL	CREDIT	5906722	08/04/2016	08/08/2016	301959	155.99-
MCCOY'S BUILDING SUPPLY	2016 212-612-376	ROAD MATERIAL	FEMA OCT - CONCRETE	5906719	08/04/2016	08/08/2016	301959	155.99
MCCOY'S BUILDING SUPPLY	2016 212-612-376	ROAD MATERIAL	FEMA OCT - SE3060 P	5906878	08/05/2016	08/08/2016	301997	40.00
MCCOY'S BUILDING SUPPLY	2016 212-612-376	ROAD MATERIAL	FEMA OCT - SE3060 C	5906878	08/05/2016	08/08/2016	301997	326.84
MCCOY'S BUILDING SUPPLY	2016 212-612-376	ROAD MATERIAL	FEMA OCT - SE3060 C	5906914	08/05/2016	08/08/2016	301997	490.27
O'REILLY AUTOMOTIVE STO	2016 212-612-321	MAINTENANCE SUPP	UNIT 28 - BLOWER MO	0763-413479	08/01/2016	08/08/2016	301941	141.85
PHILLIPS TIRE	2016 212-612-325	TIRES	UNIT 226 - 235/75R1	249	08/05/2016	08/08/2016		92.00
PHILLIPS TIRE	2016 212-612-325	TIRES	UNIT 226 - 235/75R1	251	08/05/2016	08/08/2016		92.00
PHILLIPS TIRE	2016 212-612-445	REPAIRS & MAINTEN	UNIT 214 - MOUNTED	248	08/05/2016	08/08/2016		30.00
PHILLIPS TIRE	2016 212-612-445	REPAIRS & MAINTEN	UNIT 214 - MOUNTED	250	08/05/2016	08/08/2016		30.00
RDO EQUIPMENT	2016 212-612-321	MAINTENANCE SUPP	UNIT 202 - DRIVE SH	P83989	08/01/2016	08/08/2016	301948	374.51
RDO EQUIPMENT	2016 212-612-321	MAINTENANCE SUPP	SHIPPING	P83989	08/01/2016	08/08/2016	301948	25.00
TIM'S TIRES & WHEELS	2016 212-612-445	REPAIRS & MAINTEN	UNIT 27 - INSPECTIO	059705	08/05/2016	08/08/2016		7.00
TIMCO BLASTING & COATIN	2016 212-612-376	ROAD MATERIAL	SE4100, SE4040	016326	08/01/2016	08/08/2016		5,200.88
UNITED RENTALS INC - TX	2016 212-612-448	MACHINE HIRE	FEMA OCT - NE2160 R	138826583-00	08/07/2016	08/08/2016		599.96

49,149.46

ALL RECORDS FROM 08/08/2016 TO 08/08/2016 DATE-TO-BE-PAID

VENDOR NAME	ACCOUNT #	ACCOUNT NAME	ITEM/REASON	INVOICE #	VP DATE	DATE TBP	PO NO	AMOUNT
B & J TRASH SERVICE	2016 213-613-430	UTILITIES	RICHLAND BARN	JUL 2016	08/01/2016	08/08/2016		25.00
BIG H TIRE SERVICE	2016 213-613-445	REPAIRS & MAINTENANCE	UNIT 304 - FLAT, MO	161738	08/05/2016	08/08/2016	301977	303.40
CITY OF DAWSON	2016 213-613-430	UTILITIES	17500 FM 709	324 - JUL 20	08/03/2016	08/08/2016		38.50
CORSICANA NAPA AUTO PAR	2016 213-613-321	MAINTENANCE SUPP	1 GAL ROTELLA OIL	059687	08/01/2016	08/08/2016	301939	491.76
CORSICANA NAPA AUTO PAR	2016 213-613-321	MAINTENANCE SUPP	OIL FILTER	059687	08/01/2016	08/08/2016	301939	52.20
CORSICANA NAPA AUTO PAR	2016 213-613-321	MAINTENANCE SUPP	REFRIGERANT	059687	08/01/2016	08/08/2016	301939	7.10
CORSICANA NAPA AUTO PAR	2016 213-613-321	MAINTENANCE SUPP	BLASTER	059687	08/01/2016	08/08/2016	301939	5.40
GEXA ENERGY - HOUSTON	2016 213-613-430	UTILITIES	17500 FM 709 06/09/	21523233-4	07/29/2016	08/08/2016		148.22
GEXA ENERGY - HOUSTON	2016 213-613-430	UTILITIES	17500 FM 709 GRDL 0	21523233-4	07/29/2016	08/08/2016		20.74
GEXA ENERGY - HOUSTON	2016 213-613-430	UTILITIES	17500 FM 709 GRDL 2	21523233-4	07/29/2016	08/08/2016		9.48
JOHNSON OIL COMPANY	2016 213-613-370	GAS & OIL	500 GAL GAS	18342	08/07/2016	08/08/2016	302015	830.50
JOHNSON OIL COMPANY	2016 213-613-370	GAS & OIL	2300 GAL DIESEL	18342	08/07/2016	08/08/2016	302015	3,790.40
NORTHEAST TEXAS WATER S	2016 213-613-430	UTILITIES	00300419 07/01/16 - AUG 2016		08/04/2016	08/08/2016		35.83
O'REILLY AUTOMOTIVE STO	2016 213-613-321	MAINTENANCE SUPP	UNIT 316 - FUEL FIL	0763-413469	08/05/2016	08/08/2016	301940	38.84
O'REILLY AUTOMOTIVE STO	2016 213-613-321	MAINTENANCE SUPP	UNIT 315 - FUEL FIL	0763-413469	08/05/2016	08/08/2016	301940	75.52
O'REILLY AUTOMOTIVE STO	2016 213-613-321	MAINTENANCE SUPP	UNIT 316 - OIL FILT	0763-413469	08/05/2016	08/08/2016	301940	21.16
O'REILLY AUTOMOTIVE STO	2016 213-613-321	MAINTENANCE SUPP	UNIT 315 - OIL FILT	0763-413469	08/05/2016	08/08/2016	301940	21.16
PURVIS BEARING SERVICE	2016 213-613-321	MAINTENANCE SUPP	BRUSH CUTTER - CHAI	7145522	08/01/2016	08/08/2016	301916	31.47
TIM'S TIRES & WHEELS	2016 213-613-445	REPAIRS & MAINTENANCE	UNIT 335 - FLAT	060643	08/01/2016	08/08/2016		25.00
TRUCK PARTS & SERVICE I	2016 213-613-321	MAINTENANCE SUPP	UNIT 335 - CB ANTEH	23587	08/05/2016	08/08/2016		27.21
VERTEX MACHINE COMPANY	2016 213-613-445	REPAIRS & MAINTENANCE	UNIT 303 - REPAIRED	842	08/04/2016	08/08/2016		125.00
WINTERS OIL COMPANY	2016 213-613-321	MAINTENANCE SUPP	ROTELLA OIL	542817	08/01/2016	08/08/2016	301907	124.20
WINTERS OIL COMPANY	2016 213-613-321	MAINTENANCE SUPP	GREASE	542817	08/01/2016	08/08/2016	301907	28.80

6,276.89

ALL RECORDS FROM 08/09/2016 TO 08/09/2016 DATE-TO-BE-PAID

VENDOR NAME	ACCOUNT #	ACCOUNT NAME	ITEM/REASON	INVOICE #	VP DATE	DATE TBP	PO NO	AMOUNT
KNIFE RIVER CORPORTATIO	2016 213-613-376	ROAD MATERIAL	FEMA JUN - SW2386	535198	07/28/2016	08/09/2016		2,312.65
KNIFE RIVER CORPORTATIO	2016 213-613-376	ROAD MATERIAL	FEMA JUN - SW2310	535199	07/28/2016	08/09/2016		2,649.56
KNIFE RIVER CORPORTATIO	2016 213-613-376	ROAD MATERIAL	FEMA JUN - SW2400	535989	07/28/2016	08/09/2016		1,357.66
KNIFE RIVER CORPORTATIO	2016 213-613-376	ROAD MATERIAL	FEMA JUN - SW4030	535992	07/28/2016	08/09/2016		526.66
KNIFE RIVER CORPORTATIO	2016 213-613-376	ROAD MATERIAL	FEMA JUN - SW0030	535990	07/28/2016	08/09/2016		3,516.28
KNIFE RIVER CORPORTATIO	2016 213-613-376	ROAD MATERIAL	FEMA JUN - SW4070	535391	07/28/2016	08/09/2016		3,962.15
KNIFE RIVER CORPORTATIO	2016 213-613-376	ROAD MATERIAL	FEMA JUN - SW2386,	535389	07/28/2016	08/09/2016		2,341.60
KNIFE RIVER CORPORTATIO	2016 213-613-376	ROAD MATERIAL	FEMA JUN - SW4300,	535392	07/28/2016	08/09/2016		1,077.54
KNIFE RIVER CORPORTATIO	2016 213-613-376	ROAD MATERIAL	FEMA JUN - SW2310	535390	07/28/2016	08/09/2016		4,093.64
KNIFE RIVER CORPORTATIO	2016 213-613-376	ROAD MATERIAL	FEMA JUN - SW2310,	535689	07/28/2016	08/09/2016		4,055.82
KNIFE RIVER CORPORTATIO	2016 213-613-376	ROAD MATERIAL	FEMA JUN - SW4070	535690	07/28/2016	08/09/2016		3,528.73
KNIFE RIVER CORPORTATIO	2016 213-613-376	ROAD MATERIAL	FEMA JUN - DAWSON Y	534978	07/28/2016	08/09/2016		180.83
KNIFE RIVER CORPORTATIO	2016 213-613-376	ROAD MATERIAL	FEMA JUN - SW2386,	534975	07/28/2016	08/09/2016		1,945.45
KNIFE RIVER CORPORTATIO	2016 213-613-376	ROAD MATERIAL	FEMA JUN - SW2310,	534976	07/28/2016	08/09/2016		1,479.69
KNIFE RIVER CORPORTATIO	2016 213-613-376	ROAD MATERIAL	FEMA JUN - SW4120,	534977	07/28/2016	08/09/2016		1,940.65
KNIFE RIVER CORPORTATIO	2016 213-613-376	ROAD MATERIAL	FEMA JUN - SW2310,	534979	07/28/2016	08/09/2016		377.41
KNIFE RIVER CORPORTATIO	2016 213-613-376	ROAD MATERIAL	FEMA JUN - SW2310	534913	07/28/2016	08/09/2016		2,632.16
KNIFE RIVER CORPORTATIO	2016 213-613-376	ROAD MATERIAL	FEMA JUN - SW4120,	534914	07/28/2016	08/09/2016		2,304.24
KNIFE RIVER CORPORTATIO	2016 213-613-376	ROAD MATERIAL	FEMA JUN - SW4120	535200	07/28/2016	08/09/2016		2,323.83
KNIFE RIVER CORPORTATIO	2016 213-613-376	ROAD MATERIAL	FEMA JUN - SW2400,	535688	07/28/2016	08/09/2016		3,087.64
KNIFE RIVER CORPORTATIO	2016 213-613-376	ROAD MATERIAL	FEMA JUN - SW4270,	535201	07/28/2016	08/09/2016		721.06
KNIFE RIVER CORPORTATIO	2016 213-613-376	ROAD MATERIAL	FEMA JUN - DAWSON Y	534915	07/28/2016	08/09/2016		545.79
KNIFE RIVER CORPORTATIO	2016 213-613-376	ROAD MATERIAL	FEMA JUN - SW2386	534912	07/28/2016	08/09/2016		2,305.54
KNIFE RIVER CORPORTATIO	2016 213-613-376	ROAD MATERIAL	FEMA JUN - SW2230,	536618	08/01/2016	08/09/2016		9,247.69
KNIFE RIVER CORPORTATIO	2016 213-613-376	ROAD MATERIAL	FEMA JUN - SW0030	536399	08/01/2016	08/09/2016		3,507.94
KNIFE RIVER CORPORTATIO	2016 213-613-376	ROAD MATERIAL	FEMA JUN - SW4170	536400	08/01/2016	08/09/2016		4,138.71
KNIFE RIVER CORPORTATIO	2016 213-613-376	ROAD MATERIAL	FEMA JUN - SW2400,	536398	08/01/2016	08/09/2016		2,770.77
KNIFE RIVER CORPORTATIO	2016 213-613-376	ROAD MATERIAL	FEMA JUN - DAWSON Y	536167	08/01/2016	08/09/2016		176.78
KNIFE RIVER CORPORTATIO	2016 213-613-376	ROAD MATERIAL	FEMA JUN - SW0030	536165	08/01/2016	08/09/2016		2,345.89
KNIFE RIVER CORPORTATIO	2016 213-613-376	ROAD MATERIAL	FEMA JUN - SW4160,	536166	08/01/2016	08/09/2016		4,181.68
KNIFE RIVER CORPORTATIO	2016 213-613-376	ROAD MATERIAL	FEMA JUN - DAWSON Y	536168	08/01/2016	08/09/2016		582.08
KNIFE RIVER CORPORTATIO	2016 213-613-376	ROAD MATERIAL	FEMA JUN - SW4070,	535991	07/28/2016	08/09/2016		4,123.40
KNIFE RIVER CORPORTATIO	2016 213-613-376	ROAD MATERIAL	FEMA JUN - SW4040	535691	07/28/2016	08/09/2016		355.95
KNIFE RIVER CORPORTATIO	2016 213-613-376	ROAD MATERIAL	FEMA JUN - SW2404	536164	08/05/2016	08/09/2016		2,800.24
KNIFE RIVER CORPORTATIO	2016 213-613-376	ROAD MATERIAL	FEMA JUN - SW2250,	536401	08/05/2016	08/09/2016		959.71
MARTIN MARIETTA MATERIA	2016 213-613-376	ROAD MATERIAL	FEMA JUN - SE1080,	18025698	07/28/2016	08/09/2016		16,025.46
MARTIN MARIETTA MATERIA	2016 213-613-376	ROAD MATERIAL	FEMA JUN - SE1080,	18025665	07/28/2016	08/09/2016		3,272.30
MARTIN MARIETTA MATERIA	2016 213-613-376	ROAD MATERIAL	FEMA JUN - SE2040,	18105663	07/28/2016	08/09/2016		6,428.66
MARTIN MARIETTA MATERIA	2016 213-613-376	ROAD MATERIAL	FEMA JUN - SE2040	18105674	07/28/2016	08/09/2016		409.22
MARTIN MARIETTA MATERIA	2016 213-613-376	ROAD MATERIAL	FEMA JUN - SW2350,	18077465	07/28/2016	08/09/2016		1,061.29
MARTIN MARIETTA MATERIA	2016 213-613-376	ROAD MATERIAL	FEMA JUN - SW0025,	18133367	08/02/2016	08/09/2016		2,339.99
MARTIN MARIETTA MATERIA	2016 213-613-376	ROAD MATERIAL	FEMA JUN - SW0040	18163481	08/02/2016	08/09/2016		870.34
MARTIN MARIETTA MATERIA	2016 213-613-376	ROAD MATERIAL	FEMA JUN - SW2340,	18163470	08/02/2016	08/09/2016		1,362.95
TOMMY MONTGOMERY SAND &	2016 213-613-376	ROAD MATERIAL	FEMA JUN - SW2310,	001814	07/28/2016	08/09/2016		63,016.30
TOMMY MONTGOMERY SAND &	2016 213-613-376	ROAD MATERIAL	FEMA JUN - SW0030,	001818	08/01/2016	08/09/2016		28,565.63
TOMMY MONTGOMERY SAND &	2016 213-613-376	ROAD MATERIAL	FEMA JUN - SW4170,	001817	08/01/2016	08/09/2016		32,158.40

								239,967.96
TOTAL PAYABLES								239,967.96

ALL RECORDS FROM 08/08/2016 TO 08/08/2016 DATE-TO-BE-PAID

VENDOR NAME	ACCOUNT #	ACCOUNT NAME	ITEM/REASON	INVOICE #	VP DATE	DATE TBP	PO NO	AMOUNT
ARNOLD CRUSHED STONE	2016 214-614-376	ROAD MATERIAL	FEMA OCT - NW2140,	232293	08/03/2016	08/08/2016		890.61
ARNOLD CRUSHED STONE	2016 214-614-376	ROAD MATERIAL	FEMA OCT - NW4160,	232263	08/03/2016	08/08/2016		249.83
CITY OF BLOOMING GROVE	2016 214-614-430	UTILITIES	EAST SECOND STREET	0002 - JUL 2	08/03/2016	08/08/2016		213.26
GEXA ENERGY - HOUSTON	2016 214-614-430	UTILITIES	104 2ND ST BARN 06/	21538207-4	08/03/2016	08/08/2016		43.02
GEXA ENERGY - HOUSTON	2016 214-614-430	UTILITIES	104 2ND ST GRDL 06/	21538207-4	08/03/2016	08/08/2016		11.03
GILFILLAN HARDWARE	2016 214-614-495	MISCELLANEOUS	ELBOW, VALVE, GARDE	58583/1	07/29/2016	08/08/2016		34.97
KNIFE RIVER CORPORTATIO	2016 214-614-376	ROAD MATERIAL	FEMA OCT - SW3090	534916	07/29/2016	08/08/2016		739.88
KNIFE RIVER CORPORTATIO	2016 214-614-376	ROAD MATERIAL	FEMA OCT - SW3100	534980	07/29/2016	08/08/2016		717.91
KNIFE RIVER CORPORTATIO	2016 214-614-376	ROAD MATERIAL	FEMA OCT - SW3100	535993	08/03/2016	08/08/2016		736.58
KNIFE RIVER CORPORTATIO	2016 214-614-376	ROAD MATERIAL	FEMA OCT - SW3100	535393	08/03/2016	08/08/2016		736.29
KNIFE RIVER CORPORTATIO	2016 214-614-376	ROAD MATERIAL	FEMA OCT - SW3100	535692	08/03/2016	08/08/2016		735.83
KNIFE RIVER CORPORTATIO	2016 214-614-376	ROAD MATERIAL	FEMA OCT - SW3100	535197	08/03/2016	08/08/2016		184.20
KNIFE RIVER CORPORTATIO	2016 214-614-376	ROAD MATERIAL	FEMA OCT - SW3100	536169	08/03/2016	08/08/2016		542.56
KNIFE RIVER CORPORTATIO	2016 214-614-376	ROAD MATERIAL	FEMA OCT - SW3100	535202	08/03/2016	08/08/2016		540.01
KNIFE RIVER CORPORTATIO	2016 214-614-376	ROAD MATERIAL	FEMA OCT - SW3100	536402	08/05/2016	08/08/2016		734.93
KNIFE RIVER CORPORTATIO	2016 214-614-376	ROAD MATERIAL	FEMA OCT - SW3100,	536619	08/05/2016	08/08/2016		544.13
KNIFE RIVER CORPORTATIO	2016 214-614-376	ROAD MATERIAL	FEMA OCT - SW3100,	536781	08/05/2016	08/08/2016		923.87
TIMCO BLASTING & COATIN	2016 214-614-376	ROAD MATERIAL	FEMA OCT - SW3100,	016325	08/03/2016	08/08/2016		12,117.55
TOMMY MONTGOMERY SAND &	2016 214-614-376	ROAD MATERIAL	FEMA OCT - NW2140,	001816	08/03/2016	08/08/2016		17,879.18
WILLIAMS GIN & GRAIN CO	2016 214-614-321	MAINTENANCE SUPP	1999 DODGE - STARTE	340229	08/03/2016	08/08/2016		5.95
WINDSTREAM	2016 214-614-435	TELEPHONE	125287122 07/19/16	7122 - JUL 2	07/29/2016	08/08/2016		55.75
WINTERS OIL COMPANY	2016 214-614-370	GAS & OIL	500 GAL DIESEL	542959	08/05/2016	08/08/2016	301943	903.15
WINTERS OIL COMPANY	2016 214-614-370	GAS & OIL	ROTELLA OIL	543130	08/05/2016	08/08/2016	301979	559.85
WINTERS OIL COMPANY	2016 214-614-370	GAS & OIL	OIL DRUM	543130	08/05/2016	08/08/2016	301979	788.40

								40,878.74

ALL RECORDS FROM 08/08/2016 TO 08/08/2016 DATE-TO-BE-PAID

VENDOR NAME	ACCOUNT #	ACCOUNT NAME	ITEM/REASON	INVOICE #	VP DATE	DATE TBP	PO NO	AMOUNT
AMARILLO POLICE DEPARTM	2016 318-533-120	OVERTIME	MINCHER, RANDY	13.5 JUN 2016	07/29/2016	08/08/2016		570.25
ATMOS ENERGY	2016 318-516-418	FACILITIES	3027278267	06/18/16 JUL 2016	08/03/2016	08/08/2016		46.77
CARROLLTON POLICE DEPT	2016 318-526-120	OVERTIME	PUTMAN, TRAVIS	85.5 APR - JUL	07/29/2016	08/08/2016		4,574.25
CIRCLE E ENTERPRISES IN	2016 318-516-411	SERVICES	RELOCATED OFFICE	FU 70221	08/07/2016	08/08/2016	301880	573.50
CITY OF ARLINGTON	2016 318-523-120	OVERTIME	BALI, MICHAEL	18.5 MAY 2016	07/29/2016	08/08/2016		999.17
CITY OF RICHARDSON POLI	2016 318-526-120	OVERTIME	SHAW JR, ROBERT L	3 JUN 2016	07/29/2016	08/08/2016		2,131.29
DANNIE PATRICK CAUBLE	2016 318-520-411	SERVICES	07/01/16 - 07/31/16	2016-7	08/04/2016	08/08/2016		2,400.40
FEDEX - TXMAS	2016 318-516-411	SERVICES	2934-0047-4	5-487-48141	07/29/2016	08/08/2016		62.99
FEDEX - TXMAS	2016 318-516-411	SERVICES	2934-0047-4	5-494-89998	08/03/2016	08/08/2016		126.66
GEKA ENERGY - HOUSTON	2016 318-516-418	FACILITIES	8404 ESTERS BLVD	06 21565516-4	07/29/2016	08/08/2016		3,321.00
MORENO SUPPLY INC	2016 318-516-418	FACILITIES	BULBS	49969	08/01/2016	08/08/2016	301863	310.50
OFFICE DEPOT INC-TXMAS	2016 318-525-310	SUPPLIES	PURELL WIPES	849661581001	08/02/2016	08/08/2016	301935	43.08
OFFICE DEPOT INC-TXMAS	2016 318-525-310	SUPPLIES	BATTERY BACKUP	848422724001	08/07/2016	08/08/2016	301902	66.49
OFFICE DEPOT INC-TXMAS	2016 318-525-310	SUPPLIES	CANNED AIR, CLOROX	847822046001	08/07/2016	08/08/2016	301902	10.50
OFFICE DEPOT INC-TXMAS	2016 318-524-310	SUPPLIES	LABELS, LETTER TRAY	849230196001	08/07/2016	08/08/2016	301913	104.00
REPUBLIC SERVICES #794	2016 318-516-418	FACILITIES	8404 ESTERS BLVD -	0794-0112473	08/05/2016	08/08/2016		243.23
SOLID BORDER	2016 318-516-411	SERVICES	SPAM FIREWALL	400 0 760832	08/07/2016	08/08/2016	302011	1,277.00
SOLID BORDER	2016 318-516-411	SERVICES	SPAM FIREWALL	400 0 760832	08/07/2016	08/08/2016	302011	809.00
SOLID BORDER	2016 318-516-411	SERVICES	NG FIREWALL	280 09/ 760831	08/07/2016	08/08/2016	302012	425.00
SOLID BORDER	2016 318-516-411	SERVICES	NG FIREWALL	280 09/ 760831	08/07/2016	08/08/2016	302012	425.00
SOLID BORDER	2016 318-516-411	SERVICES	NG FIREWALL	280 09/ 760831	08/07/2016	08/08/2016	302012	425.00
SOLID BORDER	2016 318-516-411	SERVICES	NG FIREWALL	280 09/ 760831	08/07/2016	08/08/2016	302012	425.00
SOLID BORDER	2016 318-516-411	SERVICES	NG FIREWALL	280 09/ 760831	08/07/2016	08/08/2016	302012	425.00
SOLID BORDER	2016 318-516-411	SERVICES	NG FIREWALL	280 09/ 760831	08/07/2016	08/08/2016	302012	425.00
WILLIS OF FLORIDA INC	2016 318-515-411	SERVICES	PUBLIC OFFICIALS	07 1492515	08/03/2016	08/08/2016		3,250.38

								23,470.46

ALL RECORDS FROM 08/08/2016 TO 08/08/2016 DATE-TO-BE-PAID

VENDOR NAME	ACCOUNT #	ACCOUNT NAME	ITEM/REASON	INVOICE #	VP DATE	DATE TBP PO NO	AMOUNT
OMNI PROFESSIONAL SERVI	2016 319-516-412	SERVICES	07/16/16 - 07/31/16 2016-14		07/29/2016	08/08/2016	3,774.08
RUTH ASTON	2016 319-517-412	SERVICES	07/16/16 - 07/31/16 2016-14		07/29/2016	08/08/2016	2,699.63
SUMPTER SERVICES LLC	2016 319-515-412	SERVICES	07/16/16 - 07/31/16 2016-14		07/29/2016	08/08/2016	7,790.40

							14,264.11

3625

ALL RECORDS FROM 08/08/2016 TO 08/08/2016 DATE-TO-BE-PAID

VENDOR NAME	ACCOUNT #	ACCOUNT NAME	ITEM/REASON	INVOICE #	VP DATE	DATE TBP	PO NO	AMOUNT
BANK OF NEW YORK MELLON	2016 601-680-651	INTEREST - SERIE	NAVARROG014	AUG 2016	08/06/2016	08/08/2016		134,032.50

								134,032.50

**NAVARRO COUNTY, TEXAS
BUDGET TRANSFER**

ACCOUNT	ACCOUNT DESCRIPTION	AMOUNT
101-406-409	APPRAISAL DISTRICT	4,000.00
101-406-410	PROFESSIONAL SERVICES	10,000.00
101-406-416	INTERNET & E-MAIL	4,550.00
101-406-417	INSURANCE	(20,950.00)
101-406-465	FIRE PROTECTION	2,400.00
101-406-485	NORTHSTAR	(8,500.00)
101-406-573	CAPITAL LEASE PRINCIPAL	(30,000.00)
101-406-574	CAPITAL LEASE INTEREST	(5,000.00)
101-410-110	SECURITY GUARDS	29,345.71
101-410-120	OVERTIME	515.29
101-410-201	SOCIAL SECURITY (FICA)	1,830.00
101-410-202	MEDICARE	423.00
101-410-203	RETIREMENT	3,108.00
101-410-204	HEALTH INSURANCE	7,515.00
101-410-205	UNEMPLOYMENT	45.00
101-410-206	WORKERS COMPENSATION	718.00
101-410-321	MAINTENANCE SUPPLIES	(6.58)
101-410-335	YARD MAINTENANCE SUPPLIES	6.58
101-410-430	UTILITIES	(8,000.00)
101-410-435	TELEPHONE	(635.49)
101-410-436	INTERNET	635.49
101-410-445	REPAIRS & MAINTENANCE	(1,000.00)
101-410-450	MAINT CONTRACT - MECHANICAL	(6,205.80)
101-410-454	MAINT CONTRACT - YARD	(2,400.00)
101-410-458	MAINT CONTRACT - DISPENSERS	(495.84)
101-410-459	MAINT CONTRACT - CLEANING	(3,960.00)
101-411-430	UTILITIES	8,000.00
101-411-445	REPAIRS & MAINTENANCE	1,000.00
101-411-450	MAINT CONTRACT - MECHANICAL	6,205.80
101-411-454	MAINT CONTRACT - YARD	2,400.00
101-411-458	MAINT CONTRACT - DISPENSERS	495.84
101-411-459	MAINT CONTRACT - CLEANING	3,960.00
TOTAL BUDGET ADJUSTMENT		0.00

**NAVARRO COUNTY, TEXAS
BUDGET TRANSFER**

ACCOUNT	ACCOUNT DESCRIPTION	AMOUNT
101-403-417	BONDS	32.50
101-403-445	REPAIRS & MAINTENANCE	(32.50)
101-406-311	POSTAGE	(7,921.80)
101-406-314	PROPERTY TAX STATEMENTS	7,921.80
101-407-312	COMPUTER SUPPLIES	4,100.00
101-407-320	OPERATING EQUIPMENT	(4,100.00)
101-421-102	EXTENSION AGENTS	31,096.00
101-421-103	DEPUTIES / ASSISTANTS	(31,096.00)
101-421-310	OFFICE SUPPLIES	(1,230.00)
101-421-311	POSTAGE	(395.00)
101-421-419	DUES & SUBSCRIPTIONS	30.00
101-421-428	TRAVEL	1,200.00
101-421-429	CONFERENCE/TRAINING	395.00
101-425-310	OFFICE SUPPLIES	(423.50)
101-425-410	INTERPRETER	1,180.00
101-425-411	COURT APPOINTED AT	(2,000.00)
101-425-413	VISITING JUDGES	716.69
101-425-419	DUES & PUBLICATION	423.50
101-425-470	MEDICAL EXAMINATION	(1,896.69)
101-425-490	MENTAL / AD LITEM	2,000.00
101-430-103	COURT COORDINATOR	(59,345.00)
101-430-104	COURT REPORTER	59,345.00
101-430-310	OFFICE SUPPLIES	(350.89)
101-430-411	COURT APPOINTED AT	(4,878.20)
101-430-428	TRAVEL/CONFERENCE/	1,360.02
101-430-475	INVESTIGATORS	3,430.70
101-430-490	MENTAL / AD LITEM	1,447.50
101-430-495	MISCELLANEOUS	(1,009.13)
TOTAL BUDGET ADJUSTMENT		0.00

**NAVARRO COUNTY, TEXAS
BUDGET TRANSFER**

ACCOUNT	ACCOUNT DESCRIPTION	AMOUNT
101-435-103	COURT COORDINATOR	(60,047.00)
101-435-104	COURT REPORTER	60,047.00
101-435-411	COURT APPOINTED AT	(27,000.00)
101-435-412	TRANSCRIPTS	5,159.25
101-435-459	COMPUTER MAINTENAN	701.25
101-435-480	EXPERT WITNESSES	(3,000.00)
101-435-490	MENTAL / AD LITEM	27,000.00
101-435-495	MISCELLANEOUS	(2,860.50)
101-440-310	OFFICE SUPPLIES	(560.50)
101-440-417	BONDS	30.50
101-440-452	JURY SYSTEM SOFTWA	530.00
101-456-310	OFFICE SUPPLIES	(850.00)
101-456-410	INTERPRETER	550.00
101-456-414	PETIT JURORS	300.00
101-457-419	DUES & SUBSCRIPTIO	200.00
101-457-428	TRAVEL/CONFERENCE/	(200.00)
101-458-419	DUES & SUBSCRIPTIO	153.94
101-458-445	REPAIRS & MAINTENA	(153.94)
101-459-412	COURT REPORTER	(100.00)
101-459-414	PETIT JURORS	300.00
101-459-419	DUES & SUBSCRIPTIO	300.00
101-459-428	TRAVEL/CONFERENCE/	(500.00)
101-475-103	DEPUTIES / ASSISTA	(367,218.00)
101-475-105	ASSISTANT DISTRICT	364,720.75
101-475-114	PART-TIME HELP	2,497.25
101-475-310	OFFICE SUPPLIES	711.04
101-475-320	OPERATING EQUIPMEN	810.89
101-475-410	PROFESSIONAL SERVI	(10,763.00)
101-475-418	ADVERTISING & LEGA	300.00
101-475-419	DUES & SUBSCRIPTIO	(300.00)
101-475-435	CVC - TELEPHONE	2,500.00
101-475-436	INTERNET	1,823.88
101-475-446	COMPUTER MAINTENAN	4,917.19
TOTAL BUDGET ADJUSTMENT		0.00

3630

**NAVARRO COUNTY, TEXAS
BUDGET TRANSFER**

ACCOUNT	ACCOUNT DESCRIPTION	AMOUNT
101-495-445	REPAIRS & MAINTENA	309.00
101-495-459	MAINT CONTRACT - C	(309.00)
101-497-310	OFFICE SUPPLIES	(199.00)
101-497-417	BONDS	14.00
101-497-419	DUES & SUBSCRIPTIO	185.00
101-499-310	OFFICE SUPPLIES	(85.00)
101-499-419	DUES & SUBSCRIPTIO	85.00
101-512-312	FORMS & PRINTING	(150.00)
101-512-320	OPERATING EQUIPMEN	(3,500.00)
101-512-335	RADIOS	3,500.00
101-512-419	DUES & SUBSCRIPTIO	1,032.50
101-512-435	UTILITIES	(1,685.50)
101-512-440	COPIER RENTAL	828.00
101-512-450	MAINT CONTRACT - M	(828.00)
101-512-452	MAINT CONTRACT - E	5,353.02
101-512-455	MAINT CONTRACT - A	803.00
101-512-465	EXTRADITION OF PRI	(2,981.74)
101-512-470	INMATE PRESCRIPTIO	(10,274.27)
101-512-471	INMATE PHYSICIAN S	9,902.99
101-512-474	INMATE MEDICAL SUP	(2,000.00)
101-554-312	OPERATING SUPPLIES	(35.00)
101-554-419	DUES & SUBSCRIPTIO	35.00
101-560-310	OFFICE SUPPLIES	(142.00)
101-560-370	GAS & OIL	(12,742.50)
101-560-419	DUES & SUBSCRIPTIO	1,054.50
101-560-426	UNIFORMS	5,740.00
101-560-430	DATA MODEM SERVICE	(450.00)
101-560-436	INTERNET	450.00
101-560-575	MACHINERY & EQUIPM	6,090.00
101-561-435	TELEPHONE - UVERSE	(683.91)
101-561-436	INTERNET	683.91
TOTAL BUDGET ADJUSTMENT		0.00

3631

**NAVARRO COUNTY, TEXAS
BUDGET TRANSFER**

ACCOUNT	ACCOUNT DESCRIPTION	AMOUNT
101-566-310	OFFICE SUPPLIES	351.92
101-566-495	MISCELLANEOUS	(351.92)
101-568-320	OPERATING SUPPLIES	(227.88)
101-568-435	TELEPHONE - UVERSE	(1,356.01)
101-568-436	INTERNET	1,583.89
101-568-455	MAINT CONTRACT - C	283.75
101-568-495	MISCELLANEOUS	(283.75)
TOTAL BUDGET ADJUSTMENT		0.00

101-380-403	COUNTY CLERK - REC	55,000.00
101-380-404	DISTRICT CLERK - R	35,000.00
101-380-408	COMMUNITY GRANTS	714,507.00
101-380-421	CO CLERK ARCHIVE F	65,000.00
101-380-422	JP TECHNOLOGY FEES	20,054.00
101-401-320	OPERATING EQUIPMEN	(7,400.00)
101-403-420	RECORDS MGT EXPEND	(55,000.00)
101-403-421	RECORDS ARCHIVE EX	(65,000.00)
101-403-575	MACHINERY & EQUIPM	(10,000.00)
101-406-422	JP TECHNOLOGY FUND	(20,054.00)
101-410-446	COURTHOUSE RESTORA	(574,830.00)
101-440-320	OPERATING EQUIPMEN	(16,700.00)
101-440-420	RECORDS MGT EXPEND	(35,000.00)
101-456-420	SECURITY FUND EXPE	(5,000.00)
101-457-420	SECURITY FUND EXPE	(5,000.00)
101-458-420	SECURITY FUND EXPE	(5,000.00)
101-459-420	SECURITY FUND EXPE	(5,000.00)
101-475-320	OPERATING EQUIPMEN	(2,000.00)
101-512-103	DEPUTIES / ASSISTA	(70,000.00)
101-512-201	SOCIAL SECURITY (F	(4,340.00)
101-512-202	MEDICARE	(1,015.00)
101-512-203	RETIREMENT	(7,476.00)
101-512-204	HEALTH INSURANCE	(20,114.00)
TOTAL BUDGET ADJUSTMENT		(19,368.00)

3632

**NAVARRO COUNTY, TEXAS
BUDGET TRANSFER**

ACCOUNT	ACCOUNT DESCRIPTION	AMOUNT
211-611-103	DEPUTIES / ASSISTANTS / ADMIN	(5,000.00)
211-611-120	OVERTIME	5,513.42
211-611-125	LONGEVITY	(200.00)
211-611-204	HEALTH INSURANCE	(313.42)
211-611-325	TIRES	10,000.00
211-611-375	CULVERTS	3,776.92
211-611-376	ROAD MATERIAL	(6,776.92)
211-611-417	INSURANCE/BONDS/PERMITS	75.00
211-611-445	REPAIRS & MAINTENANCE	(7,037.50)
211-611-495	MISCELLANEOUS	(37.50)
TOTAL BUDGET ADJUSTMENT		0.00

212-612-103	DEPUTIES / ASSISTANTS / ADMIN	(2,000.00)
212-612-114	PART-TIME HELP	(4,856.59)
212-612-120	OVERTIME	6,856.59
212-612-322	SIGN SUPPLIES	1,000.00
212-612-330	JANITORIAL SUPPLIES	100.00
212-612-417	INSURANCE/BONDS/PERMITS	37.50
212-612-574	CAPITAL LEASE INTEREST	(1,137.50)
TOTAL BUDGET ADJUSTMENT		0.00

**NAVARRO COUNTY, TEXAS
BUDGET TRANSFER**

ACCOUNT	ACCOUNT DESCRIPTION	AMOUNT
213-613-103	DEPUTIES / ASSISTANTS / ADMIN	(10,000.00)
213-613-114	PART-TIME HELP	10,000.00
213-613-320	OPERATING EQUIPMENT	(14,000.00)
213-613-370	GAS & OIL	(20,056.64)
213-613-375	CULVERTS	40,051.42
213-613-376	ROAD MATERIAL	46,628.22
213-613-377	BRIDGE MATERIAL	(16,623.00)
213-613-417	INSURANCE/BONDS/PERMITS	37.50
213-613-447	CONTRACTOR BRIDGE REPAIRS	(6,000.00)
213-613-449	CONTRACTOR ROAD REPAIRS	(30,000.00)
213-613-494	EMPLOYEE PHYSICAL	69.50
213-613-573	CAPITAL LEASE PRINCIPAL	799.37
213-613-574	CAPITAL LEASE INTEREST	(906.37)
TOTAL BUDGET ADJUSTMENT		0.00

214-614-103	DEPUTIES / ASSISTANTS / ADMIN	(7,027.38)
214-614-120	OVERTIME	7,027.38
214-614-375	CULVERTS	30,000.00
214-614-417	INSURANCE/BONDS/PERMITS	37.50
214-614-447	CONTRACTOR BRIDGE	(30,000.00)
214-614-448	MACHINE HIRE	250.00
214-614-495	MISCELLANEOUS	(287.50)
TOTAL BUDGET ADJUSTMENT		0.00

#8

3634

ORDER OF GENERAL ELECTION

An election is hereby ordered to be held on November 8, 2016, in Navarro County, Texas, for the purpose of electing the following county and precinct officers as required by Article XVI, Section 65 of the Texas Constitution.

(Por la presente se ordena que se lleve a cabo una eleccion el dia noviembre de 8, 2016, en el Condado de Navarro, Texas con el proposito de elegir los siguientes oficiales del condado y del precinto como requerido por el Articulo XVI, Seccion 65, de la Constitucion de Texas.)

13th District Judge, County Court at Law, Sheriff, Tax Assessor/ Collector, Commissioner Precinct 1, Commissioner Precinct 3, Constable Precinct 1, Constable Precinct 2, Constable Precinct 3, Constable Precinct 4

Early voting by personal appearance will be conducted starting October 24, 2016 and ending on November 4, 2016 Monday through Friday 8:00 a.m. to 5:00 p.m., Saturday, October 29, 2016 7:00 a.m. to 7:00 p.m. and Sunday, October 30, 2016 12:00 p.m. to 5:00 p.m. at the Navarro County Courthouse Annex, 601 N 13th Ave Corsicana TX.

(La votación anticipada en persona se llevará a cabo a partir del 24 de octubre de 2016 y termina el 4 de noviembre, el año 2016 de lunes a viernes de 8:00 am a 5:00 pm, sábado, 29 de octubre de el año 2016 las 7:00 am a 7:00 pm y el domingo 30 de octubre, el año 2016 12:00-5:00 en la Corte del Condado de Navarro anexo, 601 N 13th Ave Corsicana TX.)

Applications for ballot by mail shall be mailed or emailed to:

(Las aplicaciones para votar por correo serán enviadas por correo o por correo electrónico a :)

Danda Parker
Elections Administrator
P.O. Box 1018
Corsicana, TX 75151
dparker@navarrocounty.org

Applications for ballot by mail must be received no later than the close of business on October 28, 2016.

Las aplicaciones para votar por correo deben ser recibidas a más tardar al cierre de las operaciones el 28 de octubre de 2016.

Issued this the 8th day of August, 2016.

(Emitada este dia 8 de Agosto, 2016)

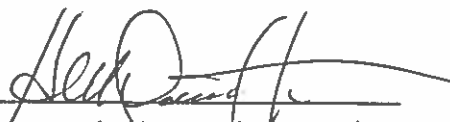

H.M. Davenport, Jr, Navarro County Judge

NAVARRO COUNTY

3685



GAIL SMITH, PCC
ASSESSOR AND COLLECTOR OF TAXES

PHONE (903) 654-3080
FAX (903) 875-3327

NAVARRO COUNTY TAX ASSESSOR AND COLLECTOR
P. O. BOX 1070
CORSICANA, TEXAS 75151-1070
E-mail: gsmith@navarrocounty.org

July 25, 2016

TO: Navarro County, General Fund

FROM: Gail Smith, PCC
Navarro County Tax Assessor & Collector

You should have already received a copy of the certification of the 2016 Appraisal Roll from the Navarro Central Appraisal District. Please provide your 2016 tax resolutions or ordinances as soon as possible, stating your tax rate, exceptions, and/or discounts.

	<u>2015</u>	<u>2016</u>
Total Market Value	\$ 4,464,613,953	4,707,183,007
Total Assessed Value	\$ 3,500,650,408	3,589,960,829
Total Taxable Value	\$ 2,992,965,379	3,044,557,807
Total Value of New Property	\$ 27,780,050	38,434,964
Anticipated Collection Rate	100%	100%
Number of Accounts	47,952	48,469

DEFINITIONS: "Appraised value" means the value determined as provided by Chapter 23 of the Tax Code according to category. "Assessed value" means for the purposes of assessment of property for taxation, the amount determined by multiplying the appraised value by the applicable assessment ratio, but, for the purposes of determining the debt limitation imposed by Article III, Section 52 of the Texas Constitution, shall mean the market value of the property recorded by the Chief Appraiser. "Taxable value" means the amount determined by deducting from the assessed value the amount of any applicable partial exemption.

NAVARRO COUNTY



GAIL SMITH, PCC
ASSESSOR AND COLLECTOR OF TAXES

PHONE (903) 654-3080
FAX (903) 875-3327

NAVARRO COUNTY TAX ASSESSOR AND COLLECTOR
P. O. BOX 1070
CORSICANA, TEXAS 75151-1070
E-mail: gsmith@navarrocounty.org

July 25, 2016

TO: Navarro County, Road & Bridge

FROM: Gail Smith, PCC
Navarro County Tax Assessor & Collector

You should have already received a copy of the certification of the 2016 Appraisal Roll from the Navarro Central Appraisal District. Please provide your 2016 tax resolutions or ordinances as soon as possible, stating your tax rate, exceptions, and/or discounts.

		<u>2015</u>	<u>2016</u>
Total Market Value	\$	4,464,613,953	4,707,181,007
Total Assessed Value	\$	3,500,650,408	3,589,958,829
Total Taxable Value	\$	2,994,142,529	3,046,067,327
Total Value of New Property	\$	27,780,050	38,773,094
Anticipated Collection Rate		100%	100%
Number of Accounts		47,952	48,468

DEFINITIONS: "Appraised value" means the value determined as provided by Chapter 23 of the Tax Code according to category. "Assessed value" means for the purposes of assessment of property for taxation, the amount determined by multiplying the appraised value by the applicable assessment ratio, but, for the purposes of determining the debt limitation imposed by Article III, Section 52 of the Texas Constitution, shall mean the market value of the property recorded by the Chief Appraiser. "Taxable value" means the amount determined by deducting from the assessed value the amount of any applicable partial exemption.

NAVARRO COUNTY



GAIL SMITH, PCC
ASSESSOR AND COLLECTOR OF TAXES

PHONE (903) 654-3080
FAX (903) 875-3327

NAVARRO COUNTY TAX ASSESSOR AND COLLECTOR
P. O. BOX 1070
CORSICANA, TEXAS 75151-1070
E-mail: gsmith@navarrocounty.org

July 25, 2016

TO: Navarro County, Flood Control

FROM: Gail Smith, PCC
Navarro County Tax Assessor & Collector

You should have already received a copy of the certification of the 2016 Appraisal Roll from the Navarro Central Appraisal District. Please provide your 2016 tax resolutions or ordinances as soon as possible, stating your tax rate, exceptions, and/or discounts.

	<u>2015</u>	<u>2016</u>
Total Market Value	\$ 4,464,613,953	4,707,183,007
Total Assessed Value	\$ 3,500,650,408	3,589,960,829
Total Taxable Value	\$ 3,019,162,943	3,066,403,829
Total Value of New Property	\$ 27,763,661	38,715,146
Anticipated Collection Rate	100%	100%
Number of Accounts	47,952	48,469

DEFINITIONS: "Appraised value" means the value determined as provided by Chapter 23 of the Tax Code according to category. "Assessed value" means for the purposes of assessment of property for taxation, the amount determined by multiplying the appraised value by the applicable assessment ratio, but, for the purposes of determining the debt limitation imposed by Article III, Section 52 of the Texas Constitution, shall mean the market value of the property recorded by the Chief Appraiser. "Taxable value" means the amount determined by deducting from the assessed value the amount of any applicable partial exemption.

3638 #10

Navarro County
April 30, 2016
2016 Monthly Financial Report

	Budget	April	YTD
General Fund:			
Revenues			
Property Taxes	14,407,000.00	309,428.05	13,675,977.75
Other	5,780,297.00	405,911.04	3,046,276.00
Total Revenues	20,187,297.00	715,339.09	16,722,253.75
Expenditures			
Commissioner's Court	98,189.00	7,782.22	52,438.25
Planning & Development	263,085.00	20,444.68	141,501.79
County Clerk	667,194.00	27,356.94	286,546.07
Veterans' Service	23,768.00	1,838.37	13,375.62
Non Departmental	2,359,820.00	178,538.52	1,234,270.52
Information Systems	169,185.00	12,538.08	94,842.99
HAVA	18,500.00	0.00	0.00
Elections	247,069.00	19,505.72	217,912.68
Courthouse	1,276,221.36	8,355.32	270,619.40
Annex	22,061.64	4,740.42	8,661.42
Historical Commission	7,000.00	0.00	0.00
Extension	238,318.00	24,521.51	135,002.30
County Judge	316,194.00	23,356.07	182,462.67
County Court-at-Law	774,141.00	54,021.30	353,751.04
District Court	606,530.00	60,839.88	357,858.28
District Clerk	564,949.00	34,194.55	294,161.45
JP Pct 1	217,270.00	10,910.25	133,158.70
JP Pct 2	213,598.00	10,173.43	126,276.13
JP Pct 3	209,561.00	10,098.56	123,055.06
JP Pct 4	215,580.00	10,096.78	128,559.02
District Attorney	1,015,916.00	79,174.18	566,260.11
Law Library	6,924.00	1,005.99	3,047.46
County Auditor	507,976.00	35,948.66	261,408.72
County Treasurer	169,540.00	12,529.72	98,564.35
Tax Assessor/Collector	566,880.00	41,202.32	298,595.05
County Jail	5,470,113.00	395,826.65	2,963,761.27
Constable Pct 1	46,701.00	3,258.88	23,021.34
Constable Pct 2	47,952.00	3,747.39	25,671.74
Constable Pct 3	46,749.00	5,008.21	26,751.98
Constable Pct 4	44,210.00	113.46	8,101.31
County Sheriff	3,898,736.00	474,942.65	2,194,960.21
Sheriff Communications	856,898.00	79,282.98	471,362.01
Highway Patrol	103,159.00	7,932.08	63,459.61
License & Weights	3,400.00	407.92	932.92
Emergency Management	70,600.00	1,209.58	30,625.57
CSCD	8,878.00	749.18	5,244.26
Juvenile	108,936.00	8,663.02	58,705.20
Indigent Health Care	500,000.00	0.00	500,000.00
Total Expenses	21,981,802.00	1,670,315.47	11,754,926.50
General Net	(1,794,505.00)	(954,976.38)	5,112,197.24

3659

Navarro County
April 30, 2016
2016 Monthly Financial Report

	Budget	April	YTD
Flood Control:			
Revenues			
Property Taxes	269,500.00	5,606.39	253,306.74
Other	5,000.00	463.87	2,955.79
Total Revenues	274,500.00	6,070.26	256,262.53
Expenditures			
Flood Control Net	(133,500.00)	718.55	204,231.82
Debt Service:			
Revenues			
Property Taxes	581,000.00	12,606.56	557,179.76
Other	700.00	175.36	637.23
Total Revenues	581,700.00	12,781.92	557,816.99
Expenditures			
Debt Service Net	0.00	0.00	393,750.00
Road & Bridge Pct. 1:			
Revenues			
Property Taxes	784,000.00	16,721.99	741,695.56
State of TX	581,950.70	0.00	10,796.42
Vehicle Registration	215,000.00	14,787.27	154,369.26
Fines & Forfeitures	105,000.00	0.00	22,368.34
Other	1,500.00	256.23	1,942.64
Total Revenues	1,687,450.70	31,765.49	931,172.22
Expenditures			
Personnel	480,015.00	40,025.98	282,417.45
Supplies	494,500.00	23,960.86	421,534.12
Other Services & Charges	154,040.00	4,938.25	59,043.06
Capital Outlay	102,345.00	8,265.44	61,009.41
Total Expenses	1,230,900.00	77,190.53	824,004.04
Road & Bridge Pct. 1 Net	456,550.70	(45,425.04)	107,168.18
Road & Bridge Pct. 2:			
Revenues			
Property Taxes	784,000.00	16,721.99	741,695.55
State of TX	449,480.80	122,407.77	133,204.18
Vehicle Registration	215,000.00	14,787.27	153,376.46
Fines & Forfeitures	105,000.00	0.00	22,368.34
Other	2,000.00	214.01	958.73
Total Revenues	1,555,480.80	154,131.04	1,051,603.26
Expenditures			
Personnel	563,711.00	44,678.46	338,016.85
Supplies	470,000.00	33,684.05	299,766.25
Other Services & Charges	211,500.00	51,569.03	110,674.25
Capital Outlay	152,365.00	9,095.64	49,266.18
Total Expenses	1,397,576.00	139,027.18	797,723.53
Road & Bridge Pct. 2 Net	157,904.80	15,103.86	253,879.73

3640

Navarro County
April 30, 2016
2016 Monthly Financial Report

	Budget	April	YTD
Road & Bridge Pct. 3:			
Revenues			
Property Taxes	784,000.00	16,721.99	741,695.50
State of TX	529,047.00	13,175.83	23,972.24
Vehicle Registration	215,000.00	14,787.27	154,369.26
Fines & Forfeitures	105,000.00	0.00	22,368.34
Other	2,000.00	157.39	658.79
Total Revenues	1,635,047.00	44,842.48	943,064.13
Expenditures			
Personnel	599,588.00	45,595.47	328,613.53
Supplies	436,623.00	11,790.69	398,983.30
Other Services & Charges	155,800.00	6,199.02	58,749.77
Capital Outlay	45,127.00	0.00	41,249.22
Total Expenses	1,237,138.00	63,585.18	827,595.82
Road & Bridge Pct. 3 Net	397,909.00	(18,742.70)	115,468.31
Road & Bridge Pct. 4:			
Revenues			
Property Taxes	784,000.00	16,721.99	741,695.54
State of TX	762,652.87	0.00	10,796.41
Vehicle Registration	215,000.00	14,787.27	154,369.29
Fines & Forfeitures	105,000.00	0.00	22,368.34
Other	3,000.00	120.76	934.81
Total Revenues	1,869,652.87	31,630.02	930,164.39
Expenditures			
Personnel	556,385.00	37,978.66	271,954.34
Supplies	795,000.00	151,734.48	845,254.96
Other Services & Charges	151,400.00	6,709.56	66,363.20
Capital Outlay	98,732.00	4,060.97	28,426.79
Total Expenses	1,601,517.00	200,483.67	1,211,999.29
Road & Bridge Pct. 4 Net	268,135.87	(168,853.65)	(281,834.90)
Capital Projects:			
Revenues			
State of TX	0.00	711,306.35	711,306.35
Other	0.00	35.22	920.88
Total Revenues	0.00	711,341.57	712,227.23
Expenditures			
Supplies	0.00	0.00	0.00
Other Services & Charges	0.00	104,046.31	422,237.23
Capital Outlay	0.00	76,538.60	1,805,982.01
Total Expenses	0.00	180,584.91	2,228,219.24
Capital Projects Net	0.00	530,756.66	(1,515,992.01)

Navarro County
Combined Indebtedness
For the Month Ending 04/30/16

3641

Description	Due To	Beginning Balance 10/01/15	New Additions	April Payment	YTD Payments	Ending Balance 04/30/16
2014 General Obligation Bond	Citibank	7,500,000.00	0.00	0.00	255,000.00	7,245,000.00
Netcom Recorder NCSO Dispatch	Government Capital	10,793.97	0.00	10,793.97	10,793.97	0.00
Total General Fund		7,510,793.97	0.00	10,793.97	265,793.97	7,245,000.00
Motorgrader, Truck Trailer	Prosperity Bank	171,188.14	0.00	3,213.49	25,485.36	145,702.78
2012 Cat Motorgrader	Welch State Bank	95,071.25	0.00	2,146.29	17,014.16	78,057.09
2010 Motorgrader	Caterpillar Financial Services	3,150.77	0.00	0.00	3,150.77	0.00
John Deere Tractor/Mower	Prosperity Bank	117,348.75	0.00	2,119.02	16,816.30	100,532.45
Total Road & Bridge Pct. 1		386,758.91	0.00	7,478.80	62,466.59	324,292.32
2013 Motorgrader	Welch State Bank	101,992.68	0.00	3,262.54	25,875.82	76,116.86
2012 Cat Motorgrader	Welch State Bank	78,135.81	0.00	3,122.39	21,692.14	56,443.67
John Deere Tractor/Mower	Welch State Bank	0.00	133,652.00	2,062.39	2,062.39	131,589.61
Total Road & Bridge Pct. 2		180,128.49	133,652.00	8,447.32	49,630.35	264,150.14
2006 Trail King Trailer	Welch State Bank	29,073.70	0.00	0.00	14,342.95	14,730.75
2015 Peterbilt Dump Truck	First National Bank	0.00	130,247.00	10,044.90	10,044.90	120,202.10
2015 Mack Truck	First National Bank	0.00	130,497.00	14,754.52	14,754.52	115,742.48
Total Road & Bridge Pct. 3		29,073.70	260,744.00	24,799.42	39,142.37	250,675.33
Tractors and Mowers	Prosperity Bank	143,249.69	0.00	3,768.83	29,889.66	113,360.03
Total Road & Bridge Pct. 4		143,249.69	0.00	3,768.83	29,889.66	113,360.03
General Fund		7,245,000.00				
Road & Bridge Pct. 1		324,292.32				
Road & Bridge Pct. 2		264,150.14				
Road & Bridge Pct. 3		250,675.33				
Road & Bridge Pct. 4		113,360.03				
Total O/S Debt For All Funds		8,197,477.82				

#12

3642

Salvage Unused and Damaged Furniture at Ideal Storage

81 Assorted Chairs

18 Assorted Desk

23 Various Sized Filing Cabinets

1 Couch

8 Old Metal Trash Cans

#13

3643



Change Order Proposal

ARCHITECT:

1113 Architects, Inc.
1506 South Elm Street
Georgetown, TX 78626

Project: Navarro County Courthouse

Proposal Number: 072 -

Date of Issuance: 8-3-16

Date of Contract: 12-23-13

Owner: Navarro County
300 West 3rd Ave
Corsicana, TX 75110

Architect Project No. NAV-1009

Contractor Proj. No. 13-1352

This is not a change order or a directive to proceed with the work described in the proposed modifications.

DESCRIPTION:

Add deadbolt to door of Evidence Room #219 (county requested)

Schlage 600 series 2-key deadbolt and cylinders:	\$ 375.20
Mortice door and jamb:	\$ 63.75
IC cores & key work:	\$ 31.63
Re-finish/touch up	\$ 20.75
Subtotal:	\$ 491.33
Phoenix I OH&P:	\$ <u>73.70</u>
Total Proposal Amount:	\$ <u>565.03</u>

Approved by 1113: _____ Date: _____

 Approved by Navarro County: _____ Date: 8-8-16

#14

3644



Change Order Proposal

ARCHITECT:
1113 Architects, Inc.
1506 South Elm Street
Georgetown, TX 78626

Project: Navarro County Courthouse

Proposal Number: 073

Date of Issuance: 8-3-16

Date of Contract: 12-23-13

Owner: Navarro County
300 West 3rd Ave
Corsicana, TX 75110

Architect Project No. NAV-1009

Contractor Proj. No. 13-1352

This is not a change order or a directive to proceed with the work described in the proposed modifications.

DESCRIPTION:

Add ceiling mount light fixture in Restroom B18 (county Requested):
(see attached Electrical quote)

Install fixture, bulbs and wire in conduit: \$ 516.00

Subtotal: \$ 516.00

Phoenix I OH&P: \$ 77.40

Total Proposal Amount: \$ 593.40

Approved By 1113: Date:

 8-8-16

Approved By Navarro County: Date:

Phoenix I Restoration and Construction, Ltd.

14032 Distribution Way, Farmer's Branch, TX 75234 • 214 902 0111 • 214-904-9635 (Fax)



Madden Electric Services Inc.

DATE: 7/12/16

Attention DAVE MCCLUNG

Reference: **EXTRA A2 FIXTURE IN RESTROOM**

We are pleased to offer our Proposal for performing the electrical subcontract work associated with the above referenced project. **\$516.00**

We have included the following:

- 1. INSTALL 1 A2 FIXTURE IN RESTROOM
- 2. USE EXISTING CIRCUIT
- 3. Electrical identification
- 4. Testing as per the Specifications.
- 5. MC Cable to be used where allowed by NEC Code

We have excluded the following:

- 1. Sales Tax
- 2. Utility company fees
- 3. Line voltage interlock wiring
- 4. Control and conduit systems work associated with division 15
- 5. Misc. starters and VFD'S furnished by division 15
- 6. Purchase and installation of the following systems:
 - a. Fire Alarm
 - b. Telephone and Data
 - c. TV
 - d. Sound/PA
 - e. Security
- 7. Formed Concrete (Housekeeping Pads, Transformer Pads, Pole Bases, Etc.)
- 8. Concrete encasement for underground conduits
- 9. Rock excavation, trenching and removal
- 10. Off-Site Dirt / spoilage removal
- 11. Roof penetrations and pitch-pans
- 12. Irrigation sleeves
- 13. Flammable Liquid Permit

9870 North Poetry Lane, Terrell, Texas 75160
 Metro (214) 221-0151.....Phone/Fax (972) 524-4449
 HUB #1752658076000 / WBE #WFWB62897N0317 / TECL #25060
www.maddenelectricalservicesinc.com

14. Access Panels and Doors
15. Cutting, patching, and removal of material necessary to install electrical work
16. Barricades, fencing and signage
17. Existing code violations
18. Wood blocking for wall mounted equipment
19. Relocation and Removal of hidden/unknown electrical conditions
20. Special Pads, pavers and membrane strips for Lightning Protection
21. Integrity of existing electrical equipment and their associated circuits
22. Painting of electrical equipment

The following clarifications pertain to this proposal.

1. Pricing based on the following:
 - a. Pricing good for 30 days due to material price fluctuations
 - b. Madden Electric proposal to be part of contract documents.

Respectfully Submitted,

Madden Electrical Services, Incorporated

John Madden

V.P. Madden Electric Services Inc.

#15

3647



Change Order Proposal

ARCHITECT:
1113 Architects, Inc.
1506 South Elm Street
Georgetown, TX 78626

Project: Navarro County Courthouse

Proposal Number: 074

Date of Issuance: 8-3-16

Date of Contract: 12-23-13

Owner: Navarro County
300 West 3rd Ave
Corsicana, TX 75110

Architect Project No. NAV-1009

Contractor Proj. No. 13-1352

This is not a change order or a directive to proceed with the work described in the proposed modifications.

DESCRIPTION:

Added Laser Smoke Detector for Rotunda area 1st to 3rd floors (per Fire Marshall):
(see attached Texas Fire Alarm Estimate)

Equipment, labor and materials to Install:	\$ 1672.56
Masonry penetration and conduit:	\$ 85.00
Scaffold rental for access:	\$ <u>75.00</u>

Subtotal:	\$ 1832.56
Phoenix I OH&P:	\$ <u>274.88</u>

Total Proposal Amount: **\$ 2107.44**

Approved By 1113: _____ Date: _____

Approved By Navarro County: _____ Date: 8-8-16

Phoenix I Restoration and Construction, Ltd.

14032 Distribution Way, Farmer's Branch, TX 75234 • 214-902-0111 • 214-904-9635 (Fax)

3648

REC'D IN
E-MAIL
12-9-11 PG 1 OF 3

DW



ESTIMATE

Estimate # 20142-R1
Date: 8/13/2014

Project: Navarro County Courthouse
Address: 300 W 3rd St
Corsicana, Texas

Customer: Phoenix I
14032 Distribution Way
Farmers Branch, Texas 75234

From: Robert Worthington
robert.worthington@tfatexasfirealarm.com

Phone: 214-902-0111 Fax: 214-904-9635

Attn: Dale Sellers
Email: dsellers@phoenix1.org

TFA TEXAS FIRE ALARM, INC. will provide the following equipment with associated labor:

- 1 IDP-BEAM-T: Addressable Beam Smoke Detector W / Test Feature (For Atrium)
- Lot FPLP Wire - 18/2, 16/2, 14/2 AWG
- Lot Rough Materials - Boxes, Tie Wraps, Clamps Etc. Associated with Project
- Lot Plans, Design, Submittals, Review, Permit w/Assoc City Fee & Closeouts
- Lot Fire Alarm Pre-Testing & Final Testing with AHJ - After Hours if required
- Lot Programming of System for Peripheral Devices

We are pleased to offer these services for a total price of:
**Pricing is based on exclusions & conditions listed below on PG 2*

\$	<u>685.56</u>	Labor
	<u>987.00</u>	Material
	<u>-81.11</u>	Tax On Material
	<u>1,754.00</u>	Total

REMOVE ?

1672.56

P O Box 148
Wills Point, Tx 75169
972.289.8600
972.289.8601 (fax)
matthew.woods@tfatexasfirealarm.com
ACR 1973 - SCR 0825

#16

3649



Change Order Proposal

ARCHITECT:

1113 Architects, Inc.
 1506 South Elm Street
 Georgetown, TX 78626

Project: Navarro County Courthouse

Proposal Number: 075

Date of Issuance: 8-3-16

Date of Contract: 12-23-13

Owner: Navarro County
 300 West 3rd Ave
 Corsicana, TX 75110

Architect Project No. NAV-1009

Contractor Proj. No. 13-1352

This is not a change order or a directive to proceed with the work described in the proposed modifications.

DESCRIPTION:

Add (4) roller shades to interior restroom windows (county requested):

Four roller shades (see attached invoice)	\$ 525.00
Equipment, labor and materials to install:	<u>\$ 85.00</u>

Subtotal:	\$ 610.00
Phoenix I OH&P:	<u>\$ 91.50</u>

Total Proposal Amount:	<u>\$ 701.50</u>
-------------------------------	-------------------------

 Approved By 1113: Date:

 Approved By Navarro County: Date: 8-8-16

17

3650



Change Order Proposal

ARCHITECT:
1113 Architects, Inc.
1506 South Elm Street
Georgetown, TX 78626

Project: Navarro County Courthouse

Proposal Number: 076

Date of Issuance: 8-3-16

Date of Contract: 12-23-13

Owner: Navarro County
300 West 3rd Ave
Corsicana, TX 75110

Architect Project No. NAV-1009

Contractor Proj. No. 13-1352

This is not a change order or a directive to proceed with the work described in the proposed modifications.

DESCRIPTION:

Repair Cast Iron stair banisters at second floor landing:

Custom casting work: (see Invoice)	\$ 4,280.40
(4) oval bars	
(2) straight bars	
(2) machined pieces	
Custom work materials:	\$ 142.00
Drill, tap/thread/paint black	
Crating & Shipping:	\$ 158.62
 Equipment, labor and materials to Install:	 <u>\$ 425.00</u>
 Subtotal:	 \$ 5,006.02
Phoenix I OH&P:	<u>\$ 750.90</u>
 Total Proposal Amount:	 <u><u>\$ 5,756.92</u></u>

Approved By 1113: _____ Date: _____

 8-8-16
Approved By Navarro County: _____ Date: _____

3651



Invoice

Customer PO	Date	Invoice #
	6/23/2016	C-4821

Bill To
Dale Sellers Phoenix I Restoration 14032 Distribution Way Farmers Branch TX 75234

Ship To
Phoenix I Restoration 14032 Distribution Way Farmers Branch TX 75234

Due Date	Terms
6/23/2016	ON RECEIPT

Item	Description	Qty	Rate	Amount
Custom work	Four (4) cast railing pieces: (1) one piece ½"x1"x 27.25" length (1) one piece ½"x1"x 25.25" (4) four pieces oval bar 25.25" length (2) machined pieces 1.5" diameter All painted black	35.67	120.00	4,280.40
Custom work	Materials		142.00	142.00
Shipping	Crating and shipping charges		158.62	158.62
Thank you for your business			Total	\$4,581.02 ✓

Customer Service 918-592-1700 (Office Hours 8-5 CST)

3652



#19

3653



Change Order Proposal

ARCHITECT:

1113 Architects, Inc.
1506 South Elm Street
Georgetown, TX 78626

Project: Navarro County Courthouse

Proposal Number: 078

Date of Issuance: 8-3-16

Date of Contract: 12-23-13

Owner: Navarro County
300 West 3rd Ave
Corsicana, TX 75110

Architect Project No. NAV-1009

Contractor Proj. No. 13-1352

This is not a change order or a directive to proceed with the work described in the proposed modifications.

DESCRIPTION:

Paint all stair approach hands rails on site (county requested):

Labor to prep, prime and paint (52 hours @ 42.50): \$ 2,210.00

Equipment and materials: \$ 125.00

Subtotal: \$ 2,335.00

Phoenix I OH&P: \$ 350.25

Total Proposal Amount: \$ 2,685.25

Approved By 1113: _____ Date: _____

 8-8-16
Approved By Navarro County: _____ Date: _____

Phoenix I Restoration and Construction, Ltd.

14032 Distribution Way, Farmer's Branch, TX 75234 • 214-902-0111 • 214-904-9635 (Fax)

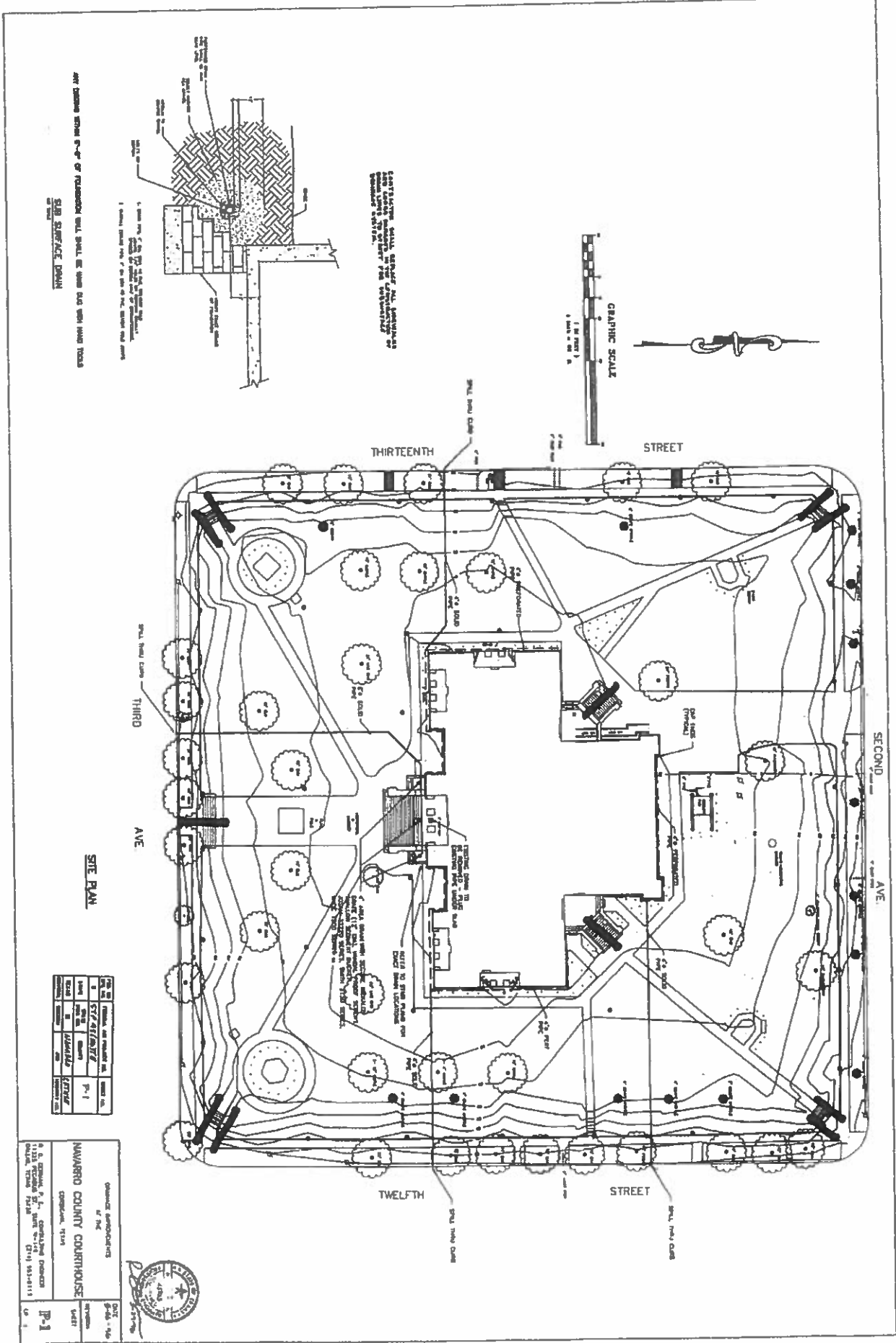

ANY OTHERS SHALL BE OF FURNISHING SHALL BE MADE AND WITH HAND TOOLS
 SUB SURFACE DRAWN

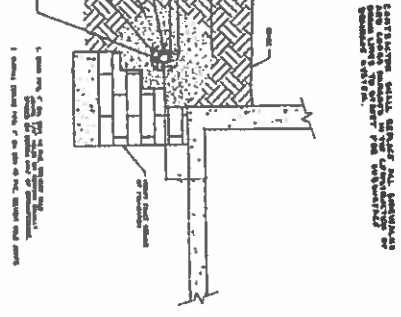

SITE PLAN

NO.	DESCRIPTION	DATE
1	SYNOPSIS	1/1/57
2	PLAN	1/1/57
3	ELEVATION	1/1/57
4	SECTION	1/1/57
5	DETAILS	1/1/57

GEORGE J. BROWN, ARCHITECT
 1010 RECORD BLDG., SUITE 101
 DALLAS, TEXAS 75202
 NAVARRO COUNTY COURTHOUSE
 COMPLETION, 1957
 P-1
 1/1/57



#20

3655



Change Order Proposal

ARCHITECT:
1113 Architects, Inc.
1506 South Elm Street
Georgetown, TX 78626

Project: Navarro County Courthouse

Proposal Number: 079

Date of Issuance: 8-3-16

Date of Contract: 12-23-13

Owner: Navarro County
300 West 3rd Ave
Corsicana, TX 75110

Architect Project No. NAV-1009

Contractor Proj. No. 13-1352

This is not a change order or a directive to proceed with the work described in the proposed modifications.

DESCRIPTION:

Repair oak casing, jamb and trim at main entry doors (storm damaged):

Demo and investigation (2 hours at 42.50):	\$ 85.00
Lumber materials:	\$ 100.00
Mobilization, travel, equipment:	\$ 170.00
Labor to cut, sand and install new wood (4 hours @ 42.50):	\$ 170.00
Re-install crown, putty, sand, caulk and finish:	<u>\$ 127.50</u>

Subtotal: \$ 652.50

Phoenix I OH&P: \$ 97.88

Total Proposal Amount: \$ 750.38

Approved By 1113: Date:

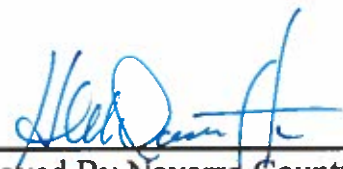
 8-8-16
Approved By Navarro County: Date: