

# Cooke County

## Texas

# Construction Plans for Remote Parking Lot



**Judge Steve Starnes**

County Judge

**Gary Hollowell**

Precinct 1 Commissioner

**Jason Snuggs**

Precinct 2 Commissioner

**Adam Arendt**

Precinct 3 Commissioner

**Leon Klement**

Precinct 4 Commissioner

**PROJECT LOCATION**

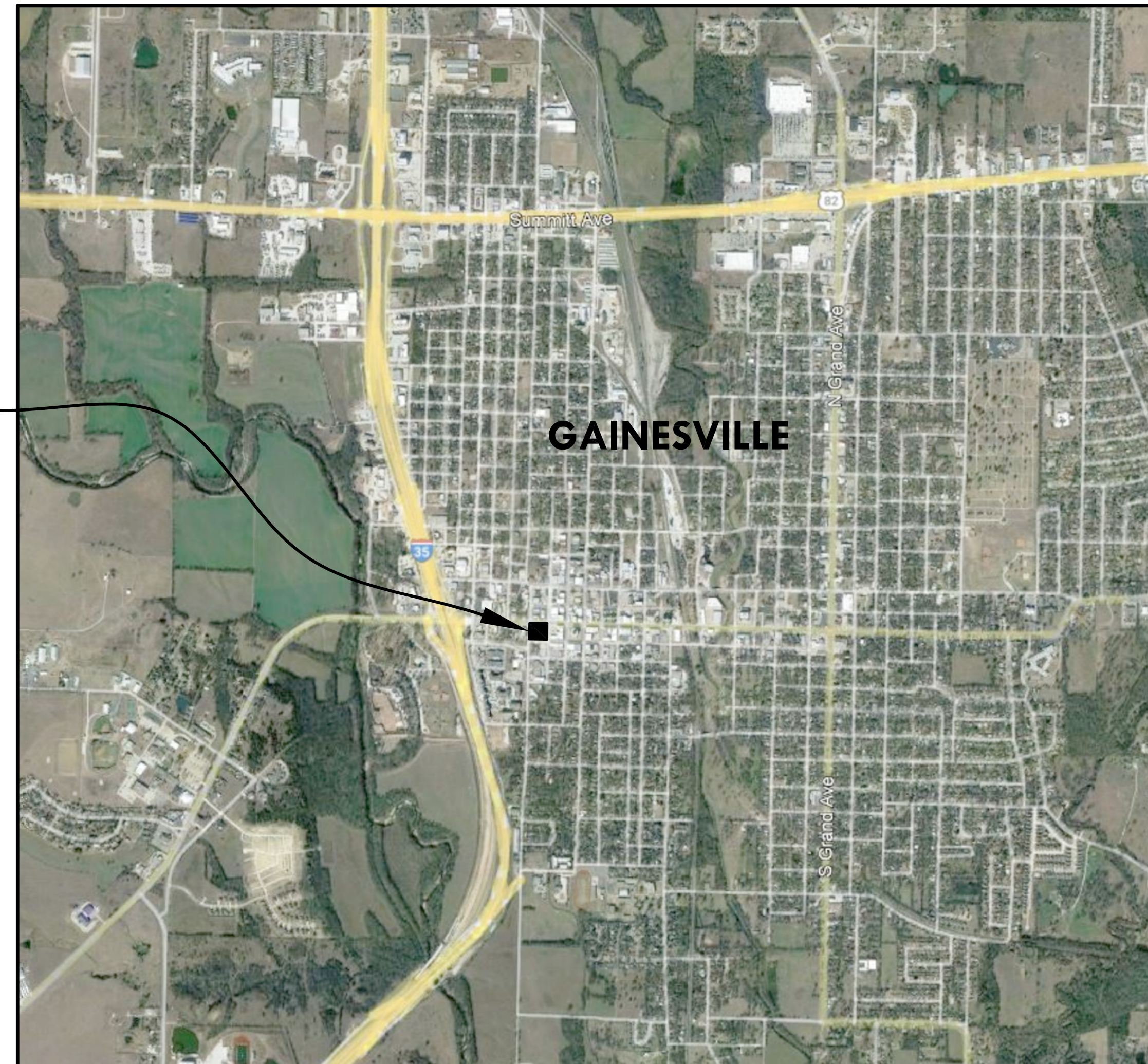

Location Map  
n.f.s.



### Index of Drawings

Sheet Number	Sheet Title
0	Cover
1	Existing Topography Plan
2	Demolition Plan
3	Site & Dimensional Control Plan
4	Grading Plan
5	Drainage Area Map
6	Paving Plan
7	Site Details
8	Paving Details
9	Landscape Plan



# September 2022

Prepared by:



**teague nall & perkins**  
 3200 S. Interstate 35E, Suite 1129  
 Denton, Texas 76210  
 940.383.4177 ph 940.383.8026 fx  
 TBPE Registration No. F-230  
 www.tnpsc.com



TBM #1: X-CUT IN EAST EDGE OF CONCRETE SIDEWALK, WEST SIDE OF S. WEAVER ST. 163' +/- NORTH OF THE EXISTING SANITARY SEWER MANHOLE LOCATED IN THE INTERSECTION OF S. WEAVER ST. AND E. MAIN ST. AKA CP#53  
ELEV=732.26

CP-53 (XST)  
N:7277218.93  
E:2380311.21  
ELEV.=732.26

CP-51 (5/BCIRS)  
N:7277122.75  
E:2380362.04  
ELEV.=732.71

CURB INLET  
RIM ELEV=729.53  
FULL OF DEBRIS  
UNABLE TO OBTAIN  
SIZE/DIRECTION OF PIPES  
BOTTOM OF BOX=726.9

SSMH(BRICK)  
RIM ELEV=728.56  
8"CLAY IN N=724.51  
8"CLAY IN E=724.42  
8"CLAY IN W=724.36  
10"CLAY OUT S=724.36

TBM #2: X-CUT ON THE SEC OF CONCRETE HEAD-IN PARKING LOT FOR THE COOKE COUNTY LIBRARY, SOUTH SIDE OF E. MAIN ST. 126' +/- SE OF THE EXISTING SANITARY SEWER MANHOLE LOCATED IN THE INTERSECTION OF S. WEAVER ST. AND E. MAIN ST. AKA CP#54  
ELEV=730.88

CP-54 (XST)  
N:7277035.69  
E:2380467.32  
ELEV.=730.88

CP-52 (5/BCIRS)  
N:7277110.39  
E:2380565.50  
ELEV.=734.38

SSMH(BRICK)  
RIM ELEV=733.91  
8"CLAY IN E=728.49  
8"CLAY OUT W=728.39

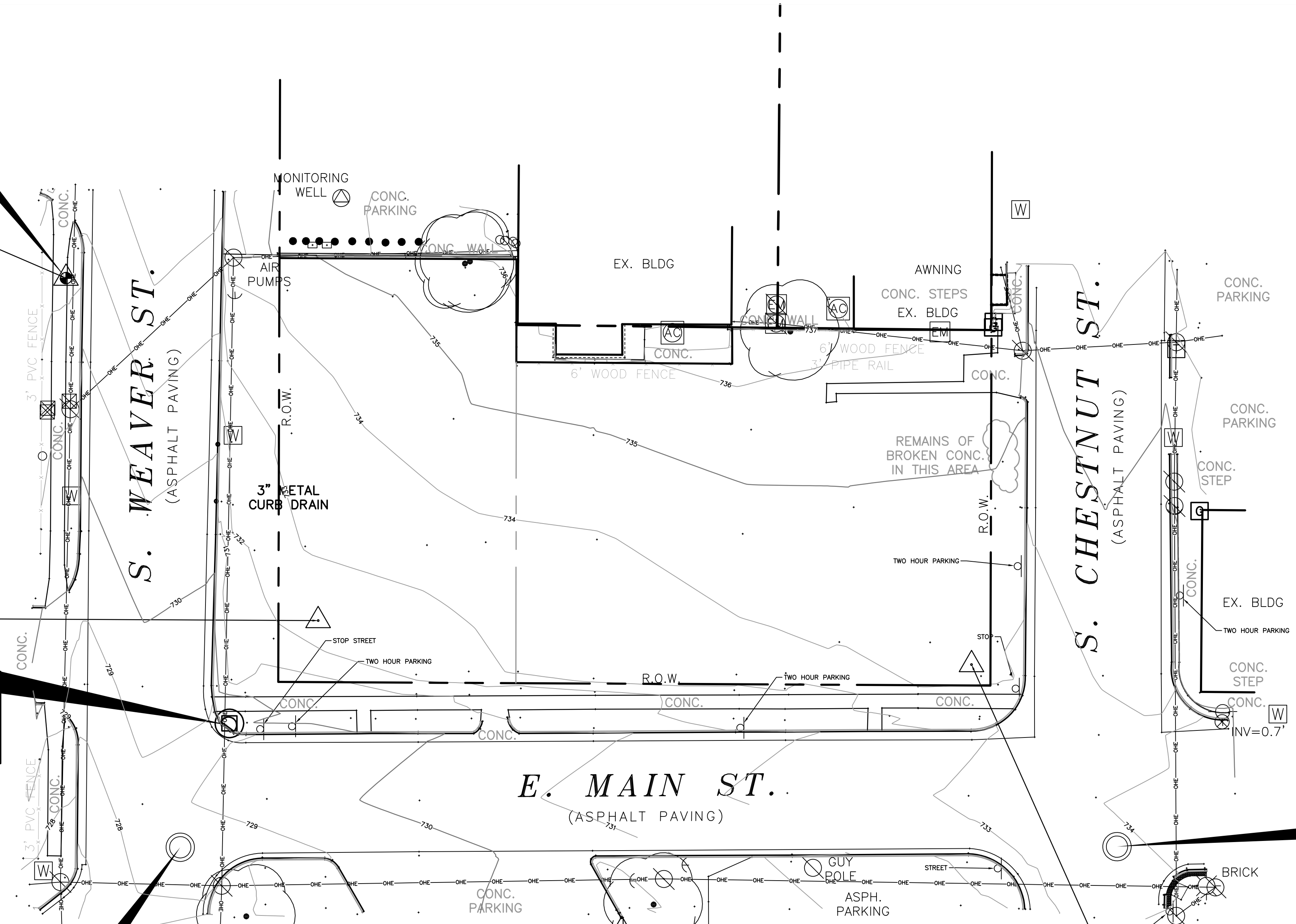
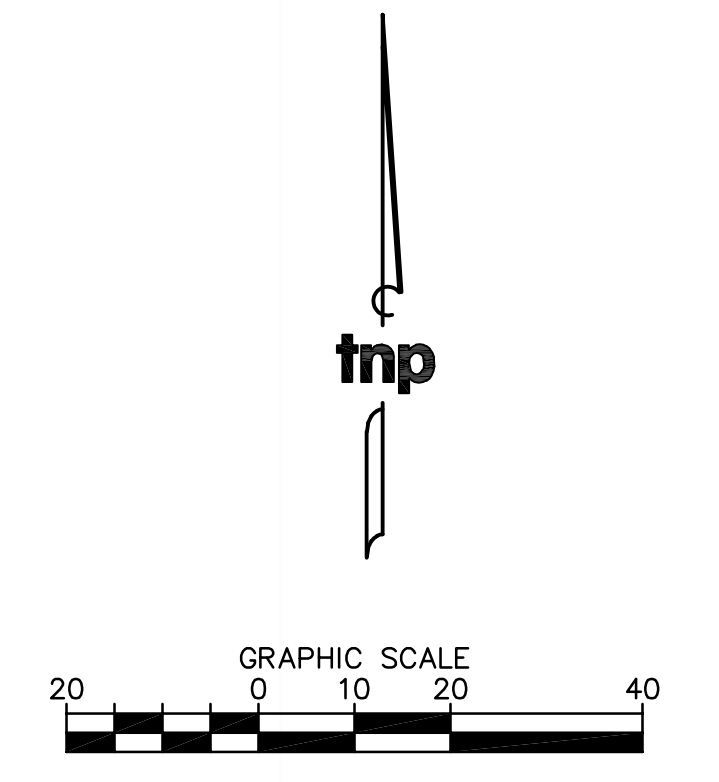

# EXISTING TOPOGRAPHY PLAN

THIS TOPOGRAPHIC SURVEY  
WAS PREPARED BY  
TEAGUE, NALL AND PERKINS  
FEBRUARY 14, 2022

Drawing: T:\Projects\COK\22050\Eng-C30\CAD\construction\plans\EXISTING TOPOGRAPHY PLAN.dwg at Sep 21, 2022-9:01am by aridgnoy

no.	revision	by	date



scale  
horiz  
1" = 20'  
vert  
N/A  
date  
Sep 2022

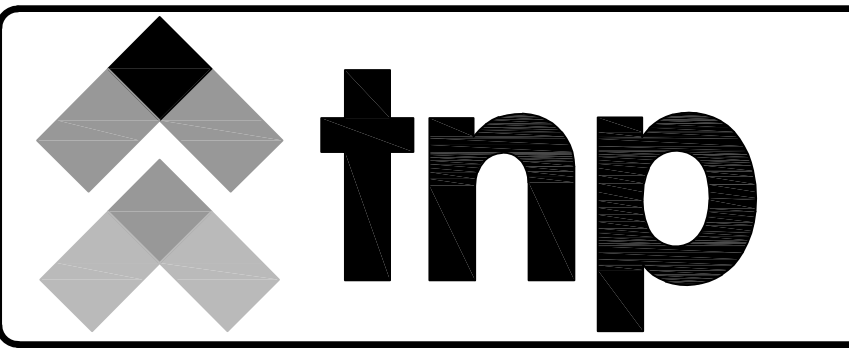

teague nall and perkins, inc  
3200 S. Interstate 35E, Suite 1129  
Denton, Texas 76210  
940.383.4177 ph 940.383.8026 fx  
www.tnppinc.com  
TBPE: F-230; TBPLS: 10011600, 10011601, 10194381  
GBPE No. PEF007431; TBAE No. BR 2673

**THIS SHEET IS  
FOR  
INFORMATION  
ONLY**

Cooke County, Texas  
Cooke County  
**Remote Parking Lot**  
Existing Topography Plan

tnp project  
COK 22050  
sheet  
**1**

TBM #1: X-CUT IN EAST EDGE OF CONCRETE SIDEWALK, WEST SIDE OF S. WEAVER ST. 163' +/- NORTH OF THE EXISTING SANITARY SEWER MANHOLE LOCATED IN THE INTERSECTION OF S. WEAVER ST. AND E. MAIN ST. AKA CP#53  
ELEV=732.26

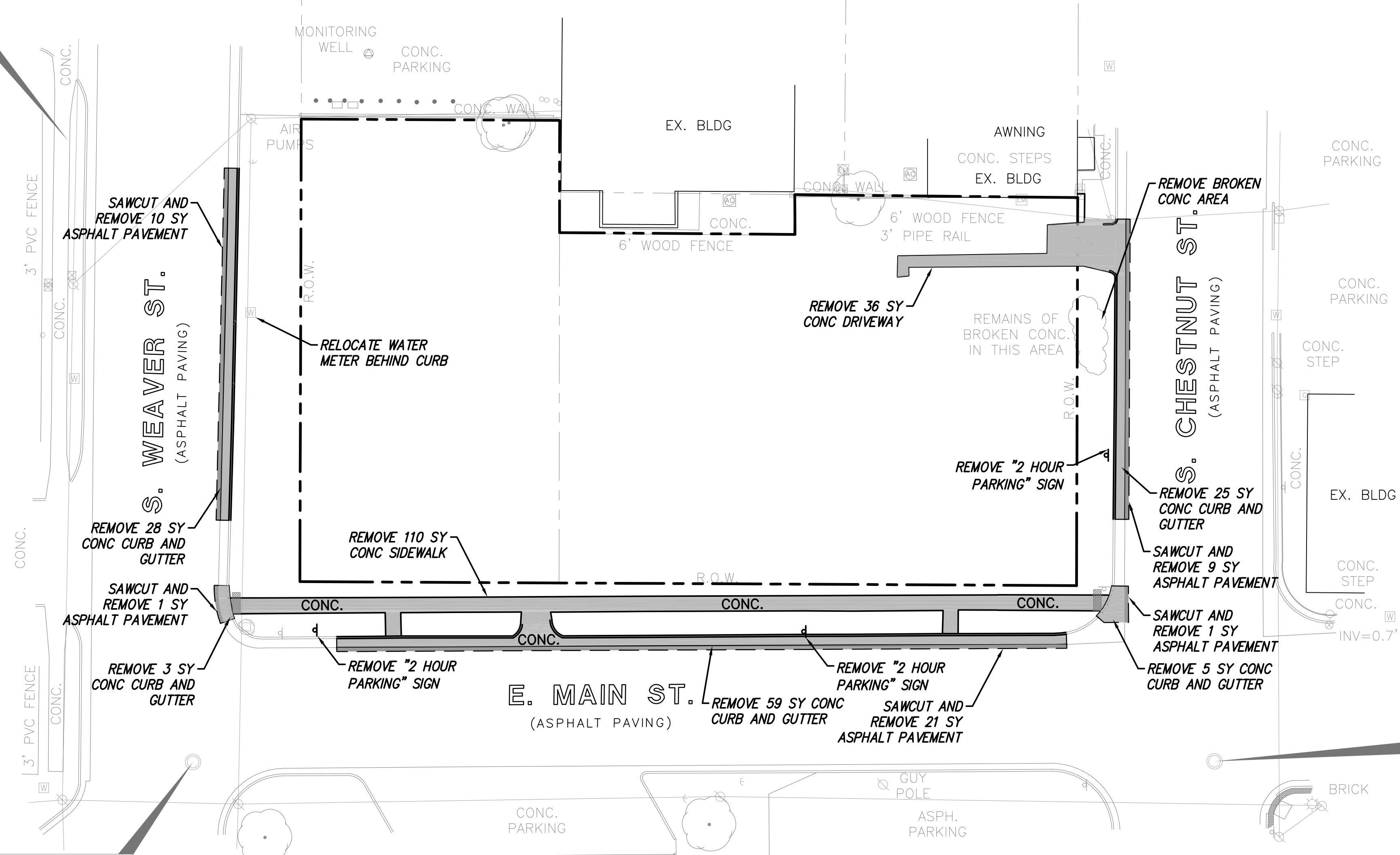
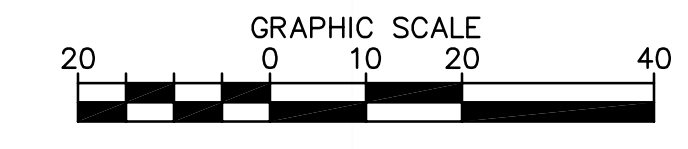
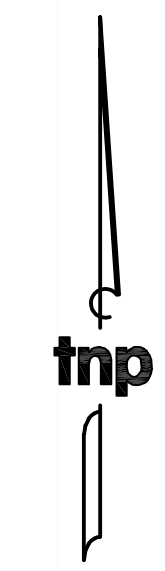

**DEMOLITION NOTES:**

1. CONTRACTOR TO COORDINATE REMOVAL OF MISCELLANEOUS ITEMS WITH OWNER.
2. CONTRACTOR TO HAVE ALL THE EXISTING UTILITIES LOCATED AND COORDINATE WITH THE FRANCHISE UTILITY PROVIDERS PRIOR TO THE START OF DEMOLITION. REFER TO MEP PLANS FOR THE RELOCATION OF LIGHTS AND UTILITY SERVICES.
3. CONTRACTOR SHALL NOTIFY ENGINEER ABOUT EXISTING ITEMS LOCATED AT SITE AND NOT IDENTIFIED IN PLANS.
4. ALL PHASING AND METHOD OF DEMOLITION SHALL BE THE RESPONSIBILITY OF THE CONTRACTOR.

SSMH(BRICK)  
RIM ELEV=728.56  
8"CLAY IN N=724.51  
8"CLAY IN N=724.42  
8"CLAY IN E=724.36  
10"CLAY OUT S=724.36

SSMH(BRICK)  
RIM ELEV=733.91  
8"CLAY IN E=728.49  
8"CLAY OUT W=728.39

TBM #2: X-CUT ON THE SEC OF CONCRETE HEAD-IN PARKING LOT FOR THE COOKE COUNTY LIBRARY, SOUTH SIDE OF E. MAIN ST. 126' +/- SE OF THE EXISTING SANITARY SEWER MANHOLE LOCATED IN THE INTERSECTION OF S. WEAVER ST. AND E. MAIN ST. AKA CP#54  
ELEV=730.88

**DEMOLITION LEGEND**

CONCRETE PAVEMENT REMOVAL

SAWCUT

# DEMOLITION PLAN

Drawing: T:\Projects\COOK\22050\Eng-C30\Construction\_plans\DEMOLITION\_PLAN.dwg at Sep 21, 2022 - 9:02am by aridway  
Layout: Layout1  
User: AEF - 20/08/2022 - 13:30:16:00 - AEF - 20/08/2022

no.	revision	by	date



scale  
horiz  
1" = 20'  
vert  
N/A  
date  
Sep 2022

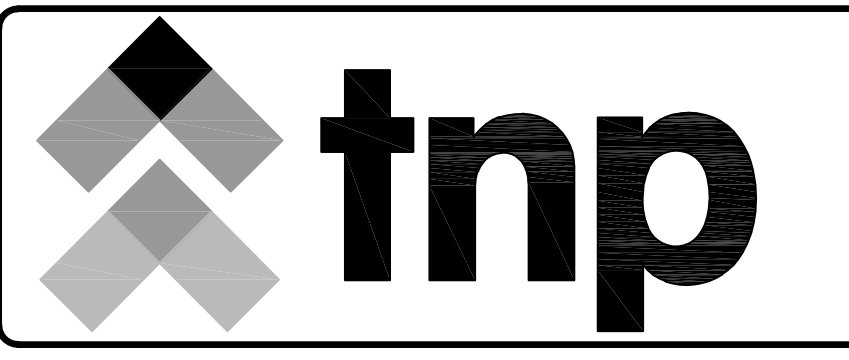

**teague nall and perkins, inc**  
3200 S. Interstate 35E, Suite 1129  
Denton, Texas 76210  
940.383.4177 ph 940.383.8026 fx  
www.tnppinc.com  
TBPE: F-230; TBPLS: 10011600, 10011601, 10194381  
GBPE No. PEF007431; TBAE No. BR 2673



Cooke County, Texas  
Cooke County  
**Remote Parking Lot**  
Demolition Plan

tnp project  
COK 22050  
sheet  
**2**



Drawing: T:\Projects\COKE\22050\Eng-C30\CAD\construction\_plans\SITE PLAN.dwg of Sep 21, 2022 - 9:02am by atd/gwy  
 Layout: Layout1  
 User: atd  
 Plotting: A30-103.dwg - A30-103.dwg

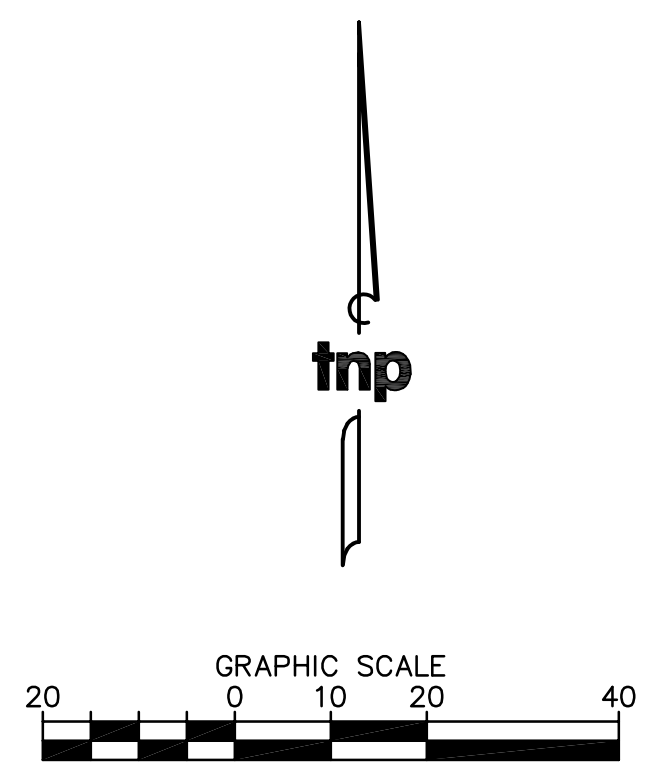
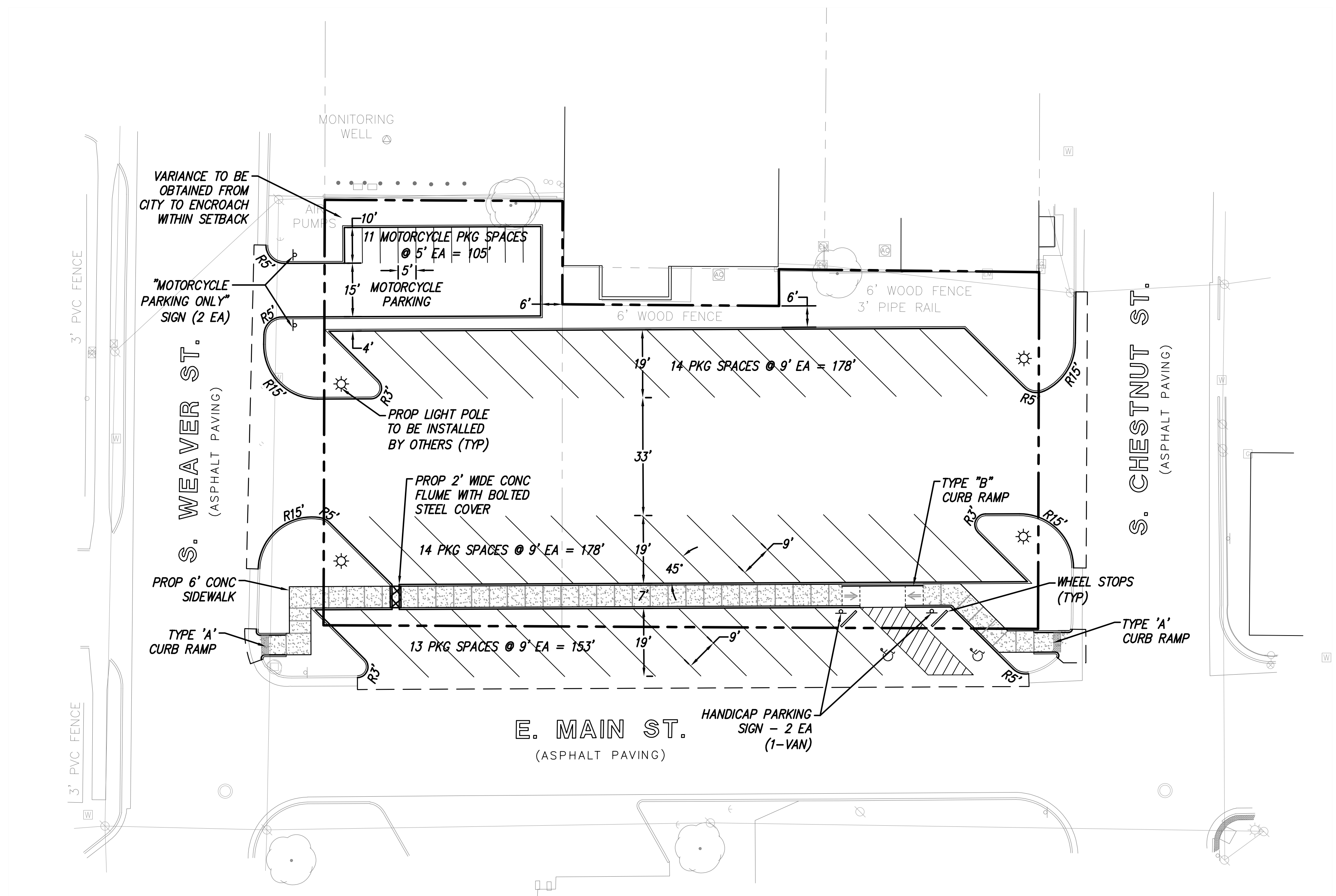

# SITE & DIMENSIONAL CONTROL PLAN

FOR  
**COOKE COUNTY**  
**REMOTE PARKING ADDITION**

**OWNER/APPLICANT:**  
 COOKE COUNTY  
 101 SOUTH DIXON ST.  
 GAINESVILLE, TEXAS 76240  
 940.668.5435  
 CONTACT: JUDGE STEVE STARNES

**PREPARED BY:**  
 TEAGUE NALL & PERKINS, INC.  
 3200 S. INTERSTATE 35E, SUITE 1129  
 DENTON, TEXAS 76210  
 940.383.4177  
 CONTACT: SCOTT GIBSON, PE

**DATE PREPARED:**  
 JUNE 2022

PARKING DATA	
PROPOSED HANDICAP STREET PARKING:	2
PROPOSED STREET PARKING:	11
PROPOSED MOTORCYCLE PARKING:	11
PROPOSED REGULAR PARKING:	28
<b>TOTAL PARKING:</b>	<b>52</b>

no.	revision	by	date



scale
horiz
1" = 20'
vert
N/A
date
Sep 2022

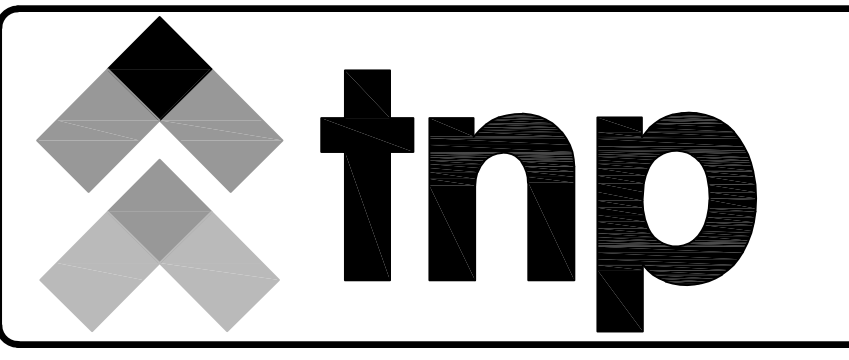

**teague nall and perkins, inc**  
 3200 S. Interstate 35E, Suite 1129  
 Denton, Texas 76210  
 940.383.4177 ph 940.383.8026 fx  
 www.tnppinc.com  
 TBPE: F-230; TBPLS: 10011600, 10011601, 10194381  
 GBPE No. PEF007431; TBAE No. BR 2673



Cooke County, Texas  
 Cooke County  
**Remote Parking Lot**  
 Site & Dimensional Control Plan

tnp project  
 COK 22050  
 sheet  
**3**



tnp

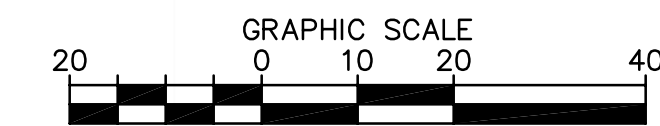

**GRADING NOTES:**

1. THE GRADING OF THE DIFFERENT AREAS SHOWN ON THE SITE SHALL BE COMPACTED IN STRICT ACCORDANCE WITH THE SPECIFICATIONS WHICH SHALL BE CONSIDERED AS PART OF THESE DRAWINGS.
2. THE CONTRACTOR SHALL BE RESPONSIBLE FOR FINE GRADING TO THE SUBGRADE OF ALL PAVED AREAS TO ALLOW FOR THE PAVEMENT SECTIONS. CONTRACTOR SHALL GRADE AND COMPACT ALL AREAS UNDER PAVEMENT TO ALLOW FOR THE RESPECTIVE PAVING SECTIONS AND SHALL MAINTAIN THESE FINISHED GRADES AS SHOWN UNTIL FINAL ACCEPTANCE.
3. CONTRACTOR IS REQUIRED TO INSTALL AND MAINTAIN EROSION CONTROL AT ALL TIMES THROUGHOUT THE PROJECT.
4. THE SPREADING AND COMPACTION OF ANY WASTE OR EXCESS MATERIAL NOT SUITABLE FOR FILLING, SUCH AS LARGE ROCK, CONCRETE, TREES, TRASH AND VEGETATION, SHALL BE DISPOSED OFFSITE AT THE CONTRACTOR'S EXPENSE ONLY IN THOSE AREAS APPROVED FOR DISPOSING OF WASTE MATERIAL. THE CONTRACTOR SHALL NOT DISPOSE OF ANY WASTE MATERIAL ON ADJACENT PROPERTY OWNER'S OR OTHER AREAS WHICH ARE NOT LEGALLY ACCEPTED BY THE CITY. NO BURNING OF ANY MATERIAL AT ANY TIME SHALL BE ALLOWED ON THIS SITE UNLESS PERMITTED BY CITY ORDINANCES.
5. THE CONTRACTOR SHALL BE RESPONSIBLE FOR MAINTAINING ALL SAFETY LAWS IN ACCORDANCE WITH THE CITY, STATE AND FEDERAL LAWS WHICH GOVERN CONSTRUCTION.
6. ALL AREAS TO BE FILLED SHALL BE FILLED IN STRICT ACCORDANCE WITH THE SPECIFICATIONS. ALL VEGETATION, TREES, ROCKS AND OBJECTIONABLE MATERIALS SHALL BE REMOVED BY THE CONTRACTOR FROM THE SURFACE OF WHICH THE FILL IS PLACED. IT SHALL BE THE CONTRACTOR'S RESPONSIBILITY TO PLACE, SPREAD, WATER AND COMPACT THE FILL IN STRICT ACCORDANCE WITH THE SPECIFICATIONS FOR THIS PROJECT.
7. ALL DRIVE, PARKING AREAS, CUT AND FILL SLOPES, BUILDING PADS AND OPEN SPACE AREAS SHALL BE TRIMMED AND COMPACTED TO THE FINISHED GRADE TO PRODUCE SMOOTH SURFACES AND UNIFORM CROSS-SECTIONS. THE SLOPES OF ALL EXCAVATIONS AND EMBANKMENTS SHALL BE LEFT IN A NEAT AND ORDERLY CONDITION. ALL STONES, ROOTS, TREES, AND OTHER WASTE MATERIAL SHALL BE REMOVED AND DISPOSED OFF SITE. ALL VOIDS SHALL BE FILLED AND ANY SOFT SPOTS OCCURRING ON THIS SITE SHALL BE RECOMPACTED PER THE SPECIFICATIONS. VERIFY ALL GRADES TO AVOID PONDING OF WATER.
8. NO ADJUSTMENT OF GRADES WILL BE PERMITTED TO ANY STRUCTURES, PAVEMENT OR WALK SURFACES. SHOULD THE CONTRACTOR DETERMINE THERE IS A DEFICIENCY OF MATERIAL, THEN ALLOWANCE WILL MADE IN THE CONTRACT TO IMPORT A CLEAN MATERIAL SUITABLE FOR FILLING. THE OWNER'S LABORATORY WILL BE ALLOWED TO TEST AND INSPECT THE BORROW SITE PRIOR TO BEGINNING HIS FILLING OPERATIONS. EXCESS EXCAVATED MATERIAL SHALL BE DISPOSED OFFSITE AS REQUIRED.
9. THERE ARE TREES AND BRUSH WITHIN THE LIMITS OF THIS SITE. THE CONTRACTOR SHALL VISIT THE SITE TO DETERMINE THE EXACT SCOPE OF WORK. THE CONTRACTOR SHALL REMOVE ALL BRUSH, TREES AND VEGETATION FROM THE LIMITS OF THE PROPOSED IMPROVEMENTS. ALL TREES OUTSIDE THE LIMITS OF CONSTRUCTION SHALL REMAIN UNLESS NOTED ON THE PLANS TO BE REMOVED OR APPROVED BY THE OWNER. EXISTING TREES TO REMAIN SHALL BE PROTECTED DURING CONSTRUCTION.
10. REFERENCE LANDSCAPE PLANS FOR LIMITS OF LANDSCAPING AND SEEDING/SODDING. IN THE EVENT AN AREA IS DISTURBED DUE TO CONSTRUCTION OR GRADING AND IS NOT CALLED OUT FOR TREATMENT UNDER THE LANDSCAPE PLAN, THEN THE MINIMUM REQUIRED TREATMENT SHALL BE HYDRO MULCH SEEDING. IN SOME INSTANCES THE PLANS WILL REQUIRE BLOCK SODDING TO STABILIZE SLOPES.
11. ALL WALKS SHALL NOT EXCEED THE MAXIMUM SLOPES ALLOWED BY THE TEXAS ACCESSIBILITY STANDARDS (TAS), UNLESS INDICATED. THE MAXIMUM CROSS SLOPE IS 2% AND THE MAXIMUM DIRECTIONAL SLOPE IS 5%.
12. ALL SPOT GRADES ARE FOR PROPOSED EDGE OF PAVEMENT OR GUTTER ELEVATIONS, UNLESS INDICATED OTHERWISE.
13. ANY DEPRESSED AREA, WHICH HOLDS SURFACE WATER, SHALL BE PUMPED DRY. EXISTING SOGGY MATERIALS SHALL BE EXCAVATED AND REMOVED UNTIL A STABLE DRY MATERIAL IS AVAILABLE. THIS EXPOSED MATERIAL SHALL BE COMPACTED TO 95% STD PROCTOR. ON SITE MATERIAL SHALL BE PLACED IN 8" MAX LIFTS AND COMPACTED TO MAX 95% STD PROCTOR AT OPTIMUM MOISTURE CONTENT.

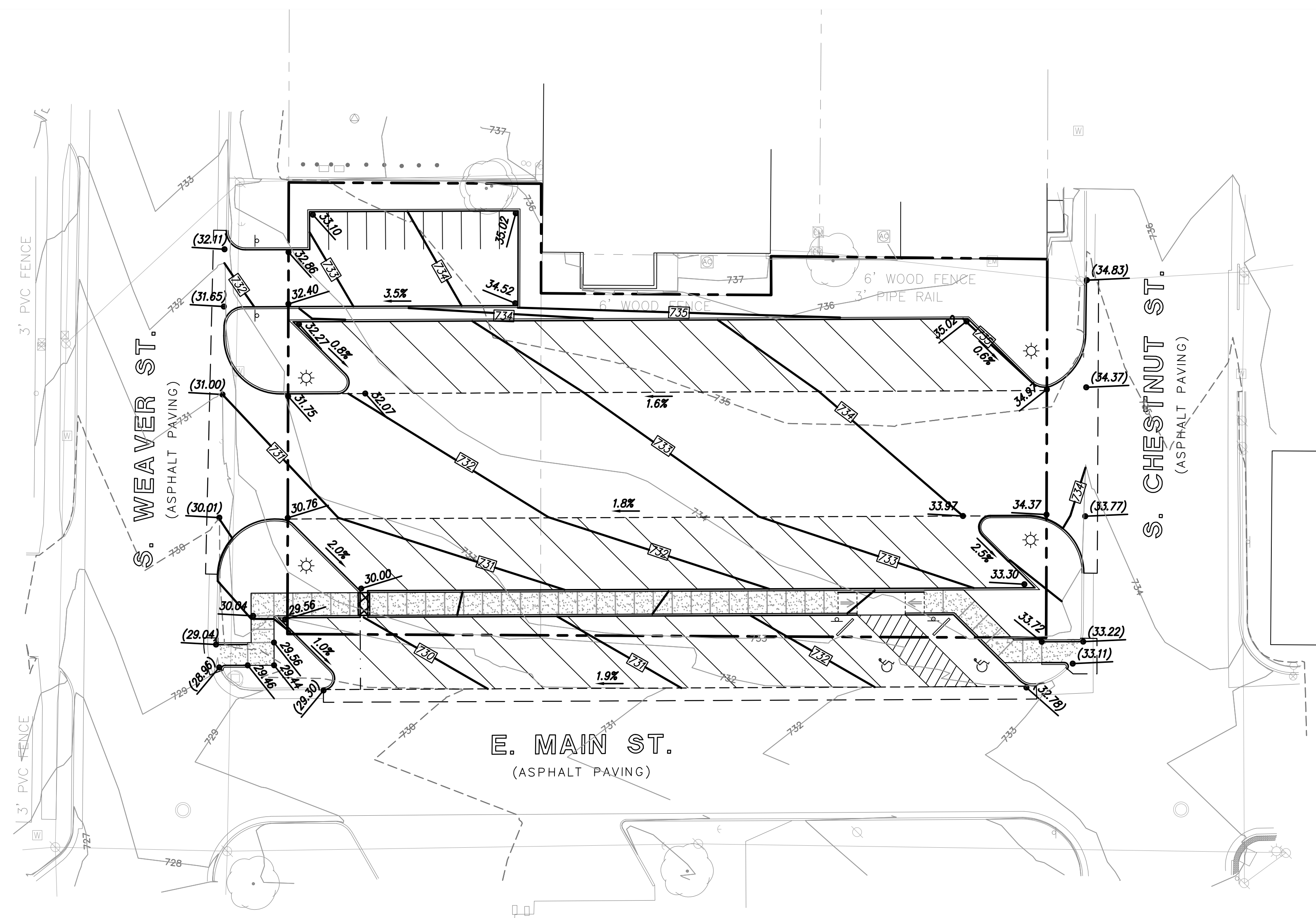

**GRADING LEGEND**

- (79.20) EXISTING SPOT ELEVATION
- 79.20 PROPOSED SPOT ELEVATION
- 5% PROPOSED PERCENT OF GRADE
- 63.55 PROPOSED CONTOUR
- GRADE BREAK/RIDGE LINE
- - - - PROPOSED SWALE LINE
- - - - PROPOSED DAYLIGHT LINE
- 5:1 PROPOSED SLOPE RATIO
- x 79.20 EXISTING SPOT GRADE
- 63.3 EXISTING CONTOURS

**GRADING PLAN**

Drawing: T:\Projects\COO\220201\Eng-C30\CONSTRUCTION\plans\GRADING\_Plan.dwg, Sep 21, 2022 - 9:02am by eridway  
 Layout: Layout1  
 Views: AEF=AutoCAD.dwg - X30=Title.dwg - AEF=Title.dwg - X30=Grading.dwg

no.	revision	by	date



scale  
 horiz 1" = 20'  
 vert N/A  
 date  
 Sep 2022



**teague nall and perkins, inc**  
 3200 S. Interstate 35E, Suite 1129  
 Denton, Texas 76210  
 940.383.4177 ph 940.383.8026 fx  
 www.tnppinc.com  
 TBPE: F-230; TBPLS: 10011600, 10011601, 10194381  
 GBPE No. PEF007431; TBAE No. BR 2673

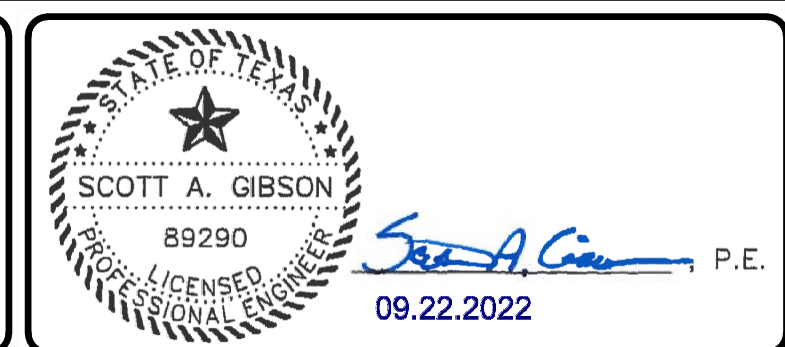

Cooke County, Texas  
 Cooke County  
**Remote Parking Lot**  
 Grading Plan

tnp project  
 COK 22050  
 sheet  
**4**



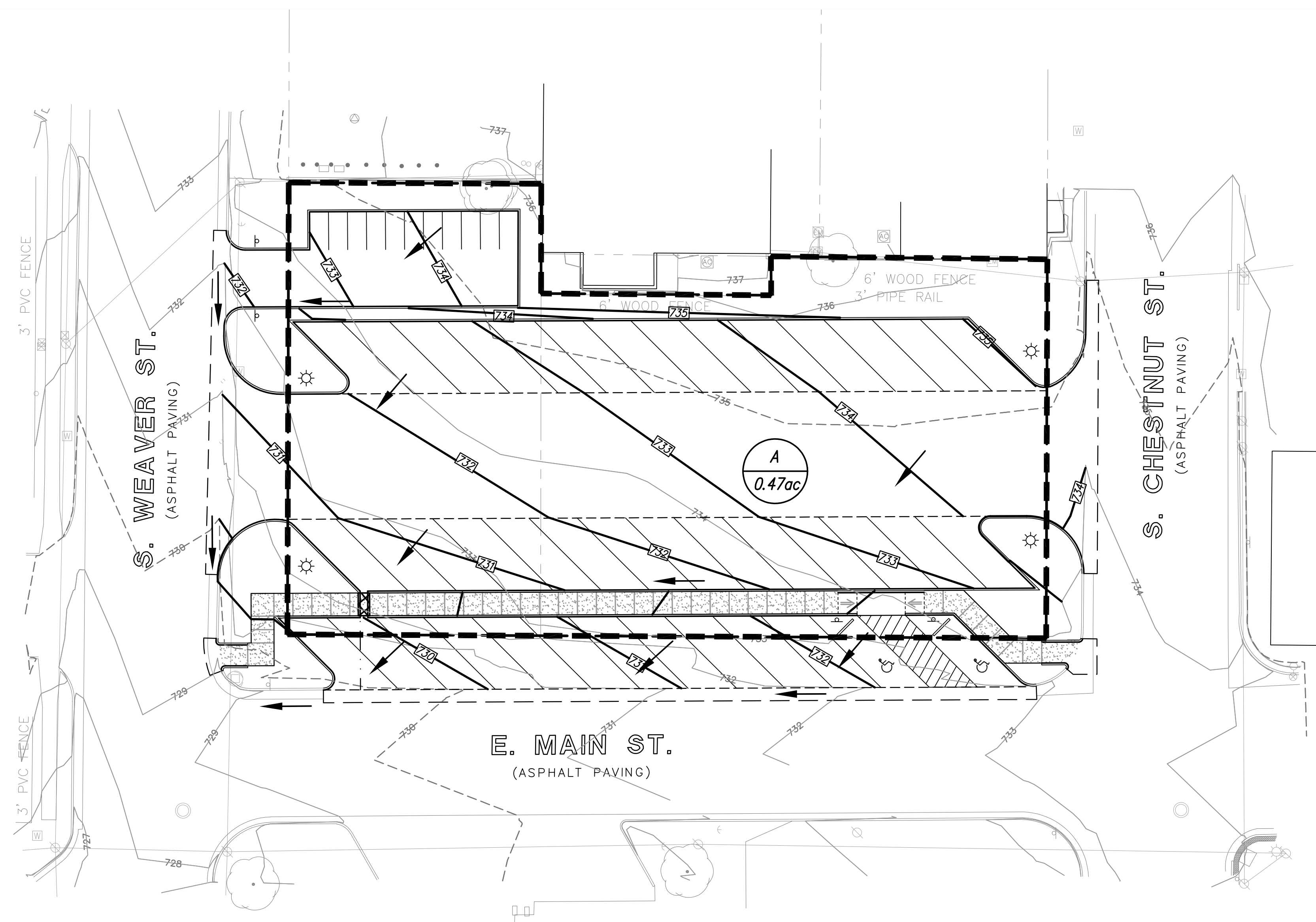

tnp

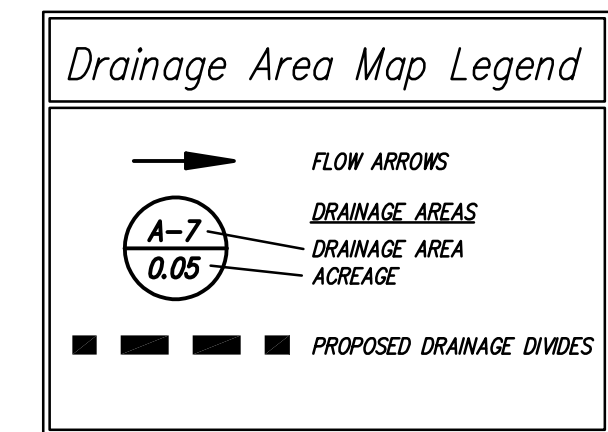
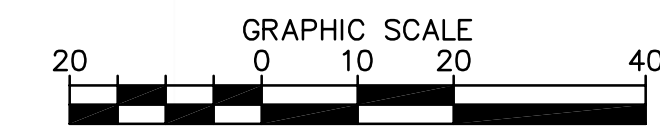

DRAINAGE AREA CALCULATIONS														
AREA	ACRES	C'	Tc	I <sub>1</sub>	I <sub>5</sub>	I <sub>10</sub>	I <sub>25</sub>	I <sub>100</sub>	Q <sub>1</sub>	Q <sub>5</sub>	Q <sub>10</sub>	Q <sub>25</sub>	Q <sub>100</sub>	
A-EX	0.47	0.450	10	4.11	5.82	6.54	7.58	9.27	0.88	1.24	1.40	1.62	1.98	
A-PROP	0.47	0.853	10	4.11	5.82	6.54	7.58	9.27	1.66	2.36	2.65	3.07	3.75	

# DRAINAGE AREA MAP

Drawing: T:\Projects\COK\22050\Eng-C30\CAD\construction\_plans\04M\_Plan.dwg of Sep 21, 2022 - 3:48pm by ardayaw  
 Layout: Layout1  
 User: AEF - ardayaw  
 Plot: AEF - ardayaw

no.	revision	by	date



scale  
 horiz  
 1" = 20'  
 vert  
 N/A  
 date  
 Sep 2022

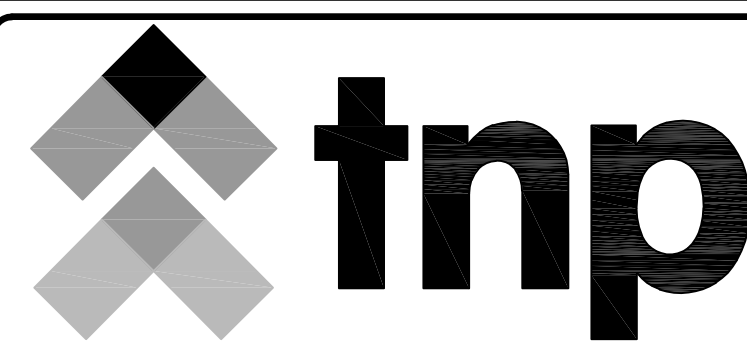

**teague nall and perkins, inc**  
 3200 S. Interstate 35E, Suite 1129  
 Denton, Texas 76210  
 940.383.4177 ph 940.383.8026 fx  
 www.tnppinc.com  
 TBPE: F-230; TBPLS: 10011600, 10011601, 10194381  
 GBPE No. PEF007431; TBAE No. BR 2673

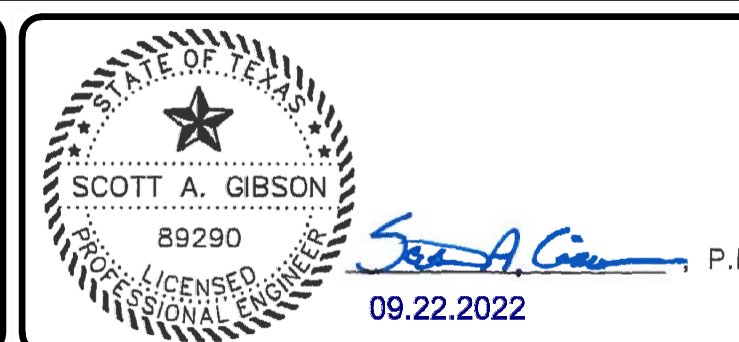

Cooke County, Texas  
 Cooke County  
**Remote Parking Lot**  
 Drainage Area Map

tnp project  
 COK 22050  
 sheet  
**5**



Drawing: T:\Projects\2022\202209\Eng-C30\CAD\construction\plans\PAVING\_PLA.dwg of Sep 21, 2022 - 9:02am by aridway  
 Layout: Layout1  
 Views: AEF - submittal.dwg - A30 - inside.dwg - AEF - submittal.dwg - AEF - submittal.dwg - A30 - inside.dwg - A30 - inside.dwg

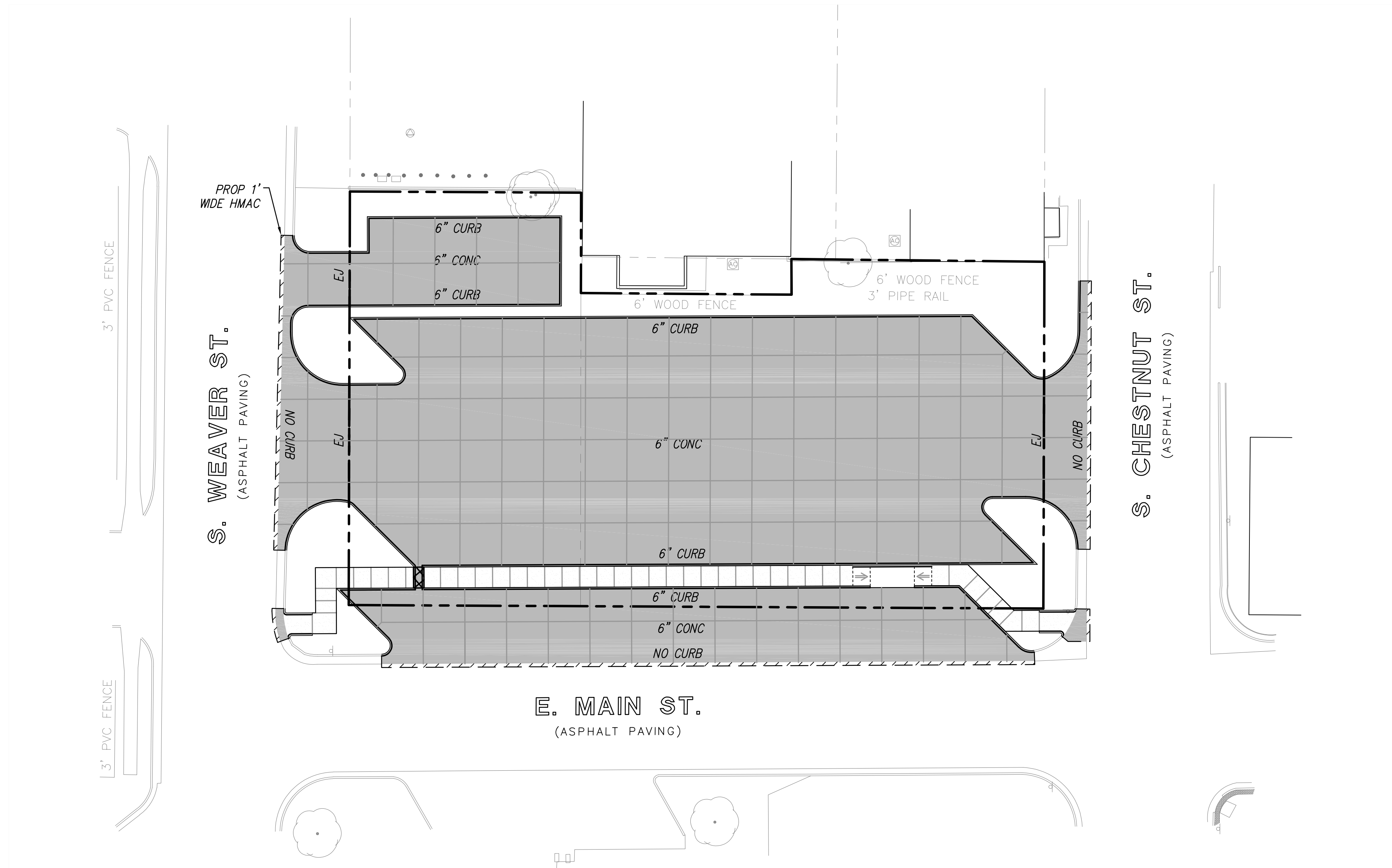

**PAVING NOTES**

1. ALL CONCRETE PAVING SHALL HAVE A MINIMUM COMPRESSIVE STRENGTH OF 4,000 PSI AT 28 DAYS. MISC. CONCRETE FLATWORK SHALL HAVE A MINIMUM COMPRESSIVE STRENGTH OF 3,000 PSI AT 28 DAYS.
2. SUBGRADE PREPARATION SHALL EXTEND A MINIMUM OF 2 FT. BEYOND THE BACK OF CURB AND/OR THE EDGE OF PAVEMENT. REFER TO PAVEMENT GENERAL NOTE ON PAVING DETAILS SHEET FOR SUBGRADE PREPARATION REQUIREMENTS.
3. ALL CONCRETE SAWCUT JOINTS SHALL BE SPACED AT 12' MAXIMUM CENTERS EACH WAY. SAWCUTTING SHALL BE ACCOMPLISHED WITHIN 4 TO 12 HOURS OF PLACING CONCRETE PAVEMENT. CONTRACTOR SHALL MAKE NECESSARY PROVISIONS FOR LIGHTING, EQUIPMENT AND LABOR TO MEET THE SAWCUT SPECIFICATIONS. NO TOLERANCE IS PERMITTED IN THE SAWCUTTING TIME.
4. CONTRACTOR SHALL TAKE NOTE OF DIFFERENT TYPES OF EDGE OF PAVEMENTS TO BE USED ON THIS PROJECT.
5. ALL MAIN DRIVES SHALL BE CONSTRUCTED USING A PAVING MACHINE OR VIBRATORY SCREEN. THE PARKING LOTS SHALL BE POURED IN STRIPS USING A VIBRATORY SCREEN. CURBS SHALL BE POURED WITH A MECHANICAL MULE MOUNTED ON THE PAVING MACHINE OR WITH A HAND HELD MULE FOR RADIUS RETURNS AND ISLANDS.
6. ALL TRAFFIC CONTROL DEVICES AND PROCEDURES SHALL CONFORM TO THE LATEST VERSION OF THE TEXAS MANUAL ON UNIFORM TRAFFIC CONTROL DEVICES (TMUTCD).
7. CONTRACTOR IS RESPONSIBLE FOR REMOVING DIRT, MUD, AND SPOILS TRACKED ONTO PUBLIC ROADS RESULTING FROM CONSTRUCTION ACTIVITIES.
8. CONTRACTOR SHALL VERIFY SLEEVE SIZE AND LOCATIONS WITH IRRIGATION PLANS AND MEP PLANS
9. CONTRACTOR SHALL STAMP CURBS INDICATING SIZE, LOCATION, AND TYPE OF SLEEVE.

**PAVING PLAN**

**NOTE:**  
 CONTRACTOR IS RESPONSIBLE FOR REMOVING DIRT, MUD AND SPOILS TRACKED ONTO PUBLIC ROADS RESULTING FROM CONSTRUCTION ACTIVITIES. SEE EROSION CONTROL PLANS FOR REQUIREMENTS TO INSTALL A WHEEL-WASH STATION AT THE CONSTRUCTION EXIT.

LEGEND	
	6" CONCRETE PAVEMENT
	5" CONCRETE PAVEMENT
	4" CONCRETE SIDEWALK
	6" ASPHALT PAVEMENT
	SAWED DUMMY JOINT

no.	revision	by	date



scale
horiz
1" = 20'
vert
N/A
date
Sep 2022



**teague nall and perkins, inc**  
 3200 S. Interstate 35E, Suite 1129  
 Denton, Texas 76210  
 940.383.4177 ph 940.383.8026 fx  
 www.tnpsc.com  
 TBPE: F-230; TBPLS: 10011600, 10011601, 10194381  
 GBPE No. PEF007431; TBAE No. BR 2673

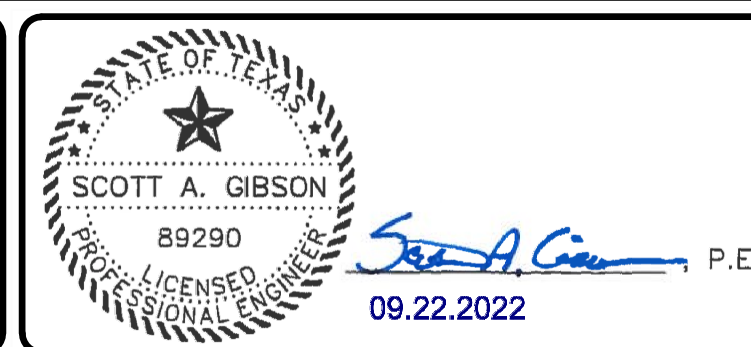

Cooke County, Texas  
 Cooke County  
**Remote Parking Lot**  
 Paving Plan

tnp project  
 COK 22050  
 sheet  
**6**







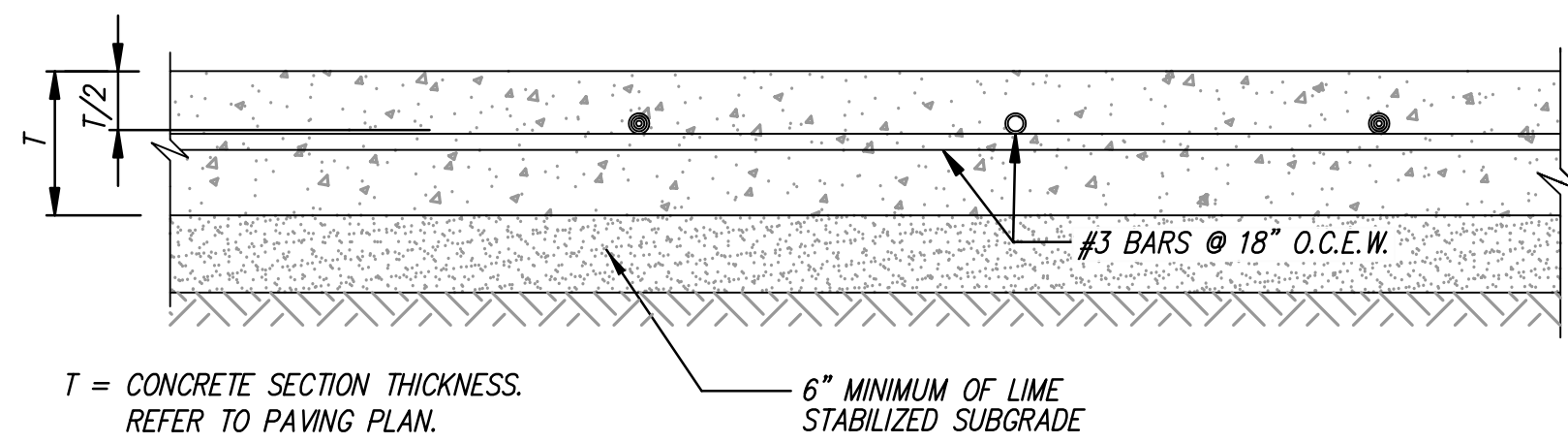

**TYPICAL CONCRETE SECTION**

N.T.S.

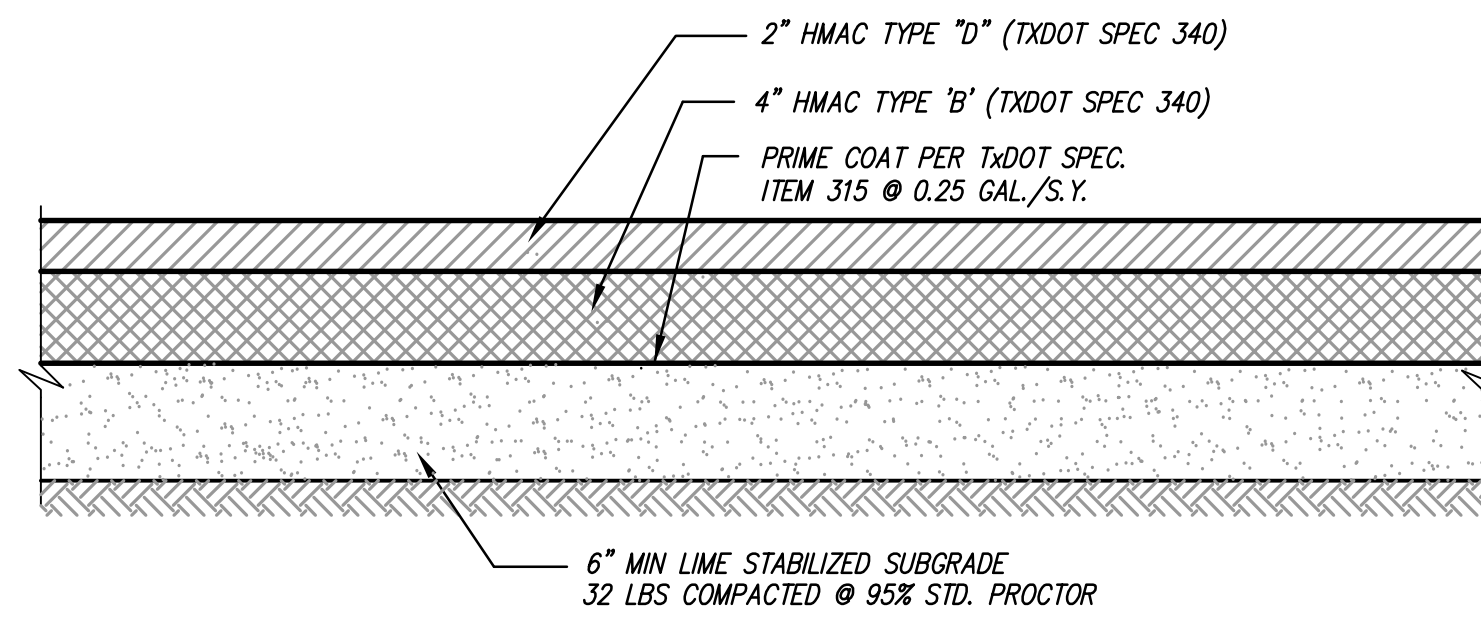

**6" HMAC PAVING SECTION**

N.T.S.

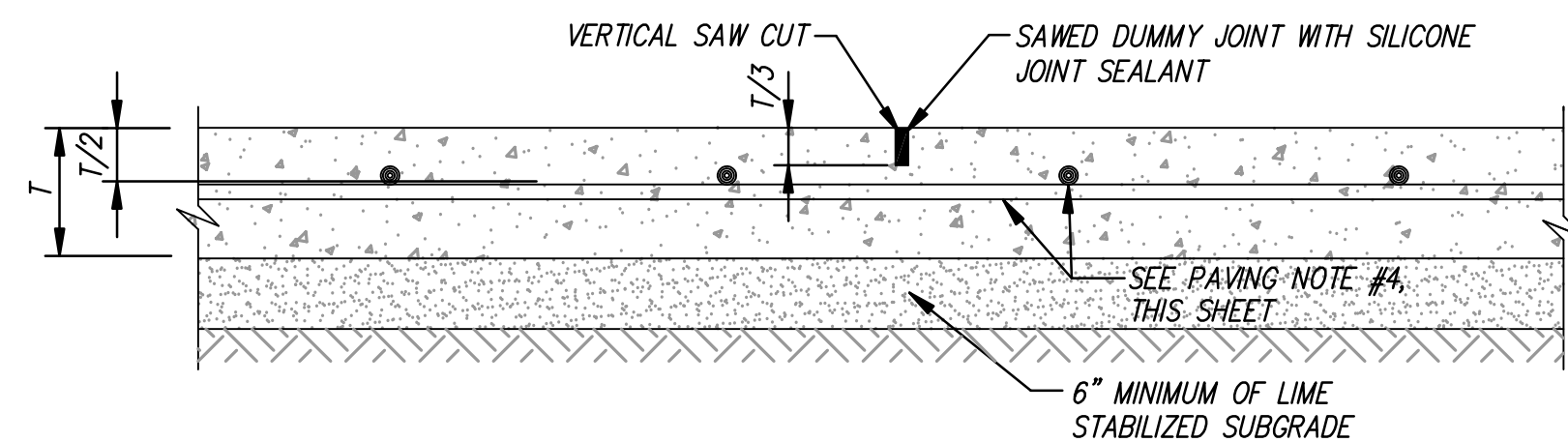

**SAWED DUMMY JOINT**

N.T.S.

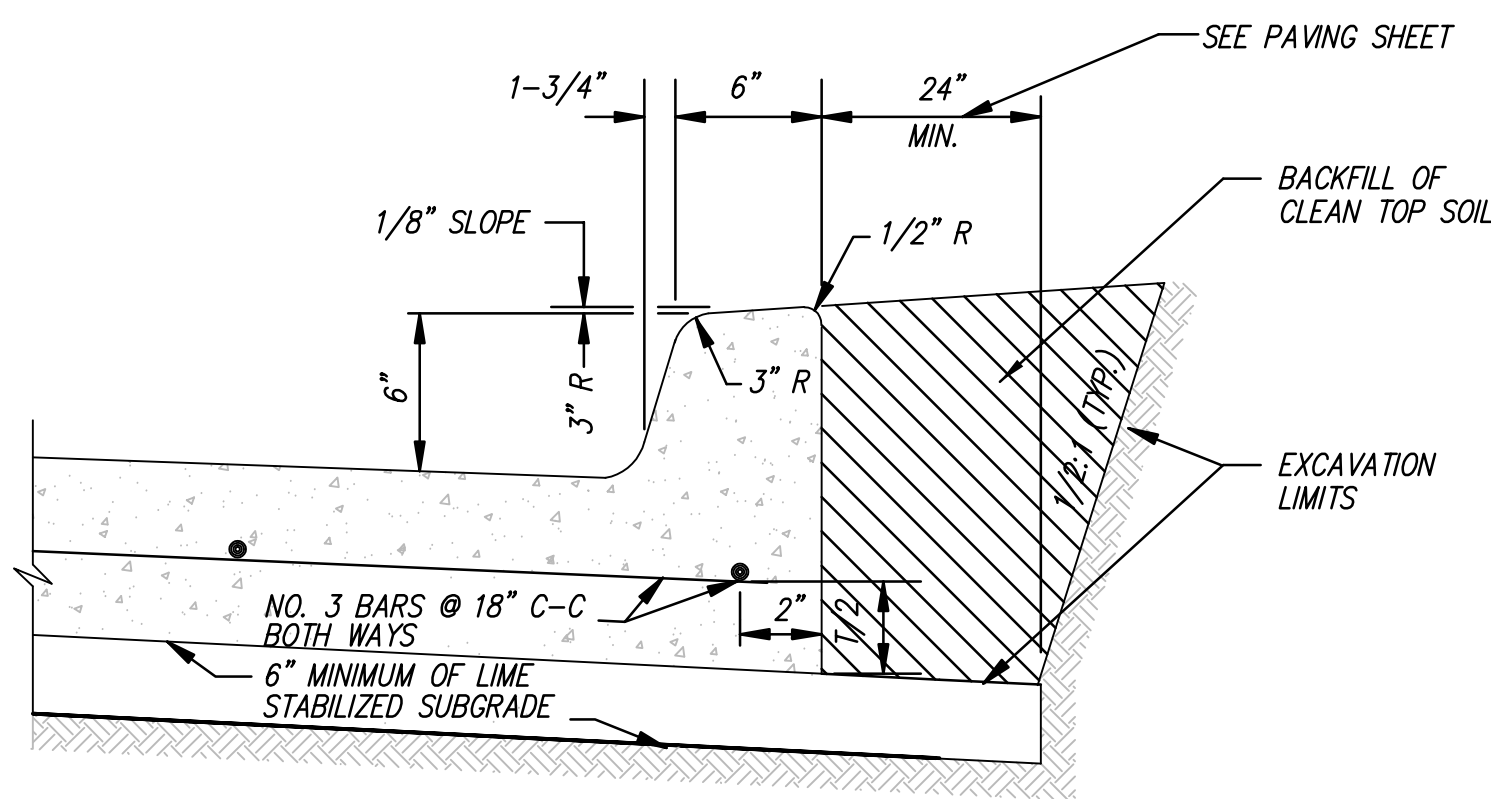

**MONOLITHIC CURB**

N.T.S.

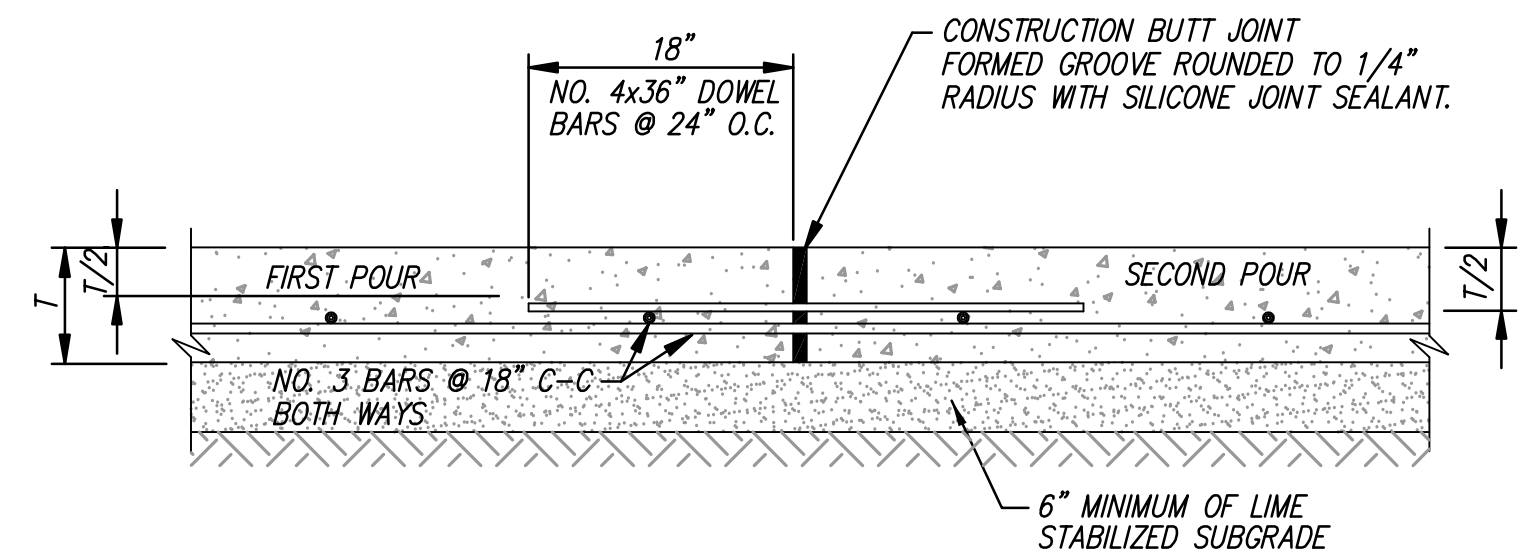

**CONSTRUCTION BUTT JOINT**

N.T.S.

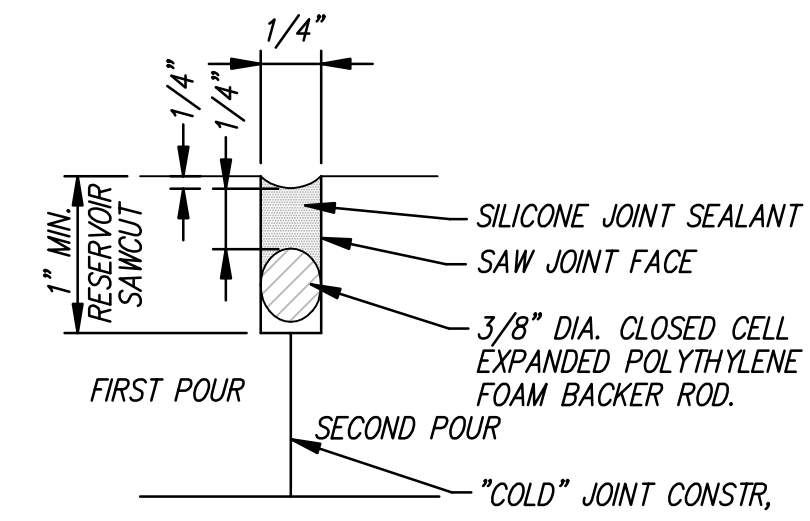

**CONSTRUCTION BUTT JOINT SEAL**

N.T.S.

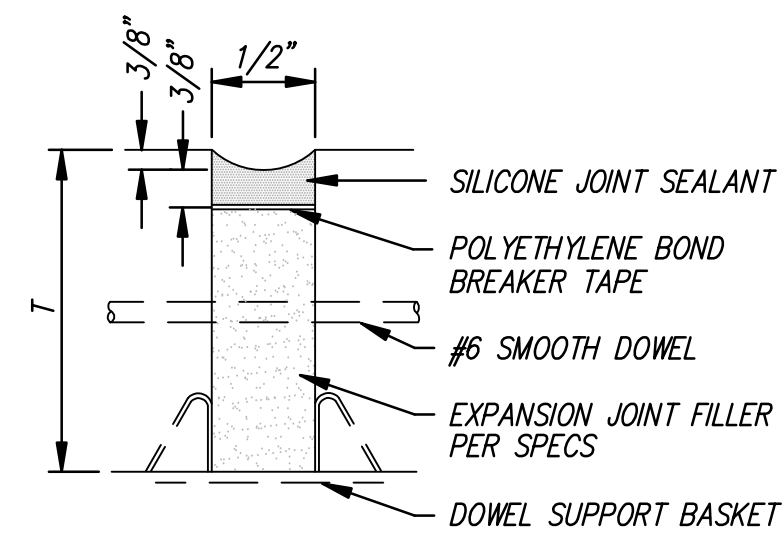

**EXPANSION JOINT SEAL**

N.T.S.

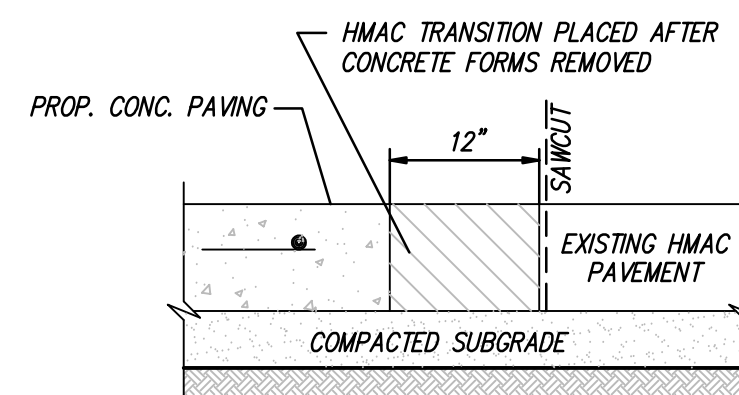

**CONCRETE/HMAC TRANSITION**

N.T.S.

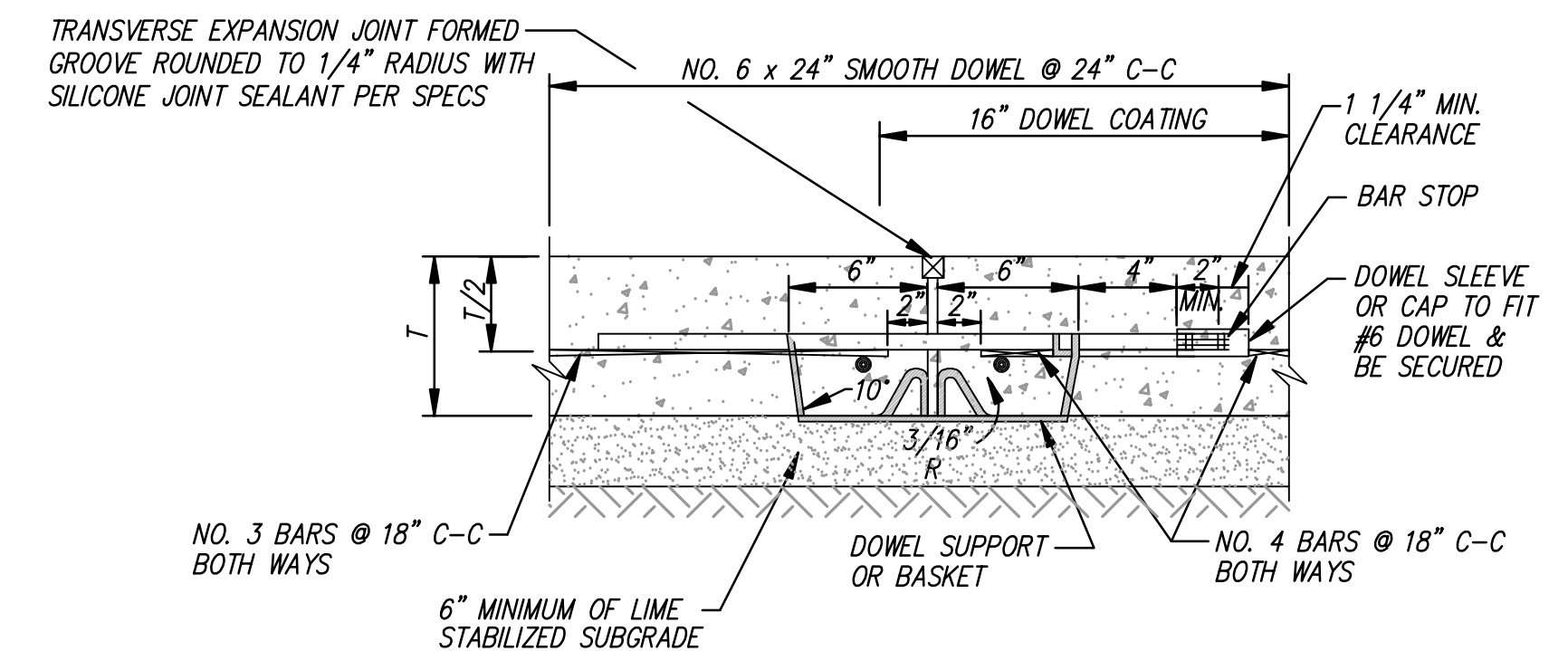

**TRANSVERSE EXPANSION JOINT**

N.T.S.

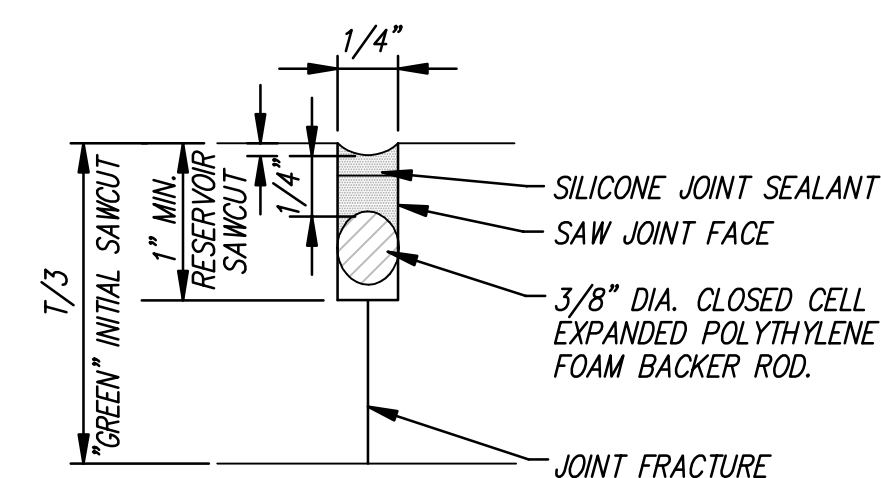

NOTE:  
1. POLYETHYLENE FOAM BACKER ROD DOES NOT SIT ON BOTTOM OF SAW  
2. SILICONE BEAD HAS GENERAL WIDTH TO DEPTH RATIO OF 2:1.

**SAWED DUMMY JOINT SEAL**

N.T.S.

- PAVEMENT GENERAL NOTES:
- PAVEMENT DESIGNS ARE BASED ON THE RECOMMENDATIONS OF THE SUPPLEMENTAL GEOTECHNICAL REPORT, D&S ENGINEERING LABS PROJECT No. G21-2357 PREPARED BY D&S ENGINEERING LABS AND DATED MARCH 21, 2022.
  - ALL CONCRETE PAVING SHALL HAVE A MINIMUM COMPRESSIVE STRENGTH OF 4,000 PSI AT 28 DAYS. MISC. CONCRETE FLATWORK SHALL HAVE A MINIMUM COMPRESSIVE STRENGTH OF 3,000 PSI AT 28 DAYS.
  - CONCRETE PAVING SHALL BE PLACED ON A LIME MODIFIED SUBGRADE PER TXDOT ITEM 260, AT AN APPLICATION RATE OF 6% (27 lbs./SY) BY DRY WEIGHT OF SOILS TO A COMPACTED DEPTH OF 6 INCHES. COMPACTION TO BE TO 95% AT A MOISTURE CONTENT RANGING FROM 0 TO +4 PERCENT OF OPTIMUM.
  - REINFORCING STEEL FOR 4" FLATWORK CONCRETE SHALL BE A MINIMUM OF #3 @18" O.C.E.W. REINFORCING STEEL FOR 6" CONCRETE PAVEMENT SHALL BE A MINIMUM OF #3 @18" O.C.E.W.

Drawing: T:\Projects\COK22050\Eng-C30\CAD\Construction\plans\PAVING\PLAN.dwg of Sep 21, 2022-9:03am by aridway  
Layout: layout1.dwg of 9/21/22 10:56:00 AM by aridway

no.	revision	by	date



scale	
horiz	N/A
vert	N/A
date	Sep 2022



**teague nall and perkins, inc**  
3200 S. Interstate 35E, Suite 1129  
Denton, Texas 76210  
940.383.4177 ph 940.383.8026 fx  
www.tnppinc.com  
TBPE: F-230; TBPLS: 10011600, 10011601, 10194381  
GBPE No. PEF007431; TBAE No. BR 2673

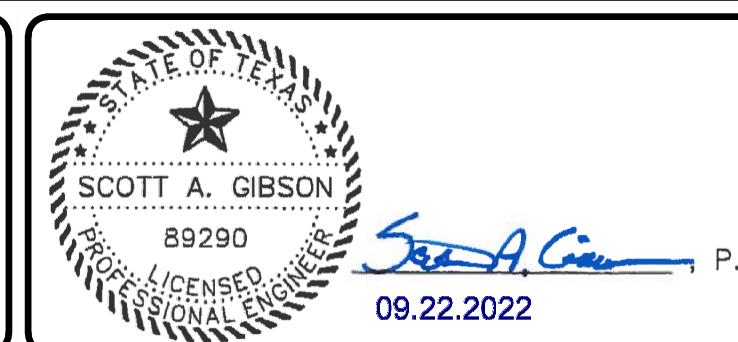

**Cooke County, Texas**  
Cooke County  
**Remote Parking Lot**  
Paving Details

tnp project  
**COK 22050**  
sheet  
**8**



